

APCL 091
Electric steam valve 1/2"
for controlling the steam supply.

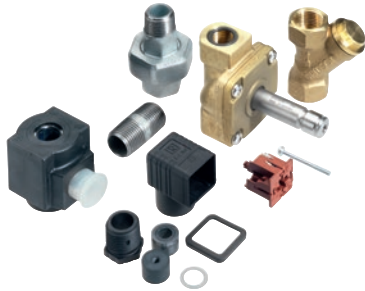

- For pressure between 0.2-10 bar (direct and indirect)

EAN: 4002516502166 / Material number: 11935010 / Old Material Number: 59590091D

Product classification	
Washing machines	•
Tumble dryers	•
Machine/accessory category	
PT 8403	•
PT 8407	•
PT 8503	•
PT 8507	•
PT 8803	•
PT 8807	•
PW 6107	•
PW 6137	•
PW 6163	•
PW 6167	•
PW 6207	•
PW 6241	•
PW 6243	•
PW 6321	•
PW 6323	•
PW 811	•
PW 814	•
PW 818	•
PWM 912	•
PWM 916	•
PWM 920	•
PDR 518	•
PDR 918	•
PDR 522	•
PDR 922	•
PDR 528	•
PDR 928	•
PDR 544	•
PDR 944	•
Product category	
Valve	•
Product properties	
Electrical connection	OHNE
Dimensions and weight	
External dimensions, net height in mm	150
External dimensions, net width in mm	120
External dimensions, net depth in mm	90
External dimensions, gross height in mm	230
External dimensions, gross width in mm	430
External dimensions, gross depth in mm	40
Net weight [kg]	1.00
Gross weight in kg	1.00