

CSDA 7001 FL
SmartLine element
as downdraft extractor for extraction or recirculation operation



- Intuitive quick selection via number sequences – Smart Select
- Elegant design – for flush or raised installation
- Seamlessly integrates with any SmartLine element
- Efficient filtration- 10-ply stainless-steel grease filter
- Energy-efficient and quiet – powerful ECO motor



EAN: 4002516304906 / Material number: 11402230 / Old Material Number: 27700150GB

| Construction type | |
|--|--------------------|
| Downdraft extractor | • |
| Operating modes | |
| Type of air guide | Can be retrofitted |
| Flat ducting components (order separately) | DFK- xxxx |
| Recirculation conversion kit (order separately) | DUU 1000-2 |
| Design | |
| Flush | • |
| Frameless – surface-mounted | • |
| User convenience | |
| Operation via sensor controls | Smart Select |
| Digital power level display | • |
| Display colour | Yellow |
| Run-on time 5 min. | • |
| Easy-to-clean canopy interior – CleanCover | • |
| Efficiency and sustainability | |
| Energy efficiency class (A+++ – D) | A++ |
| ECO motor | • |
| Annual energy consumption in kWh/year | 25.3 |
| Fluid dynamic efficiency class | A |
| Lighting efficiency class | NA |
| Grease filtering efficiency class | B |
| Cleaning and care | |
| Easy to clean ceramic glass | • |
| Filter system | |
| Number of dishwasher-safe stainless steel grease filters (10-ply) | 1 |
| Exhaust air | |
| Air throughput in Level 1 (m ³ /h) according to EN 61591 | 150 |
| Air throughput in Level 2 (m ³ /h) according to EN 61591 | 290 |
| Air throughput in Level 3 (m ³ /h) according to EN 61591 | 440 |
| Sound power in Level 2 (dB(A) re 1 pW) according to EN 60704-3 | 58.0 |
| Sound pressure in Level 1 (dB(A) re 20 µPa) according to EN 60704-2-13 | 29.0 |
| Sound pressure in Level 2 (dB(A) re 20 µPa) according to EN 60704-2-13 | 43.0 |
| Sound pressure in Level 3 (dB(A) re 20 µPa) according to EN 60704-2-13 | 51.0 |
| Sound pressure in Booster level (dB(A) re 20 µPa) acc. to EN 60704-2-13 | 55.0 |
| Recirculation | |
| Air throughput in Level 1 (m ³ /h) according to EN 61591 | 100 |
| Air throughput in Level 2 (m ³ /h) according to EN 61591 | 235 |
| Air throughput in Intensive level (m ³ /h) according to EN 61591 | 460 |
| Air throughput in Level 3 (m ³ /h) according to EN 61591 | 380 |
| Sound power in Level 1 (dB(A) re 1 pW) according to EN 60704-3 | 49.0 |
| Noise power level in Intensive level (dB(A) re 1 pW) according to EN 60704-3 | 78.0 |

CSDA 7001 FL
SmartLine element
as downdraft extractor for extraction or recirculation operation



EAN: 4002516304906 / Material number: 11402230 / Old Material Number: 27700150GB

| | |
|--|------------|
| Sound power in Level 2 (dB(A) re 1 pW) according to EN 60704-3 | 63.0 |
| Sound power in Level 3 (dB(A) re 1 pW) according to EN 60704-3 | 73.0 |
| Sound pressure in Level 1 (dB(A) re 20 µPa) according to EN 60704-2-13 | 34.0 |
| Sound pressure in Level 2 (dB(A) re 20 µPa) according to EN 60704-2-13 | 49.0 |
| Sound pressure in Level 3 (dB(A) re 20 µPa) according to EN 60704-2-13 | 58.0 |
| Noise pressure level in Intensive level (dB(A) re 20 µPa) according to EN 60704-2-13 | 63.0 |
| Safety | |
| Safety switch-off | • |
| FlameGuard | • |
| Technical data | |
| Dimensions in mm (width) | 120 |
| Dimensions in mm (height) | 168 |
| Dimensions in mm (depth) | 520 |
| Cutout dimensions in mm (width) with surface-mounted installation | 100 |
| Cutout dimensions in mm (depth) with surface-mounted installation | 500 |
| Inner cut-out dimensions in mm (width) with flush installation | 100 |
| Casing height incl. connection box in mm | 168 |
| Inner cut-out dimensions in mm (depth) with flush installation | 500 |
| Weight in kg | 11 |
| Outer cut-out dimensions in mm (width) with flush installation | 124 |
| Outer cut-out dimensions in mm (depth) with flush installation | 524 |
| Total rated load in kW | 0.17 |
| Voltage in V | 230 |
| Fuse rating in A | 10 |
| Number of phases | 1 |
| Length of supply lead in m | 2 |
| Installation notes | |
| Plinth fan with vent connection | • |
| Extraction connection at rear and side | • |
| Dimensions of the exhaust ducting connector in mm | 222 |
| Dimensions of the exhaust ducting connector in mm | 89 |
| Accessories included | |
| Ducting system to the plinth fan | • |
| Optional accessories | |
| Active charcoal filter | DKF 1000 R |

CSDA 7001 FL
SmartLine element
as downdraft extractor for extraction or recirculation operation

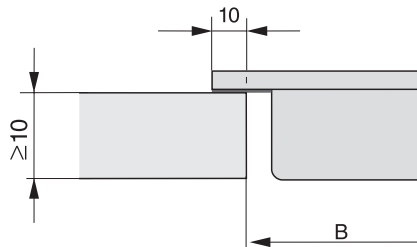

CS 7000 FL (Installation drawing)

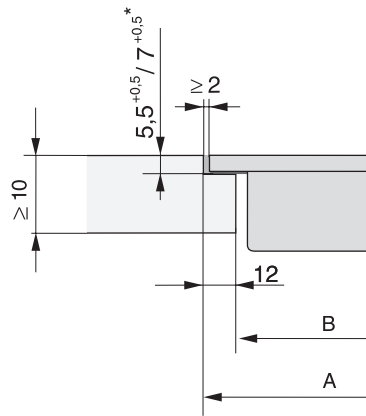

CS 7000 FL, flush (Installation drawing)

*7+0,5 = CS7611 (Wok)

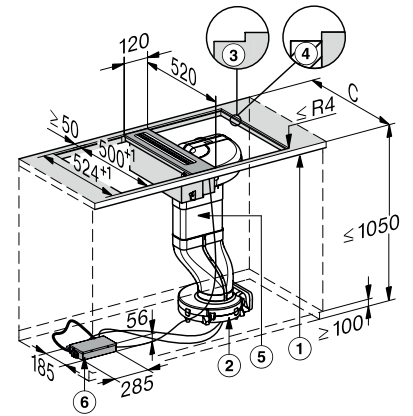

CSDA 7001 - flush (Installation drawing)

1) front, 2) Fan (in the plinth lying on the floor), 3) Stepped cut-out, 4) 12 mm wooden panel (not supplied as standard), 5) Air duct, 6) E-box

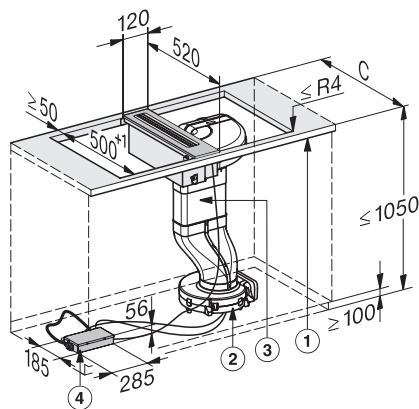

CSDA 7001 - supported installation (Skizze)

1) front, 2) Fan (in the plinth lying on the floor), 3) Air duct, 4) E-Box,

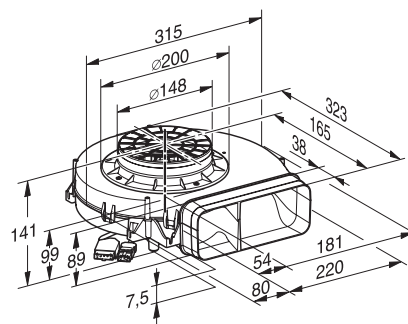

Plinth blower for CSDA 7001 (Installation drawing)