

M 2234 SC

Built-in microwave oven

with sensor controls on the side for convenient operation.



- 7-segment display with sensor controls – EasySensor
- Optimum and even browning – integrated Quartz grill
- Perfect defrosting and cooking – Automatic programmes
- Food remains at serving temperature – keeping warm function
- Perfect and energy-saving lighting – LED lighting

EAN: 4002516103325 / Material number: 11093880 / Old Material Number: 24223420GB

Construction type and design	
Built-in microwave oven	•
Colour	Obsidian black
SideControl	•
Convenience features	
Keeping warm	•
Quartz grill	•
Operating modes	
Automatic programmes	•
Grill	•
Microwave solo operation	•
Microwave/grill combination mode	•
User convenience	
Display	EasySensor
Time of day display	•
Minute minder	•
Programmable cooking duration	•
Quick microwave	•
Individual settings	•
Efficiency and sustainability	
Night dimming	•
Cleaning and care	
Stainless steel oven compartment	•
Safety	
Appliance cooling system and touch-cool front	•
System lock	•
Safety switch-off	•
Safety lock "Door" warning	•
Technical data	
Oven compartment volume in l	17
Door hinge	Left
Oven light	1 LED spot
Oven interior height in cm	20.2
Turntable diameter in cm	27.2
Electronically controlled microwave power	•
Microwave power levels in W	80/150/300/450/600/800
Maximum microwave power in W	800
Grill power rating in W	800
Niche width min. in mm	562
Niche width max. in mm	568
Niche height min. in mm	350
Niche height max. in mm	362
Niche depth in mm	310
Appliance dimensions (W x H x D) in mm	595 x 372 x 310
Appliance width in mm	595
Appliance height in mm	372
Appliance depth in mm	310
Niche-independent venting	•
Weight in kg	14.4
Total rated load in kW	1.25

M 2234 SC

Built-in microwave oven
with sensor controls on the side for convenient operation.



EAN: 4002516103325 / Material number: 11093880 / Old Material Number: 24223420GB

Voltage in V	220-240
Frequency in Hz	50
Fuse rating in A	13
Number of phases	1
Mains cable with plug	•
Length of supply lead in m	1.60
Replacing lamps	Service
Accessories included	
Grilling rack	1
Gourmet plate	1
Turntable	1

M 2234 SC

Built-in microwave oven

with sensor controls on the side for convenient operation.

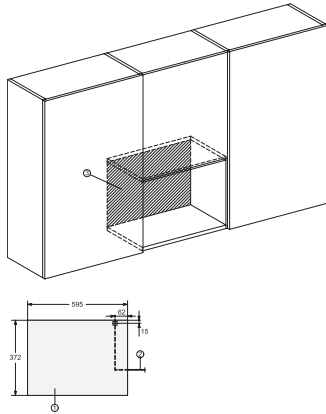

M2230SC, installation drawings

1) Front view, 2) Mains connection cable L=1,600 mm, 3) No connection in this area

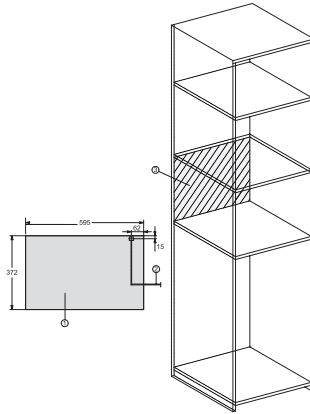

M2230SC, installation drawings

1) Front view, 2) Mains connection cable L=1,600 mm, 3) No connection in this area

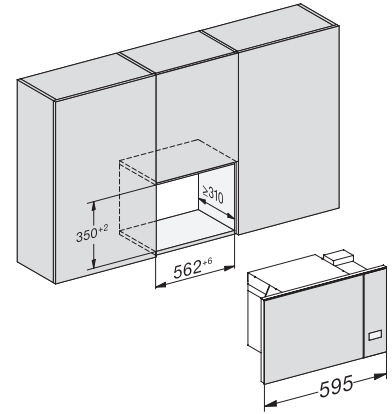

M223xSC, installation drawings

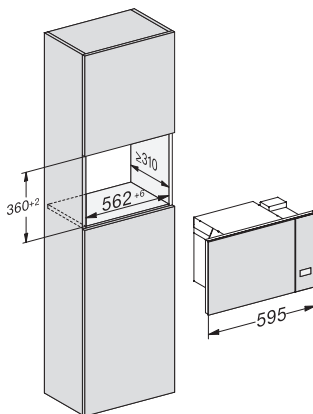

M223xSC, installation drawings

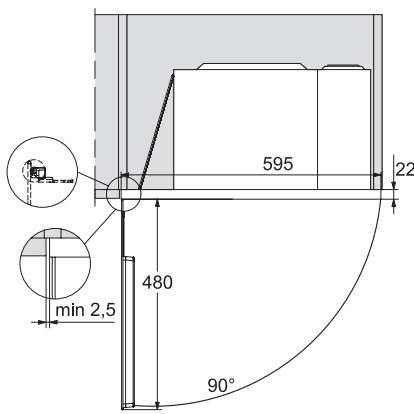

M223xSC, installation drawing

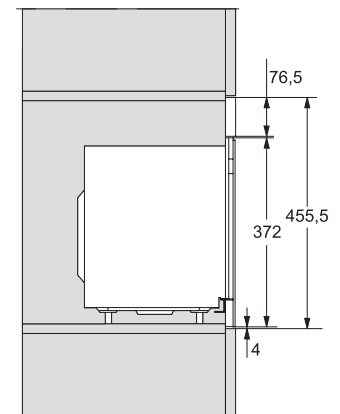

M223xSC, AB45-2, side view installation drawing

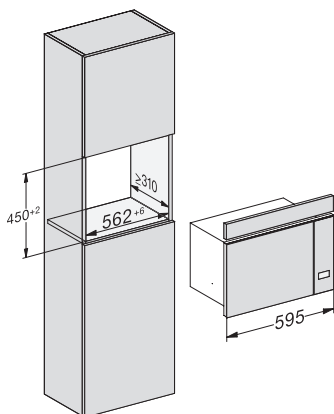

M223xSC, AB45-2, installation drawing

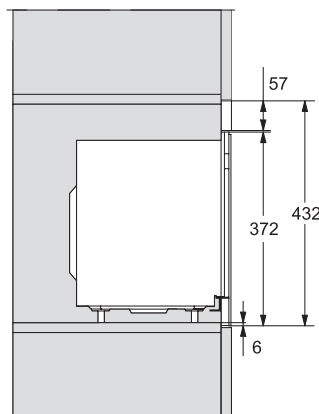

M223xSC, AB42-1, installation drawing

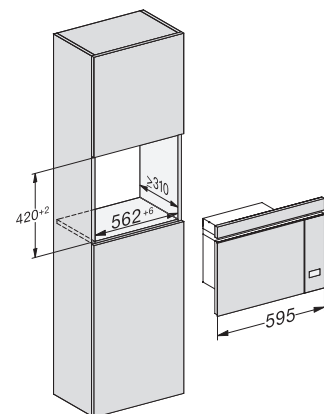

M223xSC, AB42-1, installation drawing

M 2234 SC

Built-in microwave oven
with sensor controls on the side for convenient operation.

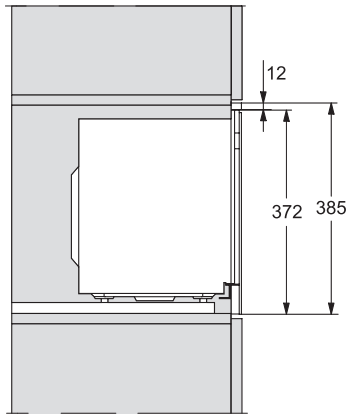

M223xSC, AB38-1, installation drawing

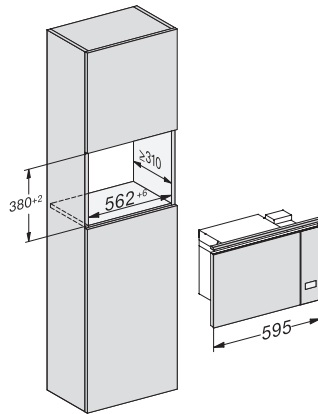

M223xSC, AB38-1, installation drawing

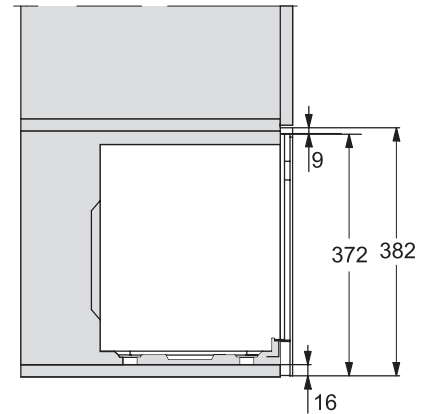

M223xSC, AB36, installation drawing

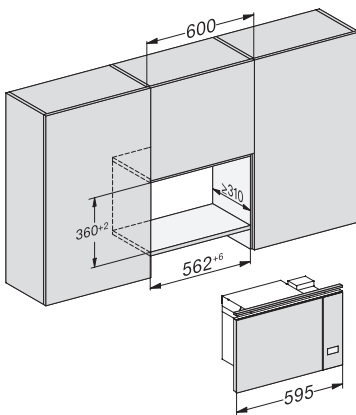

M223xSC, AB36, installation drawing

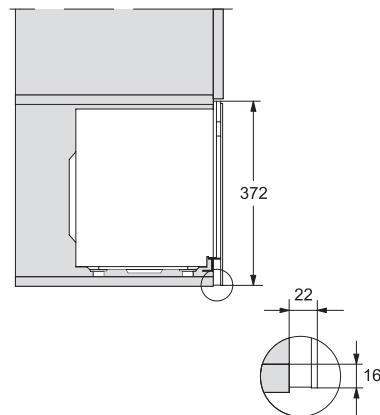

M22xxSC, installation drawing

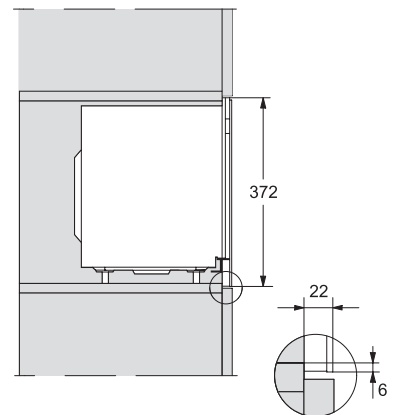

M22xxSC, installation drawing