

WWD660 WCS TDos & 8kg

W1 front-loader washing machine:

A | 8 kg | 1400 rpm | Automatic dispensing | Pre-ironing | Miele@home



- Tested for 20 years of perfect laundry care*
- Save energy in the best energy efficiency class (A)
- Precise and automatic detergent dispensing with TwinDos®**
- The Pre-ironing Extra reduces creasing, saving up to 50 % time and effort***
- Complete app control of your washing machine with Miele@home****

* During the development phase of the W1 / W2 washing machine series, Miele tested models and core components in 5000 wash loads (= 5 wash loads per week for 50 weeks per year) in various programmes. More: miele.com/20years

** Patent EP 2 784 205

*** Patent EP 2 088 231

**** This is a separate digital offer from Miele & Cie. KG. The range of functions can vary depending on the model and the country. Acceptance of the Terms and Conditions and Privacy Policy for Miele digital products and services in the Miele app required. Miele reserves the right to change or discontinue the digital offer at any time.

EAN: 4002516381716 / Material number: 11598210 / Old Material Number: 11WD6601AE

General information

Model identifier	WWD660 WCS TDos & 8kg
Manufacturer material number	11598210
EAN number	4002516381716
Marketing class	Gold

Construction type

Suitable for stacking	•
Door hinging	right
Side-by-side	•
Slot-in	•

Model

Product brand	W1 White Edition
Front-loader	•

Spinning

Max. spin speed	1400
Rinse hold	•
Without spin function	•

Design

Appliance colour	Lotus white
Control panel colour	Lotus white
Door design	Obsidian black with white ring
Rotary selector colour	Lotus White
Control panel version	5° inclined
Control type	Rotary control
Display	DirectSensor yellow, 7 segment

Cleaning performance

TwinDos automatic detergent dispensing	•
CapDosing portioned dispensing	•

Gentle laundry care

Honeycomb drum	•
Load in kg	8

User convenience

Networking with Miele@home	•
Delay start up to 24 hours	•
Time left display	•
AutoClean detergent drawer	•
AddLoad	•

Efficiency and sustainability

Low temperature wash "Cold" and "20 °C"	•
Automatic load control	•
Flow meter	•
Foam sensing	•
ProfiEco motor	•

Wash programmes

Cottons (coloureds)	•
Cottons with pre-wash	•

WWD660 WCS TDos & 8kg

W1 front-loader washing machine:

A | 8 kg | 1400 rpm | Automatic dispensing | Pre-ironing | Miele@home



EAN: 4002516381716 / Material number: 11598210 / Old Material Number: 11WD6601AE

Minimum iron	•
Delicates	•
Shirts	•
Woollens (hand-washable)	•
Express 20	•
Dark garments / Denim	•
Proofing	•
Cottons arrow	•
Drain / Spin	•
ECO 40-60	•
Washing extras	
Short	•
Pre-ironing with steam	•
Safety	
Water protection system	Watercontrol-System
Safety lock	•
PIN-Code	•
Optical interface	•
Technical data	
Dimensions (H x W x D) in mm	850 x 596 x 643
Dimensions in mm (width)	596
Dimensions in mm (height)	850
Dimensions in mm (depth)	643
Appliance depth in mm with opened door	1077
Weight in kg	89
Voltage in V	220-240
Fuse rating in A	13
Frequency in Hz	50
Total rated load in kW	2,10-2,40
Length of water inlet hose in m	1,60
Length of water drain hose in m	1,50
Length of supply lead in m	2
Accessories included	
UltraPhase 1 + 2	•
Voucher for 5 Miele UltraPhase cartridges	•

WWD660 WCS TDos & 8kg

W1 front-loader washing machine:

A | 8 kg | 1400 rpm | Automatic dispensing | Pre-ironing | Miele@home

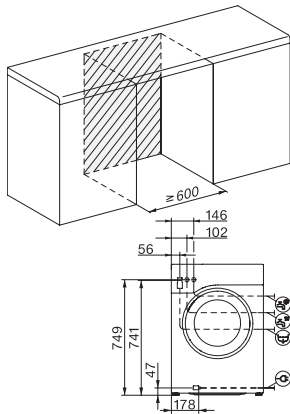

W1 drawing, facia 5 degree, measures in mm

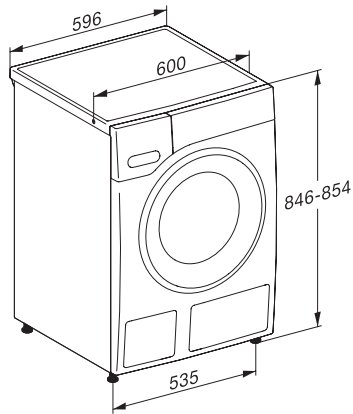

W1 drawing, facia 5 degree, measures in mm

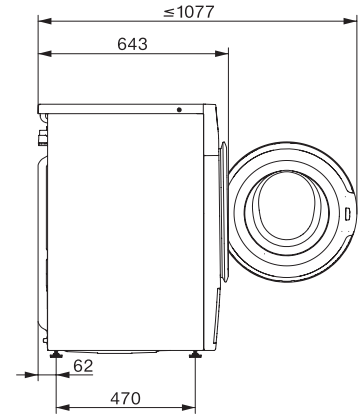

W1 drawing, facia 5 degree, measures in mm

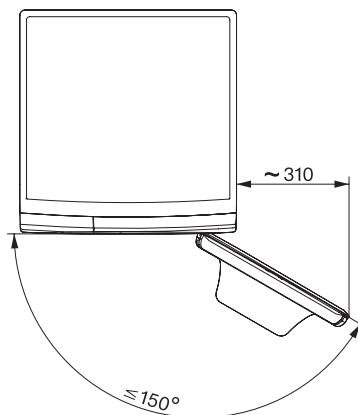

W1 drawing, facia 5 degree, measures in mm