

WWD120 WCS 8kg

W1 front-loader washing machine:

A | 8 kg | 1400 rpm | Pre-ironing | CapDosing | honeycomb drum



- Our honeycomb drum ensures that laundry stays in perfect condition
- The Pre-ironing Extra reduces creasing, saving up to 50 % time and effort*
- Exclusive CapDosing range for different fabrics and stains**
- Easy fingertip operation – DirectSensor
- Economical, powerful and no wear and tear – the ProfiEco Motor

* Patent EP 2 088 231

** Patent EP 2 365 120

EAN: 4002516302940 / Material number: 11458460 /
Old Material Number: 11WD1201AE

Construction type	
Suitable for stacking	•
Side-by-side	•
Slot-in	•
Door hinge	right
Model	
Product brand	W1 White Edition
Front-loader	•
Spinning	
Max. spin speed	1400
Rinse hold	•
Without spin function	•
Design	
Appliance colour	Lotus white
Control panel colour	Lotus white
Door design	Obsidian black with white ring
Rotary selector colour	Lotus White
Control panel version	5° inclined
Control type	Rotary control
Display	DirectSensor yellow, 7 segment
Cleaning performance	
CapDosing portioned dispensing	•
Gentle laundry care	
Honeycomb drum	•
Load in kg	8,0
User convenience	
Delay start up to 24 hours	•
Time left display	•
AutoClean detergent drawer	•
AddLoad	•
Efficiency and sustainability	
Low temperature wash "Cold" and "20 °C"	•
Automatic load control	•
Foam sensing	•
ProfiEco motor	•
Wash programmes	
Cottons (coloureds)	•
Minimum iron	•
Delicates	•
Shirts	•
Woollens (hand-washable)	•
Express 20	•
Dark garments / Denim	•
Proofing	•
Cottons arrow	•
Separate rinse/Starch	•

WWD120 WCS 8kg

W1 front-loader washing machine:

A | 8 kg | 1400 rpm | Pre-ironing | CapDosing | honeycomb drum



EAN: 4002516302940 / Material number: 11458460 /

Old Material Number: 11WD1201AE

Drain / Spin	•
ECO 40-60	•
Washing extras	
Short	•
Pre-wash	•
Water plus	•
Additional rinse cycle	•
Pre-ironing with steam	•
Buzzer	•
Safety	
Water protection system	Watercontrol-System
Safety lock	•
PIN-Code	•
Optical interface	•
Technical data	
Dimensions in mm (width)	596
Dimensions in mm (height)	850
Dimensions in mm (depth)	643
Appliance depth in mm with opened door	1077
Weight in kg	85
Total rated load in kW	2,10-2,40
Voltage in V	220-240
Fuse rating in A	13
Frequency in Hz	50
Length of water inlet hose in m	1,60
Length of water drain hose in m	1,50
Length of supply lead in m	2

WWD120 WCS 8kg

W1 front-loader washing machine:

A | 8 kg | 1400 rpm | Pre-ironing | CapDosing | honeycomb drum



W1 drawing, facia 5 degree, measures in mm



W1 drawing, facia 5 degree, measures in mm

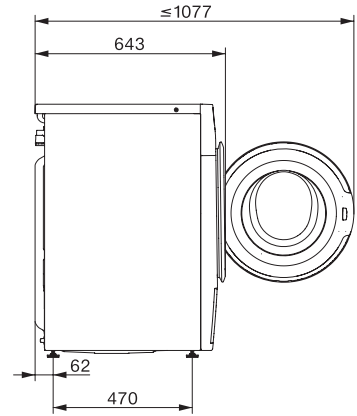

W1 drawing, facia 5 degree, measures in mm



W1 drawing, facia 5 degree, measures in mm