

Installation plan

PG 8130
PG 8131
PG 8132
PG 8133

To avoid the risk of accidents or damage to the machine, it is **essential** to read these instructions as well as the service documents before it is installed, commissioned and used for the first time.

en - GB, IE

Installation notes

Please read and observe the instructions in the operating instruction manual and the service documents regarding installation and setting up of this dishwasher.

Installation requirements

This machine must be installed by a **suitably qualified person** with the appropriate electrical and plumbing qualifications in accordance with the installation instructions supplied.

This machine must be installed in accordance with all applicable standards and guidelines, including legal requirements and health and safety regulations.

The machine must be **commissioned** and operatives trained in its use by Miele Service or by an approved Miele Service Partner only.

Electrical connection

Connection to the electrical supply should be in accordance with valid regulations and safety standards (e.g. BS 7671 in the UK). The connection cable must be protected from the risk of thermal damage. We recommend connecting the machine to the power supply via a suitable **plug and socket** as this will make it easier to carry out the electrical safety test during commissioning and after any service work.

For **hard-wired machines**, connection should be made via a suitable mains switch with all-pole isolation, which in the off position ensures a 3 mm gap between all open contacts.

The main switch and socket must be easily accessible after installation.

Equipotential bonding and earthing

For added safety the machine should be protected with a **residual current device** with a trip current of 30 mA.

Equipotential bonding should be carried out if required. The screw connection point for equipotential bonding is located at the back of the machine. Equipotential bonding and earthing must be carried out before the machine is commissioned.

Water supply

The machine can be plumbed in to the cold water, hot water, demineralised water and drainage points without a **backflow protection device**. The stopcock to the water supply must be easily accessible.

The water supply to the machine can be connected to either cold water or hot water.

Environmental requirements

Condensate can build up in the area surrounding the machine. Any furniture and fittings in the room must therefore be suitable for purpose. If the machine is fitted under a suitable worktop (built-under and integrated models), the stainless steel panel supplied must be fitted above the door aperture to protect the worktop from moisture damage. A suitable stainless steel vapour plate is available to order from Miele.

Connecting an external dispensing system

A dispensing system for liquid detergents and rinsing agents can be connected to the back of the machine.

Dimensions PG 8130-31

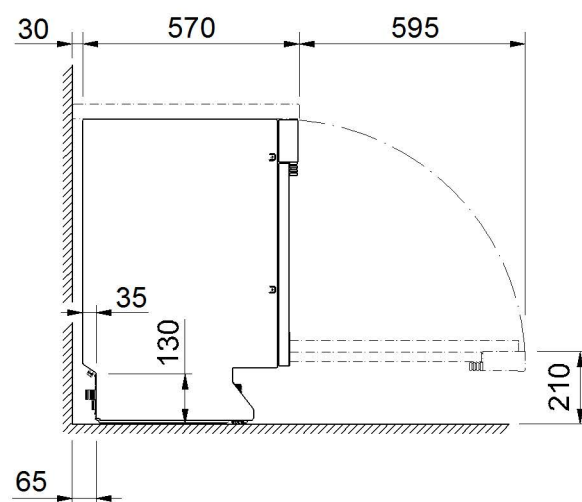
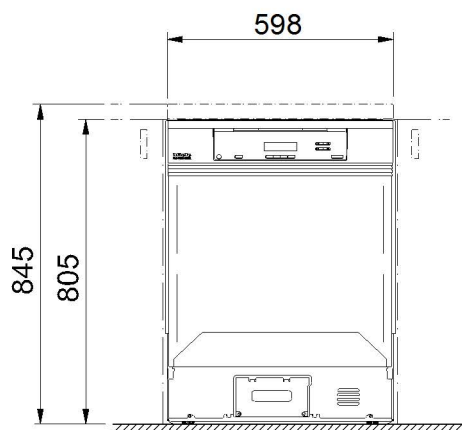

Dimensions PG 8132-33 XXL

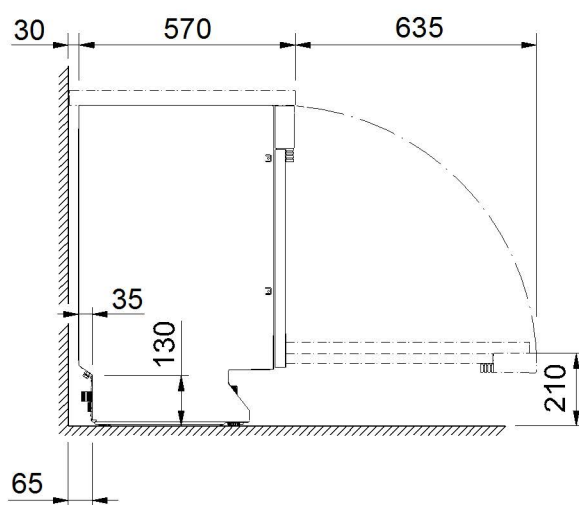
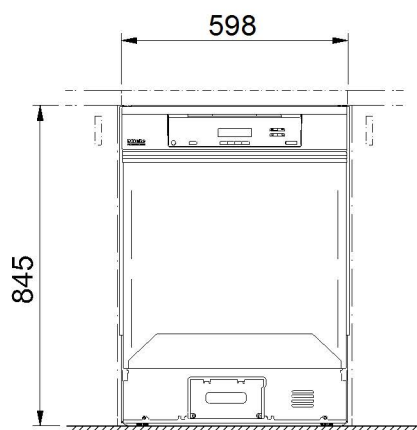

Illustrations

Connections on the back of the machine

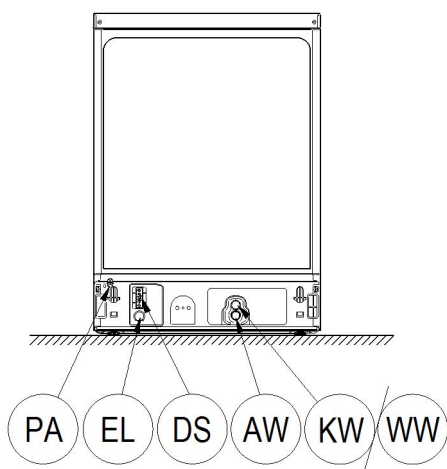

On-site connections

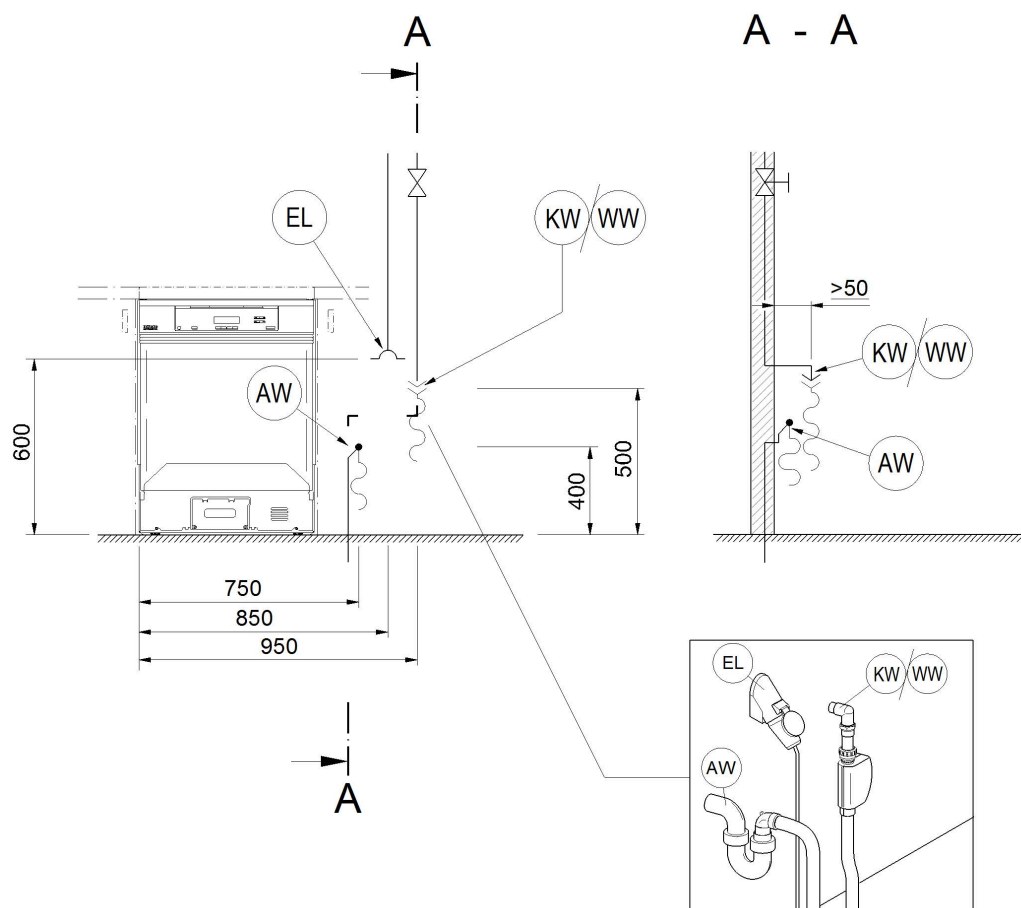

KW/WW Connection to cold or hot water

AW Drain connection

DS External dispensing

EL Electrical connection

PA Equipotential bonding

Machine versions

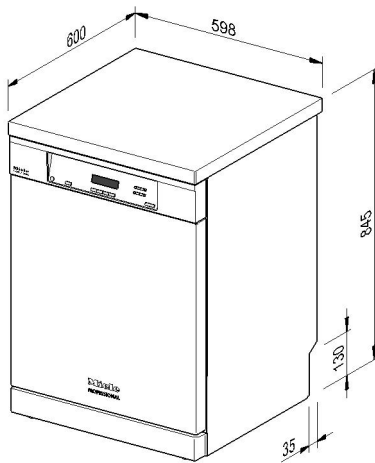

PG 8130 freestanding model

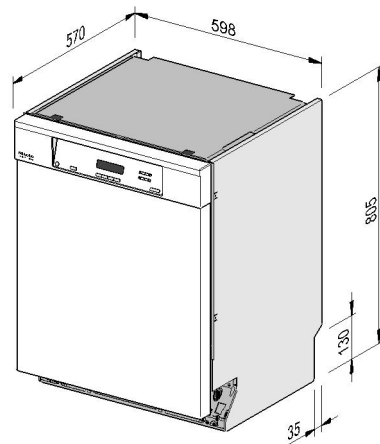

PG 8130 U

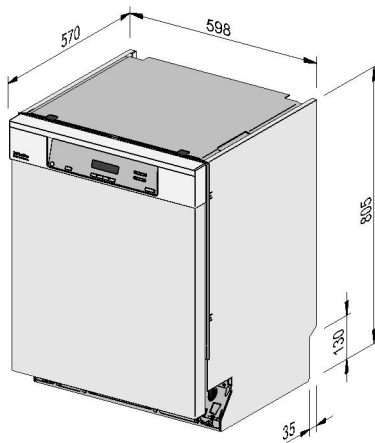

PG 8130 U/i

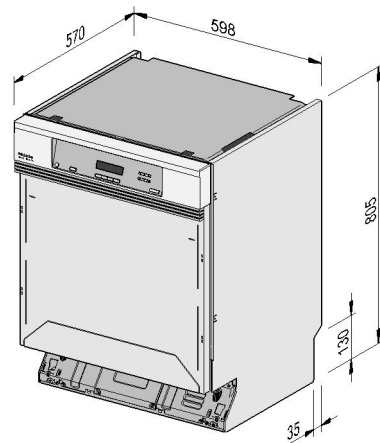

PG 8130i / PG 8131i

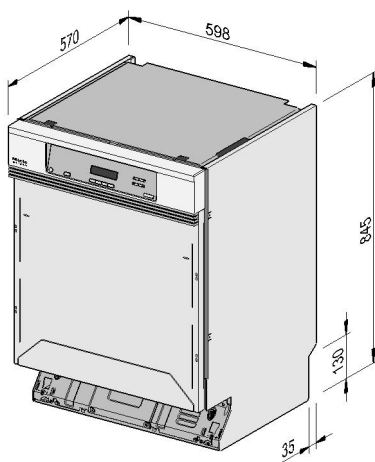

PG 8132 SCi XXL

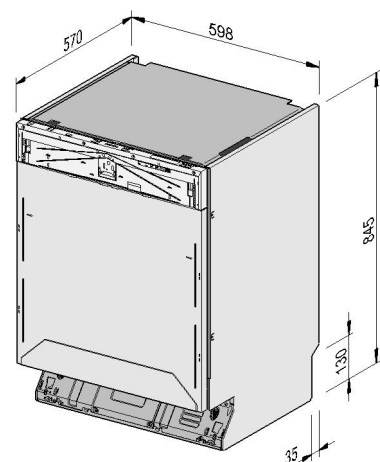

PG 8133 SCVi XXL

Technical data

Electrical connection

Voltage (standard version)	AC 230V/50Hz
Total connected load	6.7 kW
Fuse rating	1 x 30-32 A
Connection cable, cross-section min.	3 x 4 mm ²
Length of connection cable (H05(07)RN-F)	2.8 m

Voltage (convertible)	AC 230V/50Hz
Total connected load	2.3 kW
Fuse rating	1 x 15-16 A
Connection cable, cross-section min.	3 x 1.5 mm ²
Length of mains connection cable (H05(07)RN-F)	2.8 m

Water supply

Maximum temperature	60 °C
Max. permitted water hardness	6.5 mmol/l
	36 °dH
On-site water pressure	30 - 1000 kPa
Recommended flow pressure	200 kPa
On-site threaded union in accordance with DIN 44991 (flat sealing)	3/4 inch
Length of cold water inlet hose	1.5 m

Waste water

Drainage temperature	75 °C
Drain hose length, standard	1.5 m
Drain hose, max. drainage length	4.0 m
Max. drain pump head height from bottom edge of machine	1.0 m
Max. transient flow rate	16 l/min
Hose sleeves to be provided on site (ext. dia. x l)	22 x 30 mm
Drain hose (internal diameter)	22 mm

Machine feet

Machine feet height adjustment	65 mm
Diameter of machine feet	30 mm
Machine feet thread	20 mm

Machine data

Height including lid PG 8130	845 mm
Building-under height PG 8130 / PG 8131	805 mm
Building-under height PG 8132 XXL / PG 8133 XXL	845 mm
Width PG 8130 freestanding model	600 mm
Width without lid	598 mm
Depth PG 8130 freestanding model	600 mm
Depth without lid	570 mm
Door height PG 8130 freestanding model	720 mm
Door height PG 8130-31	650 mm
Door height PG 8132-33 XXL	690 mm
Weight PG 8130 freestanding model	61.5 kg
Weight PG 8130 U	54.0 kg
Weight PG 8130i / PG 8131i	54.7 kg
Weight PG 8132 SCi XXL	56.2 kg
Weight PG 8133 SCVi XXL	56.0 kg
Floor load in operation	1000 N
Minimum access width required, including transport pallet	670 mm
Min. access depth incl. transport pallet	690 mm
Minimum access height required, including transport pallet	970 mm
Noise level in dB (A), sound power pressure LpA during cleaning and drying phases (ECO programme)	45 dB (A)

Ambient conditions

Permitted temperature range in operation	5 - 40 °C
Max. relative humidity up to 31 °C	80 %
Rel. humidity, declining proportionally to 40 °C	50 %
Transport conditions - permitted temperature range	-20 - 60 °C
Transport conditions - permitted relative humidity	10 - 85 %
Transport conditions - permitted air pressure	500 - 1060 hPa
Max. installation altitude above sea level	2000 m

United Kingdom

Miele Co. Ltd.
Fairacres, Marcham Road
Abingdon, Oxon, OX14 1TW
Professional Sales, Tel: 0845 365 6608
E-mail: professional@miele.co.uk
Internet: www.miele.co.uk/professional

Australia

Miele Australia Pty. Ltd.
ACN 005 635 398
ABN 96 005 635 398
1 Gilbert Park Drive, Knoxfield, VIC 3180
Tel: 1300 731 411
Internet: www.miele-professional.com.au
E-mail: info@miele-professional.com.au

China

Miele (Shanghai) Trading Ltd.
1-3 Floor, No. 82 Shi Men Yi Road
Jing' an District, 200040 Shanghai, PRC
Tel: +86 21 6157 3500, Fax: +86 21 6157 3511
E-mail: info@miele.cn, Internet: www.miele.cn

Miele (Hong Kong) Limited

41/F - 4101, Manhattan Place
23 Wang Tai Road
Kowloon Bay, Hong Kong
Tel: (852) 2610 1025, Fax: (852) 3579 1404
Email: customerservices@miele.com.hk
Website: www.miele.hk

India

Miele India Pvt. Ltd.
Ground Floor, Copia Corporate Suites
Plot No. 9, Jasola
New Delhi - 110025
Tel: 011-46 900 000, Fax: 011-46 900 001
E-mail: customercare@miele.in, Internet: www.miele.in

Ireland

Miele Ireland Ltd.
2024 Bianconi Avenue
Citywest Business Campus, Dublin 24
Tel: (01) 461 07 10, Fax: (01) 461 07 97
E-Mail: info@miele.ie, Internet: www.miele.ie

Manufacturer: Miele & Cie. KG
Carl-Miele-Straße 29, 33332 Gütersloh, Germany

**Malaysia**

Miele Sdn Bhd
Suite 12-2, Level 12
Menara Sapura Kencana Petroleum
Solaris Dutamas No. 1, Jalan Dutamas 1
50480 Kuala Lumpur, Malaysia
Phone: +603-6209-0288
Fax: +603-6205-3768

New Zealand

Miele New Zealand Limited
IRD 98 463 631
Level 2, 10 College Hill
Freemans Bay, Auckland 1011, NZ
Tel: 0800 464 353
Internet: www.miele-professional.com.au
E-mail: info@miele-professional.com.au

Singapore

Miele Pte. Ltd.
163 Penang Road
04 - 03 Winsland House II
Singapore 238463
Tel: +65 6735 1191, Fax: +65 6735 1161
E-Mail: info@miele.com.sg
Internet: www.miele.sg

South Africa

Miele (Pty) Ltd
63 Peter Place, Bryanston 2194
P.O. Box 69434, Bryanston 2021
Tel: (011) 875 9000, Fax: (011) 875 9035
E-mail: info@miele.co.za
Internet: www.miele.co.za

United Arab Emirates

Miele Appliances Ltd.
Gold & Diamond Park
Office No. 6-217, Sheikh Zayed Road
P.O. Box 11 47 82 - Dubai
Tel. +971 4 3044 999, Fax. +971 4 3418 852
800-MIELE (64353)
E-Mail: info@miele.ae, Website: www.miele.ae

