

⚠ Please observe the Warning and Safety instructions in the Operating Instructions for your washer-disinfector carefully. You should only process instruments/ medical devices in this unit if they have been declared as suitable for machine processing by the manufacturer. Please also observe the manufacturer's care instructions. The programme selected must be suitable for the materials from which the medical devices to be processed are made. Where possible the programme should include thermal disinfection. The final rinse should, if possible, always be carried out with fully de-mineralised water.

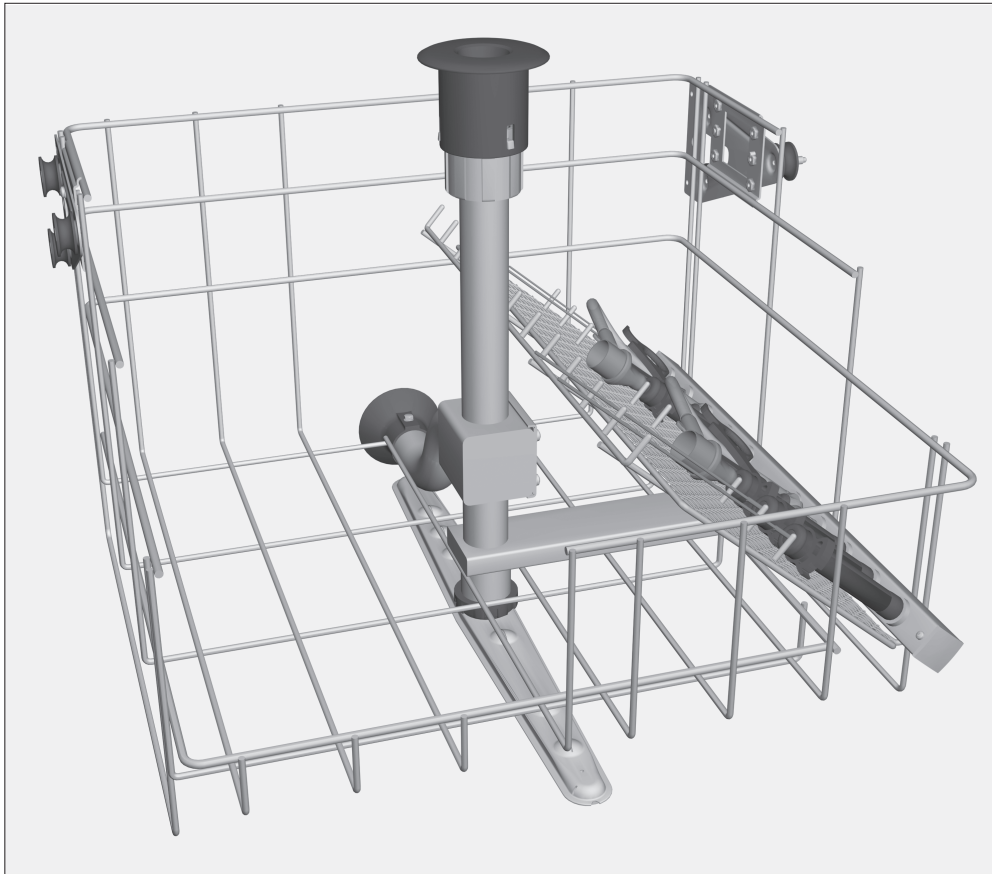

Items supplied:

Upper basket O 176/1
with spray arm magnets for spray arm monitoring (PG 8535 and PG 8536 only).

Other items supplied include:

- 2 x E 442 injector sleeves for instruments Ø 4 - 8 mm, Ø 11 mm, 121 mm long, cap with Ø 6 mm opening
- 2 x E 448 silicone tubes, 300 mm, with Luer lock adapters ♂ for Luer locks ♀
- 1 x E 452 injector jet Ø 2.5 mm, 60 mm long
- 1 x E 453 injector jet with holder Ø 4 mm, 100 mm long
- 1 x E 454 injector jet for trocar sleeves Ø 10 - 15 mm, with spring for height adjustment, Ø 8 mm, 150 mm long
- 2 x spray jets Ø 2.5 mm
- 4 x spray jets Ø 4 mm
- 4 x funnels

Intended use:

The O 176/1 upper basket is designed for machine reprocessing surgical MIS, arthroscopy and urology instruments.

Upper basket O 176/1 can be used in washer-disinfectors G 7835, G 7836, G 7882, G 7882 CD, G 7884, G 7892, PG 8535 and PG 8536.

Upper basket O 176/1 is divided into two areas:

- The right hand side is fitted with an injector unit with 10 possible positions for hollow instruments, e.g. for trocars, cannulae and the shafts of MIS instruments.

Internal cleaning and disinfection to the correct standard is only possible by dismantling the instruments where possible and by using the jets, sleeves and adapters to the full. All instruments should be properly inspected and tested for cleanliness. Do not rely on a visual check alone.

- The left hand side is free and can be equipped with inserts and mesh trays for instruments without lumen, e.g. the E 379 insert (available as an optional accessory).

Before loading the machine and before starting a programme, please check that:

- the silicone adapters in the injector unit are intact and complete.
- injector sleeves, jets and funnels are secure in their silicone holders.

Missing or water-damaged silicone holders must be replaced with new ones. Only then may the basket be used again. If these conditions are present silicone holders standardise the pressure themselves.

Damaged jets, adapters or sleeves etc. must not be used.

- the basket is correctly connected with the water intake in the washer-disinfector.
- the spray arm is able to rotate freely.

For validation purposes always load the basket as specified in the loading example. Individual instruments must not come into contact with each other during the programme.

⚠ To minimise the risk of injury always load the basket starting at the back and working forward, and unload it from the front to the back.

To ensure hollow lumen are accessed by the wash solution, instruments must be dismantled and any taps or valves opened in accordance with manufacturer's instructions. Before connecting hollow instruments, please make sure that all hollow sections are free of blockages. Otherwise the cleaning solution will not be able to access all areas properly.

⚠ Long, narrow shafted instruments which cannot be taken apart must be pre-washed in accordance with the manufacturer's instructions.

Injector sleeves E 442

Injector sleeves E 442 are designed for processing hollow instruments and instruments with a Ø less than 10 mm.

The diameter of the instruments should match that of the opening to the injector sleeves/caps.

- Insert the shaft of the MIS instrument into the injector sleeve with the cap.
- Place high-frequency forceps and electrodes with the functioning end downwards in the injector sleeve with the cap.
- Insert long, narrow instruments which cannot be dismantled into an injector sleeve. The functioning ends must be open, if necessary using an E 472 spring clamp to keep the handle open. Connect at the side of the instrument using an E 448 hose adapter. Connect the hose adapter to the rinsing system using a silicone adapter .
- Insert trocar sleeves with a Ø less than 10 mm into the injector sleeve. Connect at the side with hose adapter E 448. Connect the hose adapter to the rinsing system using a silicone adapter.

Upper basket O 176/1 with injector jets for surgical instruments

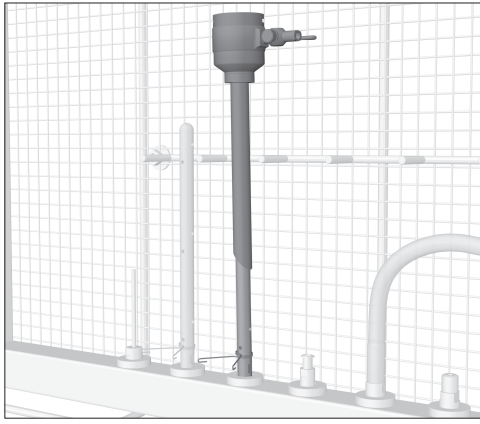

Trocar sleeves Ø 10 - 20 mm

- Take the trocar sleeves apart.

Process small instruments in a mesh tray with a lid.

- Attach trocar sleeves with Ø 10 - 15 mm to an E 454 jet.
- Position the trocar sleeve with the spring clamp so that the water reaches critical areas through the openings in the side of the jet.

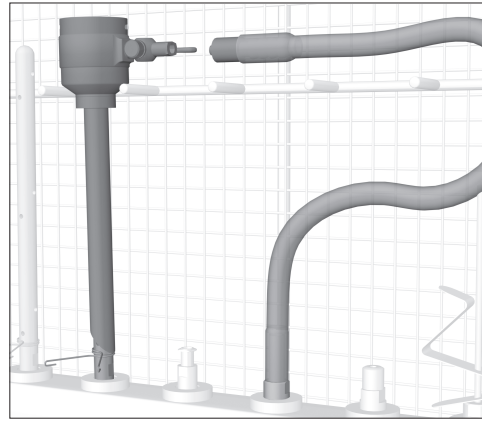

- Connect the trocar tube at the side with hose adapter E 448.
- Screw the hose adapter to the rinsing mechanism.

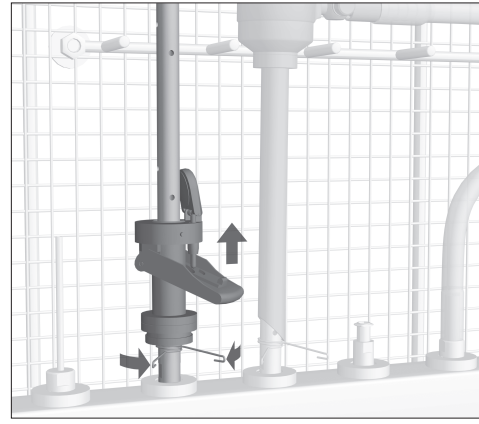

- Secure the self-closing valve to an E 454 jet for trocar sleeves or an E 453 jet with a retaining clip.
- Position the self-closing valve with the spring clamp or retaining clip so that the water reaches critical areas through the openings in the side of the jet.

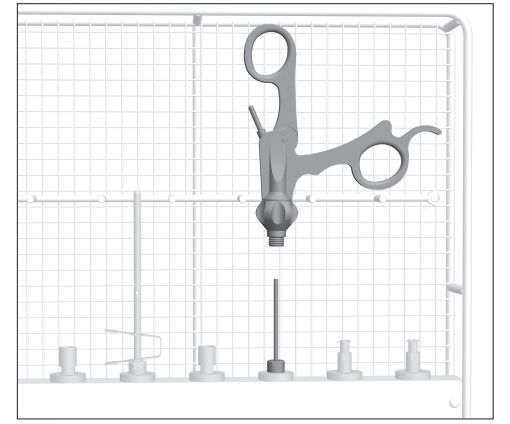

Handles

- Place contaminated handles on a jet, e.g. E 452.

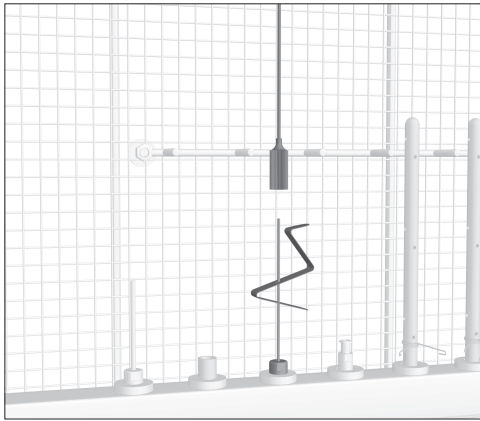

Veress cannulae

- Take the Veress cannula apart.
- Place the outer part of the Veress cannula on an E 453 jet with spring clamp E 472 (optional accessory)

The upper end of the Veress cannula is supported by the wire frame.

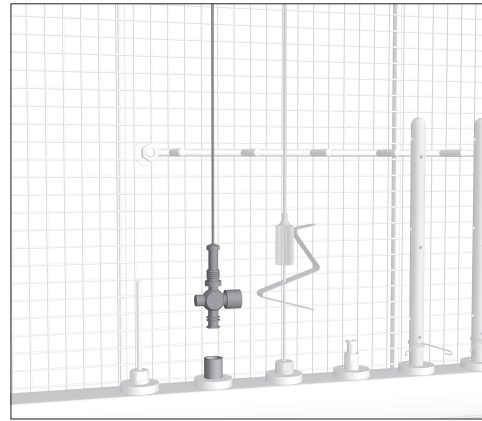

- Screw the inner part of the Veress cannula to a Luer-Lock adapter ♂, keeping the stopcock open.
- The upper end of the Veress cannula is supported by the wire frame.

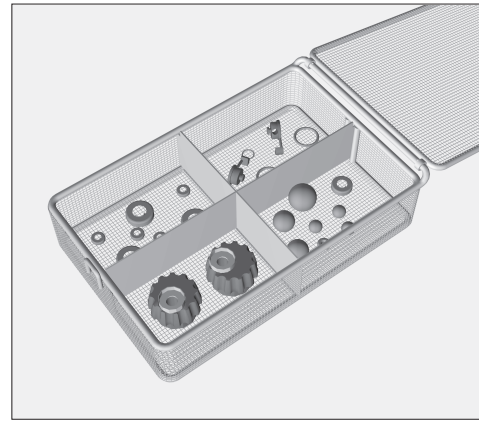

Small instruments

- Small components such as seals, taps etc. should be processed in closable mesh containers, such as an E 451 (optional accessory).
- The closed mesh trays are then placed in the free space on the left hand side of the upper basket.

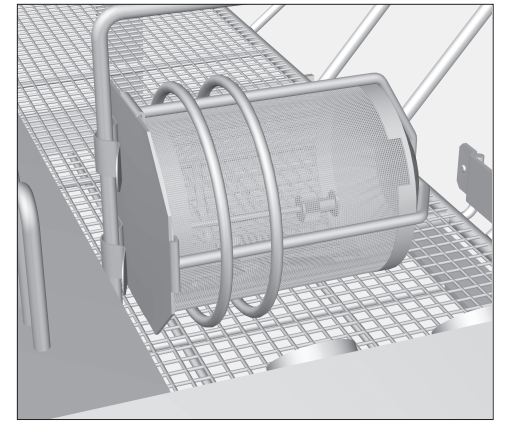

Place very small items (which could be washed through the mesh trays or through the gap between the mesh tray and the lid) in insert E 473/1 (optional accessory).

- Secure insert E 473/1 to one of the struts in the upper basket.

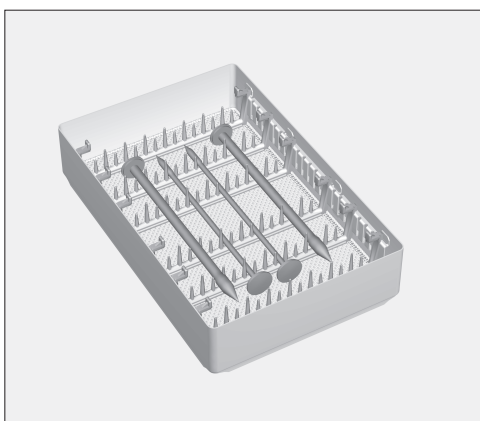

Trocars without lumen

Trocars (without lumen) and micro-instruments can be processed in insert E 441/1 (optional accessory).

- Place the trocars in the notches.
- Place the insert in the free space on the left hand side of the upper basket.

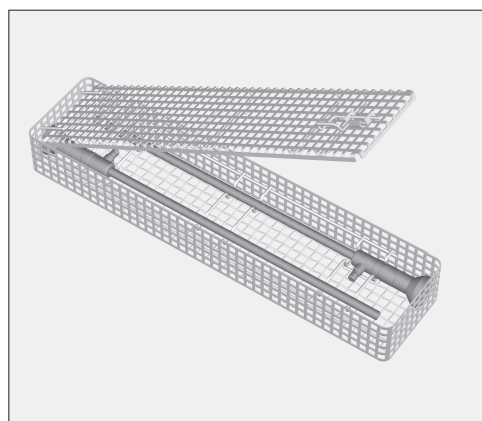

Optical instruments

⚠ In order to protect them from damage, optical instruments must only be processed in the optic manufacturer's inserts, or in Miele's special insert E 460.

- Place the insert in the free space on the left hand side of the upper basket.