

E 913/3 mobile unit for operating theatre instruments and containers



Items supplied:

- Mobile unit E 913/3 with three levels, H 570, W 636, D 790 mm
- Connectors for hollow instruments on the second level:
- 2 x E 447 Luer lock adapters ♀ for Luer locks ♂
 - 3 x Ø 3 mm injector jets, 24 mm long
 - 1 magnetic strip for automatic mobile unit recognition
 - Spray arm magnets for spray arm monitoring (PG 8527/28 only)

- Optional accessories
- E 142 DIN mesh tray
 - A2 1/2 cover net, 216 x 456 mm
 - E 476 holders for micro instruments
 - Insert E 473/1 for small instruments

⚠ Please read the Warning and Safety instructions in the Operating Instructions for your G 7827/28 or PG 8527/28 Washer-disinfector carefully. You should only process medical devices in this mobile unit if they have been declared as suitable for machine processing by the manufacturer. Please also observe the manufacturer's care instructions. The programme selected must be suitable for the materials from which the items to be processed are made. Where possible, the programme should include thermal disinfection. The final rinse should, if possible, always be carried out with fully de-mineralised water. If using automatic mobile unit recognition please make sure that the coding is correctly set.

Areas of application:

The lowest level of the E 913/3 mobile unit can be used to process three shallow DIN containers and their lids (160 x 300 x 600 mm*).

The two upper levels of the mobile unit can each be used to accommodate three DIN mesh trays of surgical instruments.

The second level of the mobile unit can take up to five hollow instruments using injector jets and Luer lock adapters.

* Dimensions are given in mm for containers including their lids (height x width x length), manufactured in accordance with DIN EN 868-8

Important:

A pH neutral cleaning agent must be used for anodised aluminium containers. Coloured anodised aluminium containers must be cleaned, thermally disinfected and rinsed using fully de-mineralised water.

- Add a suitable rinsing agent when processing plastic containers and lids for quicker and better drying results.
- Remove any textile or paper filters from lids before processing.
- Teflon filters may be left in lids unless the manufacturer's instructions state otherwise.
- Check that the valve is functioning correctly after processing disposal containers with valves.

Note:

Please follow all relevant health and safety regulations on disinfection parameters and personal safety to prevent the risk of injury.

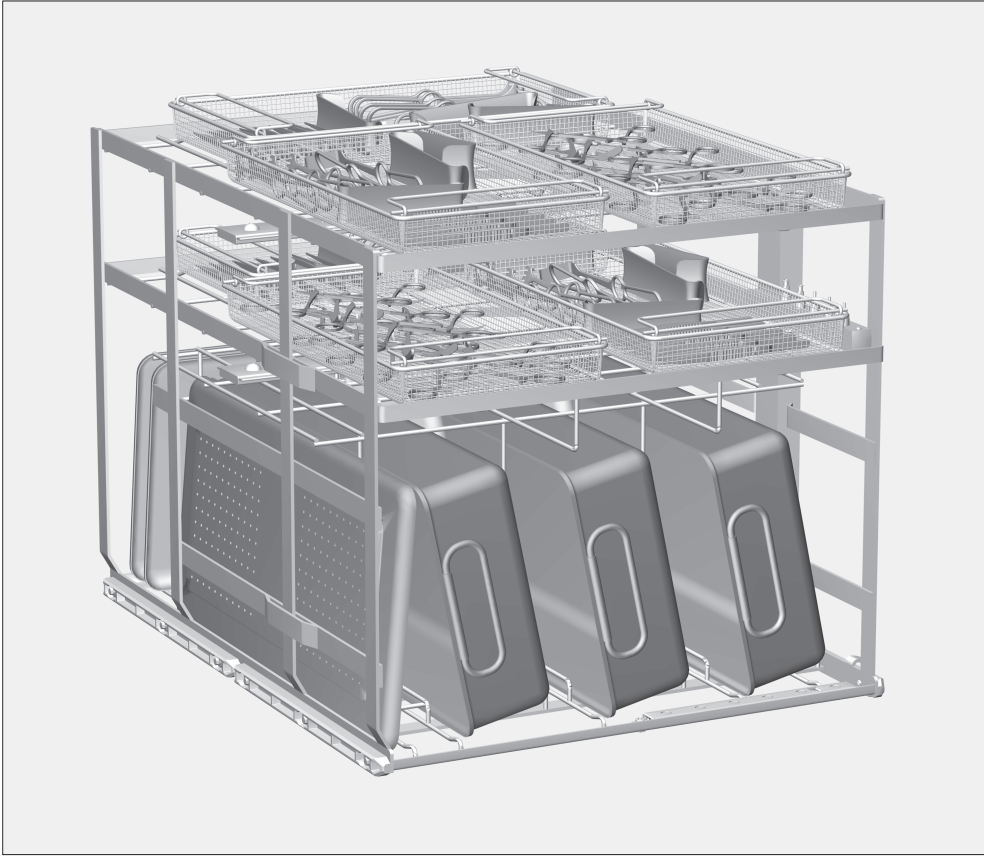

Before loading the machine and before starting a programme, please check:

- that the spray arms rotate freely,
- that the spray arm jets are clean and free of any blockages,
- that the mobile unit is correctly fitted into the cabinet and that it has connected correctly with the water intake.

For validation purposes please make sure that you follow the loading instructions given on the template.

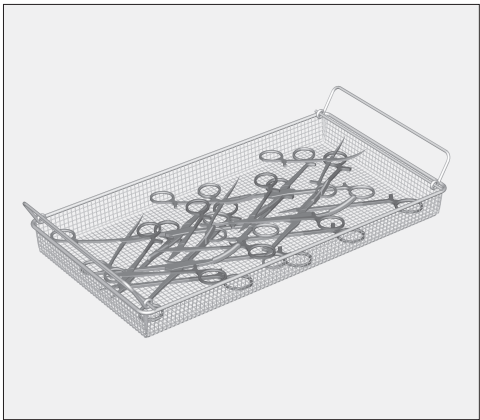

- Hinged instruments must be opened up before being placed in the mesh trays to minimise the risk of surfaces not being accessed during processing.

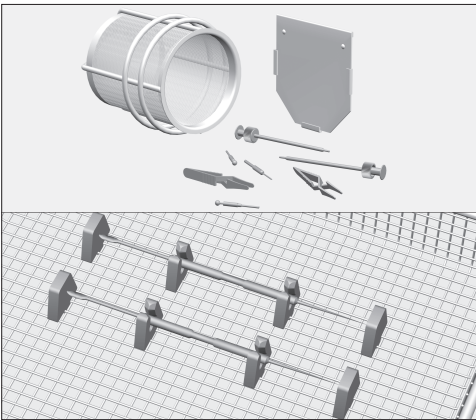

- To prevent the risk of lightweight instruments such as bulldog clips and other small items being moved about during processing, silicone holders e.g. E 476 and closable inserts e.g. E 473 can be used to keep them secure.

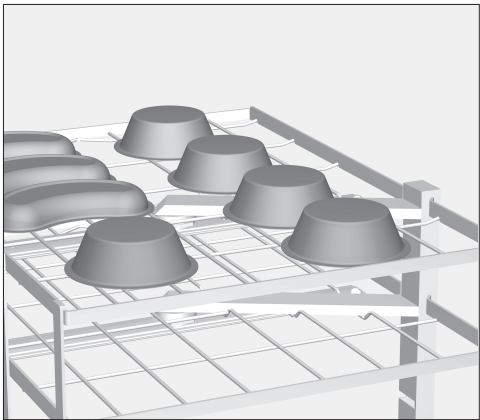

- Containers e.g. beakers and kidney dishes should be placed in the mobile unit with the open side facing downwards, ensuring that all surfaces can be accessed easily and that cleaning solution can flow freely off them. They must also be secure so that they cannot be flipped over by the force of water during processing.

⚠ If hollow containers are placed such that cleaning solution can collect in recesses etc., they will not get properly clean and rinsing results will be impaired.

Connection for hollow instruments

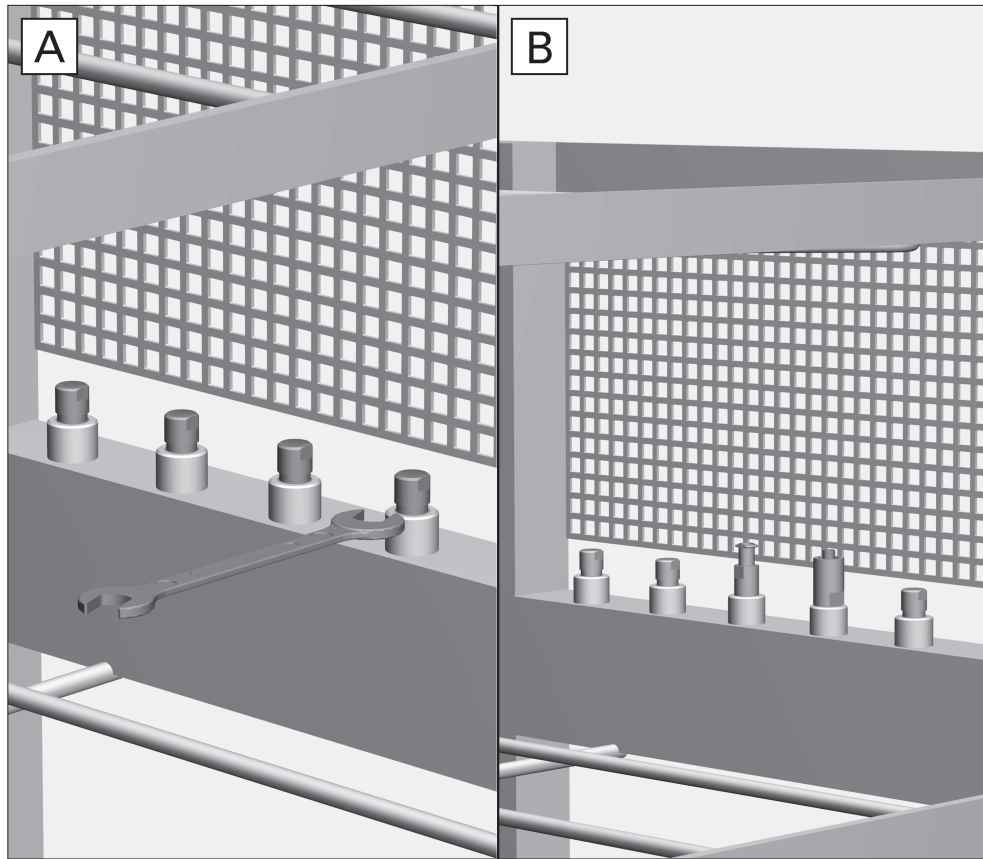

Injector jets and Luer lock adapters

Up to five hollow instruments can be processed in the second level of the mobile unit using the injector jets and Luer lock adapters supplied.

To do this:

- Unscrew the locking caps from the connectors using an SW 7 spanner **(A)**.
- Screw the Luer lock adapters or the injector jets into the connectors and tighten them with the spanner **(B)**.

⚠ To ensure a suitable standardised spray pressure for all connections, all screw connectors must be fitted with jets, adapters, sleeves or blanking screws.

Damaged jets, adapters or sleeves etc. must not be used.

Empty jets, etc. do not have to be replaced with blanking screws.

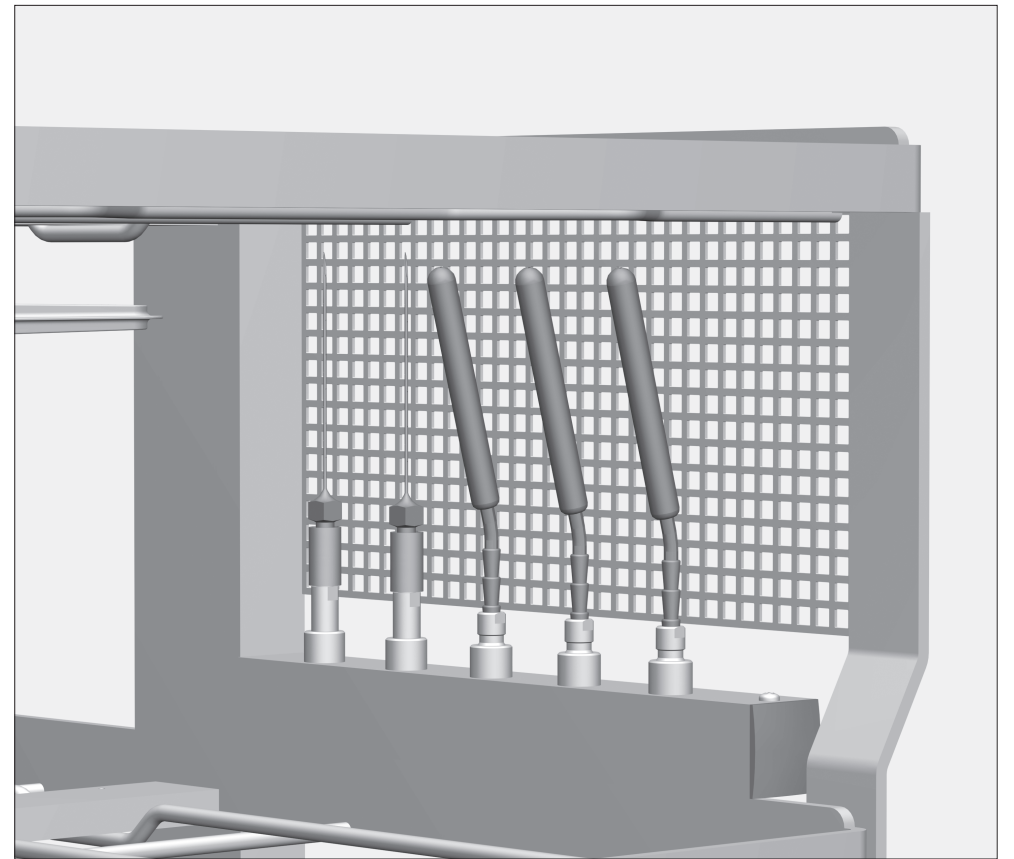

To connect hollow instruments

⚠ Before connecting hollow instruments, please make sure that all hollow sections are free of blockages. Otherwise the cleaning solution will not be able to access all areas properly.

- Cannulae with Luer lock connectors should be connected to the appropriate Luer lock adapters in the mobile unit.
- Cannulae with female connectors should be connected to the Luer lock adapter in the mobile unit using a Luer lock ♂ / Luer lock ♂ connecting piece.
- Surgical suction devices, e.g. Cooleys, should be connected to the jets.

⚠ Any hollow instruments that have become disconnected from the adapters during processing must be reprocessed.