

# Mobile unit E 901/2 for surgical instruments



### Items supplied:

Mobile unit E 901/2 with four levels, H 590, W 640, D 790 mm, fitted with a magnetic strip for automatic mobile unit recognition and spray arm magnets for spray arm monitoring (PG 8527/28 only).

### Supplied as separate items:

- 2 x E 447 Luer lock adapters ♀ for Luer locks ♂
- 2 x E 449 Luer lock adapters ♂ for Luer locks ♀
- 3 x E 362 blanking screws
- 3 x E 980 angle adapters
- 4 x Ø 4.0 mm injector jets, 110 mm long
- 3 x Ø 4.0 mm injector jets with spring clips, 120 mm long

### Optional accessories

- E 142 DIN mesh tray
- E 476 holders for micro instruments
- E 448 hose connectors for Luer lock ♂
- Insert E 473/1 for small instruments
- Half insert E 492 for kidney dishes



### Before loading the machine and before starting a programme, please check:

- that the spray arms rotate freely,
- that the spray arm jets are clean and free of any blockages,
- that the mobile unit is correctly fitted into the cabinet and that it has connected correctly with the water intake.

For validation purposes please make sure that you follow the loading instructions given on the template.

⚠ To ensure a suitable standardised spray pressure for all connections, all screw connectors must be fitted with jets, adapters, sleeves or blanking screws. Damaged jets, adapters or sleeves etc. must not be used.

Empty jets, etc. do not have to be replaced with blanking screws.

### Areas of application:

DIN or ISO mesh trays containing surgical instruments can be processed on the lower three levels.  
Up to 8 hollow instruments/suction tubes can be processed in addition to the mesh trays.

Loading dimensions (Levels are numbered from the bottom upwards)	[H x W x D in mm]
Level 1	80 x 593 x 780
Level 2	80 x 593 x 780
Level 3	80 x 593 x 780
Level 4	210 x 520 x 780

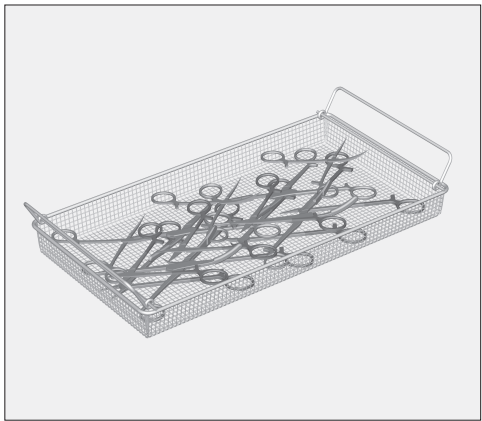

- Hinged instruments must be opened up before being placed in the mesh trays to minimise the risk of surfaces not being accessed during processing.

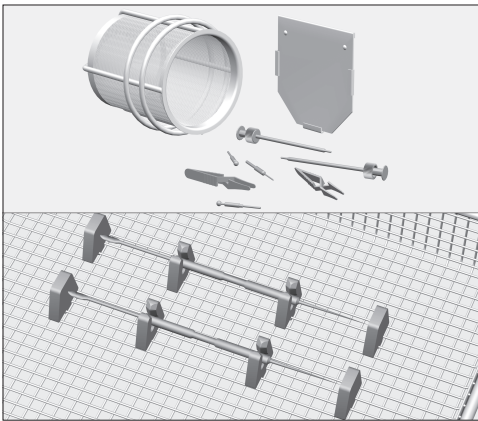

- To prevent the risk of light instruments such as bulldog clips and other small items moving about during processing, closable inserts (e.g. E 473) and silicone holders (e.g. E 476) can be used to keep them secure.

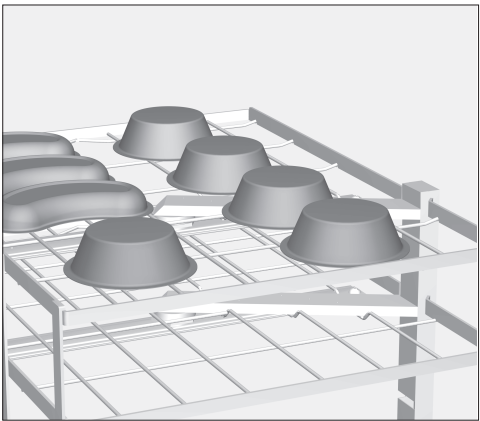

- Containers e.g. beakers and kidney dishes, should be placed in the mobile unit with the open side facing downwards, ensuring that all surfaces can be accessed easily and that cleaning solution can flow freely off them. They must also be secure so that they cannot be flipped over by the force of water during processing.

If hollow containers are placed such that cleaning solution can collect in recesses etc., they will not get properly clean and rinsing results will be impaired.

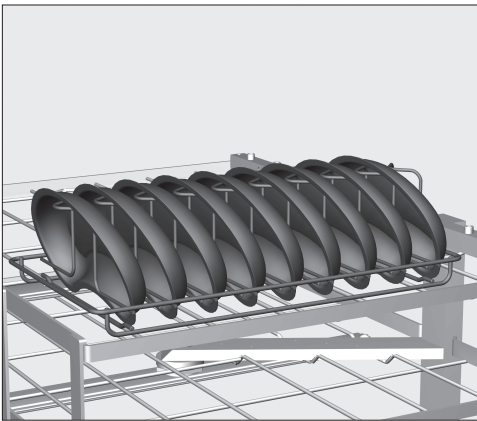

- If necessary, a cover net or suitable insert, e. g. an E 492 for kidney dishes, can be used to secure these containers.

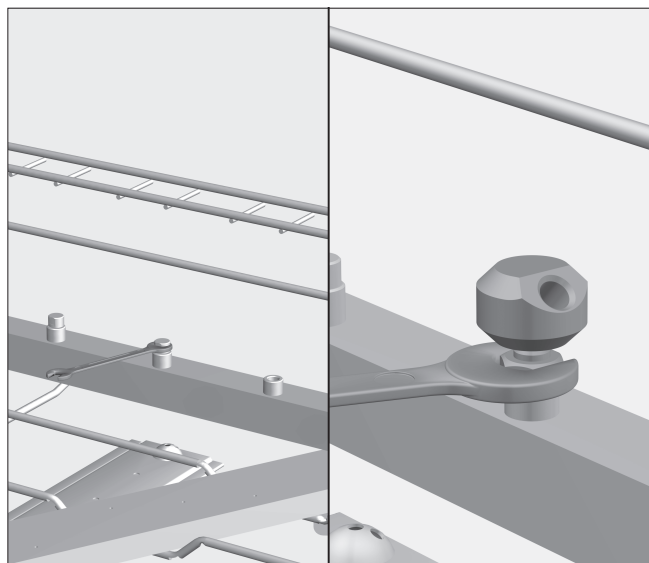

## To fit the angle adaptors

If required, injector jets or Luer lock adapters can be fitted to the upper level of the mobile unit using the angle adaptors supplied.

To do this:

- Unscrew the blanking screws from the connectors using an SW 9 spanner.
- Screw the angle adaptors for the Luer lock adapters or the injector jets into the connectors, and align.
- Secure using SW 13 counter nuts.

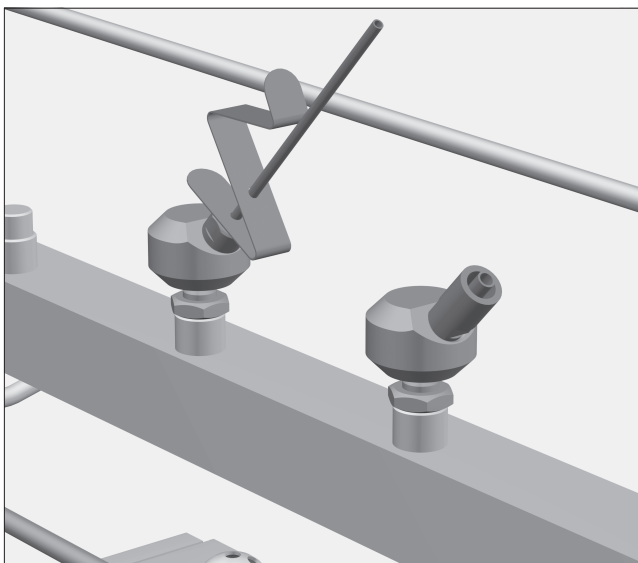

## To screw the angle adapters to the jets

In order to connect long suction tubes or hollow instruments, the injector jets need to be fitted to the angle adapters using clamp springs or Luer lock adapters.

To do this:

- Screw the Luer lock adapter or injector jet into the angle adapter, and tighten with an SW 7 or SW 9 spanner (depending on the jet).

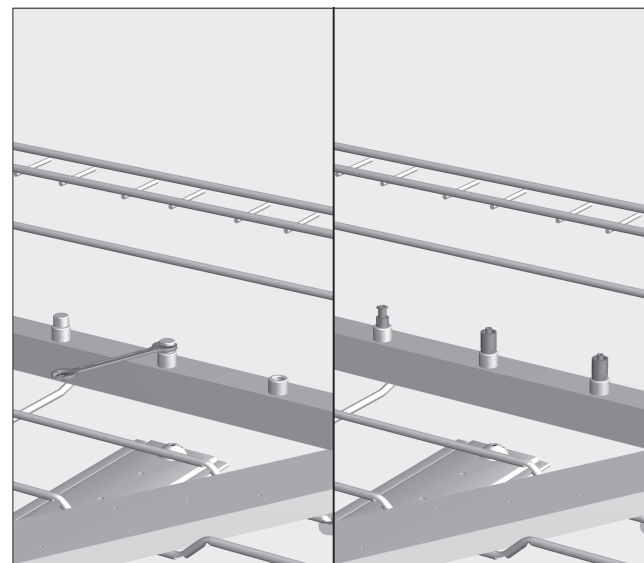

## To fit injector jets and Luer lock adapters

Up to 8 hollow instruments can be processed in the top level of the mobile unit using the injector jets and Luer lock adapters supplied.

To do this:

- Unscrew the blanking screws from the connectors using an SW 9 spanner.
- Screw the Luer lock adapters or the injector jets into the connectors and tighten them with a spanner.

## Connecting hollow instruments

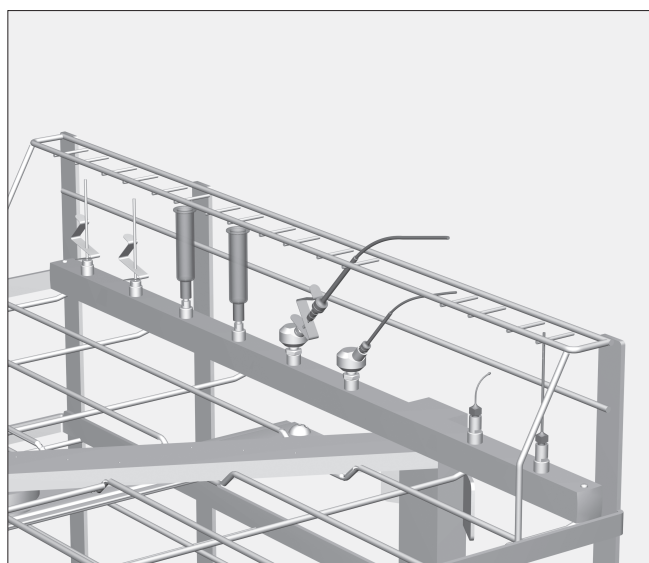

⚠ Before connecting hollow instruments, please make sure that all hollow sections are free of blockages. Otherwise the cleaning solution will not be able to access all areas properly.

- Cannulae with Luer lock connectors should be connected to the appropriate Luer lock adapters in the injector unit.
- Surgical suction devices, e.g. Cooleys, should be connected to the jets on the angle adapters.

⚠ Any hollow instruments that have become disconnected from the adapters during processing must be reprocessed.

## E 448 hose connectors (optional accessory)

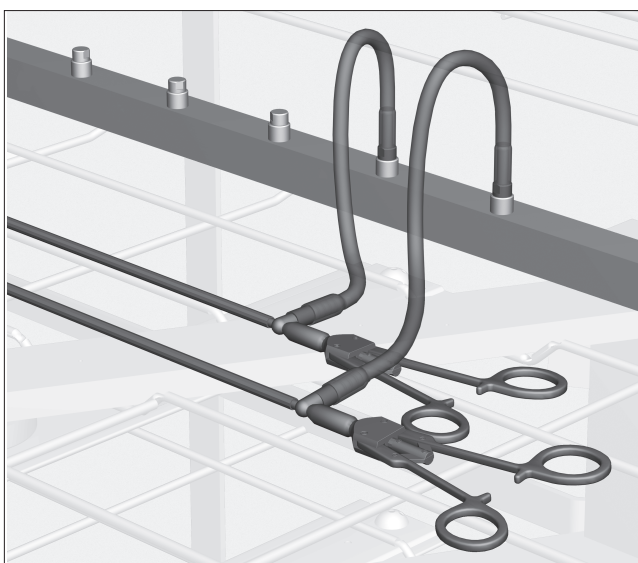

E 448 hose connectors can be fitted if necessary in the upper level of the mobile unit. Long hollow instruments can then be connected to the module and placed in the upper level of the mobile unit.

### To connect hollow instruments

- Connect long hollow instruments with Luer lock adapters to a silicone tube.
- Place the hollow instruments on the rack in the mobile injector unit, if possible in a mesh tray.
- Unscrew hollow instruments after cleaning.

⚠ Any hollow instruments that have become disconnected from the adapters during processing must be reprocessed.

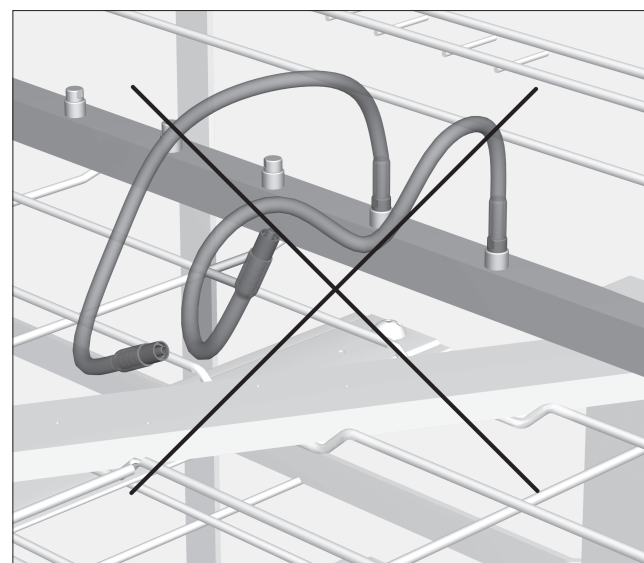

⚠ Any hose connectors not in use should be fitted with E 362 blanking screws or jets of a smaller diameter.

Water pressure can cause the unattached ends of the hose connectors to spin around which can cause damage to items, e.g. the glass door of the washer-disinfector.