

Before the first use

⚠ Damage from incorrect installation and connection.
Installing and connecting the washing machine incorrectly will cause serious damage to property. See "Installation".

⚠ Damage resulting from failure to remove the shipping struts.
Failure to remove the shipping struts can result in damage to the washing machine and to adjacent cabinetry or appliances. Remove the shipping struts as described in "Installation and connection".

Switching on the washing machine

■ Turn the program selector to the *Normal* program.
The welcome tone will sound and the welcome screen will light up.
The display will now guide you through the initial commissioning process, which is divided into 5 steps.
For additional information, please refer to the separate operating instructions supplied.

Operation

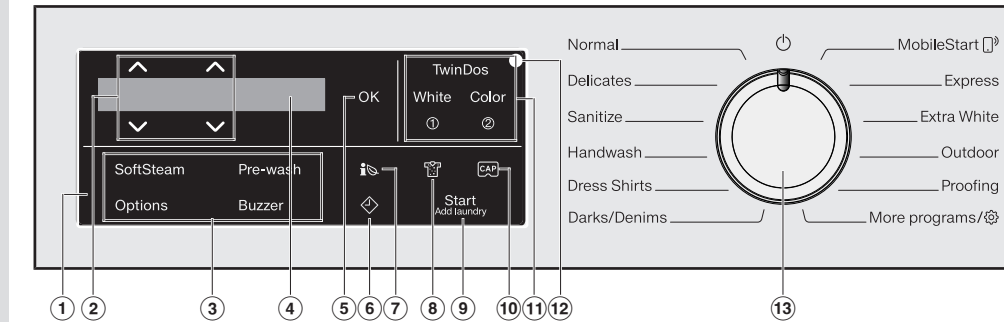

1 Control field

The control field consists of a display and various sensor buttons.

2 V sensor buttons

The values in the display can be changed with the V sensor buttons.

3 Sensor buttons for options

You can supplement the wash programs with options.

4 Display

Various values are displayed and/or selected on the display.

5 OK sensor button

Confirm the selected values with the OK sensor button.

6 sensor button

The sensor button starts the Delay Start function.

7 sensor button

You can view information about the energy and water consumption of your washing machine with the sensor button.

8 sensor button

You can specify the degree of soiling of the load in 3 settings. This sensor button is only active when the TwinDos option is activated.

9 Start/Add laundry sensor button

Touching the Start/Add laundry sensor button starts the selected program. The sensor button lights up constantly.

10 sensor button

Activates CapDosing via the detergent drawer.

11 TwinDos sensor button with the additional Whites and Colors sensor buttons

Deactivate or activate automatic detergent dispensing via the TwinDos sensor button.

12 Optical interface

This is used by the Service department as a transmission point.

13 Program selector

For selecting programs and for switching the machine off. The washing machine is switched on when you select a program, and switched off by turning the program selector to the position.

Operating the sensor buttons
The sensor buttons react to fingertip contact. If a sensor button is illuminated, it can be selected.
If a sensor button is brightly lit, this means: currently selected
If a sensor button is dimly lit, this means: selection possible

Environmentally friendly washing

- Make use of the maximum load that the wash program can accommodate. This will keep energy and water consumption to a minimum in relation to the size of the load.
- Use the program for small, lightly soiled loads.

- Modern detergents make it possible to wash at lower temperatures (e.g., 70°F/20°C). Using the corresponding temperature settings will save energy.

- Washing at low temperatures and/or using liquid detergents can cause bacteria and odors to build up in the washing machine. Miele therefore recommends cleaning the washing machine once every month.
The washing machine provides you with a reminder with the message Sanitize info: Run the "Sanitize" or "Clean Machine" program in the display.

Preparing the laundry

1. Preparing the laundry



- Empty all pockets.
- Damage due to foreign objects. Nails, coins, paper clips, and so on can cause damage to garments and components in the machine. Check the laundry before washing and remove any such foreign objects.
- Sort the laundry by color and by care label. Most garments have a textile care label in the collar or side seam.
- Pre-treat stains and badly soiled areas.

2. Selecting a program

There are three possible ways to select a program.

1. Selecting the standard programs with the program selector dial

- Turn the program selector to the required program. The selected program will be shown in the display. This will then be replaced by the standard display.

2. Selecting additional programs by setting the program selector to "Additional programs" and using the display.

- Turn the program selector to the *Additional programs/* position. The following appears in the display: *Table Linens/Drapes*
- Touch the V sensor buttons until the program you want appears in the display.
- Confirm the program with the OK sensor button.

3. Selecting additional programs by setting the program selector to MobileStart and using the Miele app

- Turn the program selector to the *MobileStart* position.

The following appears in the display:
Load laundry, close the door and press "Start". Appliance can be remotely controlled

- Follow the instructions in the display and start the program.

The following appears in the display:
MobileStart

The washing machine can now be operated with the Miele app.

Selecting a program

3. Loading the washing machine

Opening the door

- Take hold of the door and pull it open.
- Unfold the laundry and load loosely into the drum.

Closing the door

- Make sure that no items are caught between the door and the seal.
- Shut the door gently.

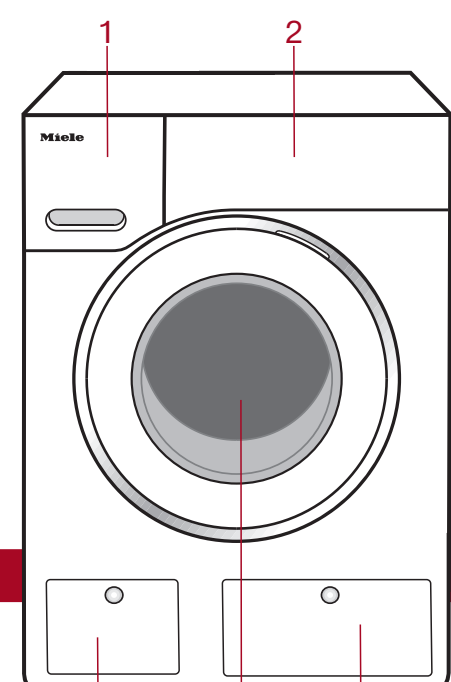

- 1 Detergent drawer
- 2 Control panel
- 3 Drain filter
- 4 Door
- 5 TwinDos dispensing

4. Selecting program settings

Selecting a temperature/spin speed

- Touch the V sensor buttons above or below the temperature or spin speed value in the display until the temperature/spin speed you want appears in the display.

Selecting options

There are 2 ways of selecting options.

1. Directly via the sensor buttons

- Touch the sensor button for the required option. It will then light up brightly.

2. Via the Options sensor button and the display

- Touch the Options sensor button. The following appears in the display: *No Options*
- Touch the V sensor buttons until the option you want appears in the display and confirm this with the OK sensor button.

Degree of soiling

The sensor button is only active when the *TwinDos* sensor button is activated.

- Light
No visible soiling or stains
- Normal
Visibly soiled and/or just a few slight stains
- Heavy
Heavily soiled and/or stains clearly visible

Delay Start/SmartStart

Delay Start
With the Delay Start function, you can delay the start of the program. The start of the program can be delayed from 15 minutes up to a maximum of 24 hours.

SmartStart
The SmartStart function lets you define a time period during which your washing machine will start automatically. The washing machine is started via a signal, e.g., from your energy supplier, that indicates that the electricity rate is particularly economical.

Add detergent

There are several options for adding detergent to the washing machine.

TwinDos

TwinDos dispensing is automatically activated for all programs in which dispensing is possible.

Changing TwinDos dispensing

You can change the suggested color composition of the laundry.

Deactivating TwinDos dispensing

Touch the *TwinDos* sensor button. The sensor button is only dimly lit and dispensing is deactivated.

Filling with detergent

This washing machine requires particularly efficient detergent. Add detergent in accordance with the value in the pull-down dosage display.

he

Ensure that *TwinDos* dispensing is deactivated.

Pull out the detergent drawer and add detergent to the compartments.

Chlorine bleach for removing stains or liquid detergent for the pre-wash

Detergent for the main wash, including Soak if selected

Fabric softener, liquid starch, or caps

CapDosing

If you selected CapDosing when setting the program, detergent will be dispensed via the capsule for this wash program.

Using powder detergent

The detergent drawer contains an insert for liquid detergent in the compartment. This insert must be removed to use powder detergent in the compartment.

Starting a program

Using chlorine bleach

⚠ Damage due to chlorine bleach. Textiles may be discolored or their fibers damaged. Only use chlorine bleach on suitable textiles.

Chlorination must be activated in the settings before chlorine bleach is first used.

The *Pre-wash* option must not be selected.

- Pour max. 1/4 cup (60 ml) of bleach into the chamber.

The chlorine bleach is added automatically 10 minutes before the end of the main wash.

6. Start the program

- Touch the flashing *Start/Add laundry* sensor button.

Adding laundry during a program sequence

Laundry can be added or removed at any time, provided that the symbol is not illuminated in the display.

- Touch the *Start/Add laundry* sensor button.

The following appears in the display:
Please wait

- Wait until the following display lights up:
Door can be opened
- Open the door and add or remove laundry.
- Close the door.
- Touch the *Start/Add laundry* sensor button.

The wash program will continue.

7. Program end

The door is locked in the *Anti-crease* phase. The display alternates between: *End/Anti-Crease* and *Press Start* button

- Unlock the door either by touching the *Start/Add laundry* sensor button or by turning the program selector to the position.

The door will unlock.

Tip: After the *Anti-crease* phase, the door will unlock automatically.

- Take hold of the door and pull it open.
- Remove the laundry.

Items left in the drum could discolor other items in the next wash or become discolored themselves.

Remove all items from the drum.

- Check the folds in the door seal for any foreign objects.

Tip: Leave the door slightly open.

- If you used a capsule, remove it from the detergent drawer.

Tip: Leave the detergent drawer slightly open.

Options

Options

You can supplement the wash programs with options.

SoftSteam

In order to reduce creasing, the laundry undergoes a smoothing process at the end of the program. Reducing the maximum load by 50% will give a better result. Please note the load information in the display. Small loads achieve a better result.

ExtraRinse

An extra rinse can be activated to achieve a more thorough wash result.

Soak

For heavily soiled and stained items with protein stains. A duration of between 30 minutes and 6 hours can be selected for the soak process. See "Settings" for more information. The factory default setting is 30 minutes.

AllergoWash

This option should be used where high standards of hygiene are required. Energy consumption is increased to lengthen temperature holding times and water consumption is increased to improve rinsing efficiency. The items must be suitable for drying in a tumble dryer and suitable for ironing.

Without SoftSteam

Full load → Half load
Half load → Small load
Small load → Very small load

The garments must be suitable for drying in a tumble dryer and suitable for ironing.

For laundry with large amounts of dirt, e.g., dust and sand.

Pre-wash and the use of bleach are not possible. The chlorine bleach is added too early.

Only liquid detergent may be added to the chamber of the detergent drawer. Powder detergent clogs up the chamber and water can escape from the detergent drawer.

Buzzer

A buzzer sounds at the end of the program. The buzzer sounds until the washing machine is switched off.

fold here

fold here

fold here

fold here

fold here

fold here

Program overview

Program	Temperature	Speed	Load
Normal Cotton, linen, and mixed-fiber fabrics made of both cotton and linen.	Hot +, Hot, Warm +, Warm, Cold	Max, ☺	Full load (17.6 lb/8 kg) Small load (6.6 lb/3 kg)
Delicates For delicate fabrics made from synthetic fibers.	Hot +, Hot, Warm +, Warm, Cold	Med, Slow, ☹	Full load (17.6 lb/8 kg) Small load (4.4 lb/2 kg)
Sanitize Cotton or linen fabrics with direct skin contact or for which special hygiene requirements apply.	Sanitize	Max, High, ☹	Full load (17.6 lb/8 kg) Small load (4.4 lb/2 kg)
Handwash For delicate fabrics which are only suitable for hand washing.	Hot, Warm +, Cold	High, Med, Slow, ☹	Small load (4.4 lb/2 kg)
Dress Shirts Pre-treat collars and cuffs depending on the level of soiling.	Hot +, Hot, Warm +, Warm, Cold	Med, Slow, ☹	Small load (4.4 lb/2 kg)
Darks/Denims Black and dark garments made from cotton, mixed fibers, and denim.	Warm +, Warm, Cold	High, Med, Slow, ☹	Small load (4.4 lb/2 kg)
MobileStart The Miele app is used to select programs and operate the appliance.	Warm +, Warm, Cold	High, Med, Slow, ☹	Half load (7.7 lb/3.5 kg)
Extra White For white fabrics made of cotton or linen without special hygiene requirements.	Hot +	Max, High, ☹	Full load (17.6 lb/8 kg)
Proofing Performance outerwear (e.g., jackets and pants) made from membrane fabric such as Gore-Tex®, SYMPATEX®, WINDSTOPPER®, etc.	Warm +, Warm, Cold	Med, Slow, ☹	Small load (5.5 lb/2.5 kg)
Table Linens/Drapes Treating microfibre fabric, ski wear, or table linens/drapes made from mainly synthetic fibers to provide a finish which is resistant to water and dirt.	Hot +, Hot, Warm +, Warm, Cold	High, Med, Slow, ☹	Small load (5.5 lb/2.5 kg) Full load (13.2 lb/6 kg)
Sportswear Sportsweat such as jerseys and leggings, as well as microfibre and fleece garments.	Hot +, Hot, Warm +, Warm, Cold	High, Med, Slow, ☹	Half load (6.6 lb/3 kg) Small load (4.4 lb/2 kg)
Woolens Wool or wool-blend fabrics.	Warm, Cold	High, Med, Slow, ☹	Small load (4.4 lb/2 kg)
Silks Silks and other hand-washable fabrics with no wool content. Place tights, bras, etc., in a laundry bag.	Warm, Cold	Slow, ☹	Very small load (2.2 lb/1 kg)
Wrinkle-free Synthetic or mixed-fiber fabrics, or wrinkle-free cotton.	Hot +, Hot, Warm +, Warm, Cold	High, Med, Slow, ☹	Half load (8.8 lb/4 kg)
Baby Clothes Baby clothes, baby towels, bath gowns, towelings items, bibs made from cotton.	Hot +, Hot, Warm +, Warm, Cold	Max, High, Med, Slow, ☹	Full load (13.2 lb/6 kg) Full load (11 lb/5 kg)
Towels For linen or cotton towels used for personal hygiene.	Hot +, Hot, Warm +, Warm, Cold	Max, High, Med, Slow, ☹	Full load (11 lb/5 kg)
Downs Jackets, sleeping bags, pillows, and other down-filled items.	Hot +, Hot, Warm +, Warm, Cold	High, Med, Slow, ☹	Small load (4.4 lb/2 kg)
Pillows Washable pillows with synthetic filling.	Hot +, Hot, Warm +, Warm, Cold	High, Med, Slow, ☹	2 pillows (40 x 80 cm) or 1 pillow (80 x 80 cm)
Clean Machine With frequent washing at low temperatures there is a danger of a build-up of bacteria in the washing machine. Cleaning the washing machine will significantly reduce bacteria and prevent the build-up of unpleasant odors.	Sanitize	Slow	Without load

fold here

Detergent

Detergents recommended by Miele	Miele		Miele Capsules	
	UltraPhase 1 and 2			
Normal	✓	-	✓	✓
Delicates	✓	✓	✓	-
Sanitize	✓	-	✓	✓
Handwash	-	✓	✓	-
Dress Shirts	✓	-	✓	✓
Darks/Denims	✓	-	✓	-
Express	✓	-	✓	-
Extra White	✓	-	✓	✓
Outdoor	-	✓	-	-
Proofing	-	-	✓	-
Table Linens/Drapes	✓	-	✓	✓
Sportswear	-	✓	-	-
Woolens	-	✓	-	-
Silks	-	✓	-	-
Wrinkle-free	✓	-	✓	✓
Quick Rinse	-	-	✓	-
Baby Clothes	✓	-	✓	✓
Towels	✓	-	✓	✓
Downs	-	✓	-	-
Pillows	✓	-	-	-

PROGRAM OVERVIEW

fold here

Cleaning and care

Cleaning the detergent drawer

Washing at low temperatures and the use of liquid detergent can lead to a build-up of bacteria in the detergent drawer.

- Clean the entire drawer at regular intervals for hygiene reasons, even if you are using the TwinDos system exclusively.

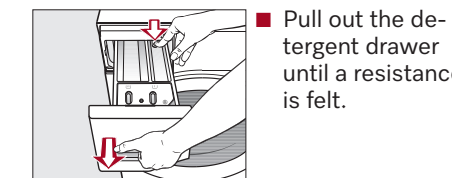

- Pull out the detergent drawer until a resistance is felt.

Removing and cleaning the insert for liquid detergents

An insert for liquid detergents is located in the compartment of the detergent drawer.

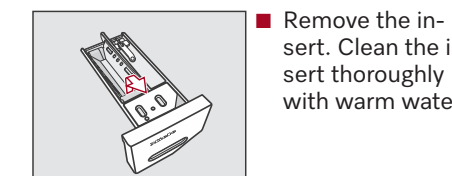

- Remove the insert. Clean the insert thoroughly with warm water.

Cleaning the siphon inside the compartment

Compartment 1 has a siphon for better dispensing of the chlorine bleach.

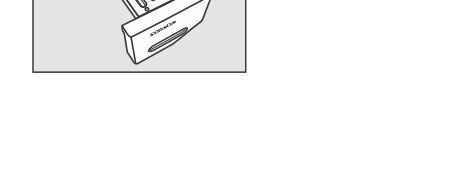

- Remove the release catch.

fold here

Cleaning the siphon inside the compartment

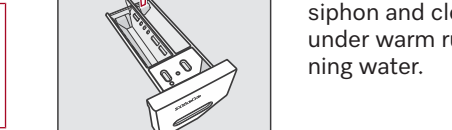

- Remove the siphon and clean under warm running water.

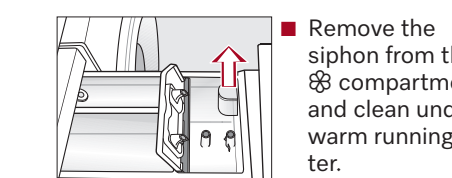

- Remove the siphon from the compartment and clean under warm running water.

Cleaning the detergent-drawer housing

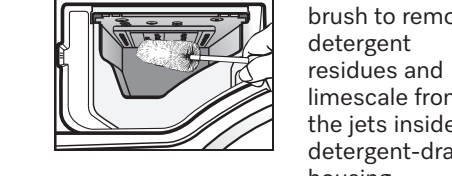

- Use a bottle brush to remove detergent residues and limescale from the jets inside the detergent-drawer housing.

Sanitize info (cleaning the drum)

Washing at low temperatures and/or using liquid detergents can cause bacteria and odors to build up in the washing machine. Use the *Clean Machine* program to clean the washing machine. Note the message in the display: Sanitize info: Run a high temp. program or the "Clean Machine" program



- Replace the detergent drawer.

fold here

Frequently asked questions ...

Problem	Possible cause and solution
The control field remains dark.	<ul style="list-style-type: none"> There is no power to the machine. ■ Check whether the plug is plugged in. ■ Check whether the fuse has tripped. <p>The washing machine has switched off automatically to save energy.</p> <ul style="list-style-type: none"> ■ Switch the washing machine on again by turning the program selector.
The following appears in the display: ⚠ Service Door lock fault F34	<p>The door is not closed properly. The door lock could not engage.</p> <ul style="list-style-type: none"> ■ Close the door again. ■ Start the program again. <p>If the fault message appears again, contact Miele Customer Service.</p>
⚠ Drainage See	<p>The drain is blocked or restricted. The drain hose has been fixed too high.</p> <ul style="list-style-type: none"> ■ Clean the drain filter and the drain pump. ■ The maximum drain height is 39 3/8" (1 m).
⚠ Water intake See	<p>The water intake is blocked or restricted.</p> <ul style="list-style-type: none"> ■ Check whether the faucet is turned on properly. ■ Check whether the intake hose is kinked. ■ Check whether there is sufficient water pressure. <p>The filter in the water intake is blocked.</p> <ul style="list-style-type: none"> ■ Clean the filter.
⚠ Waterproof system Turn off Service	<p>The water protection system has reacted.</p> <ul style="list-style-type: none"> ■ Close the faucet. ■ Contact Customer Service.
⚠ Service Fault F	<p>There is a fault.</p> <ul style="list-style-type: none"> ■ Disconnect the washing machine from the power supply. Unplug the appliance or switch off the breaker. ■ Wait at least 2 minutes before reconnecting the washing machine to the power supply. ■ Switch the washing machine on again. ■ Restart the program. <p>If the fault message appears again, contact Miele Customer Service.</p>

CLEANING AND CARE

fold here

Problem	Possible cause and solution
ⓘ Check dosage	<p>Excessive foam has built up during washing.</p> <ul style="list-style-type: none"> ■ With TwinDos, check the dosage amount set. ■ Reduce the amount set in 10% increments. ■ Use less detergent next time and follow the manufacturer's instructions on dosage given on the packaging.
ⓘ Sanitize info: Run a high temp. program or the "Clean Machine" program	<p>When washing, a wash program using a temperature above 60°C (140°F) has not been run for a long time.</p> <ul style="list-style-type: none"> ■ Turn the program selector to the <i>Additional programs/</i> setting and select the <i>Clean Machine</i> program in the Care submenu. ■ Run the <i>Clean Machine</i> program using the Miele Machine Cleaner or a universal powder detergent. <p>The washing machine is cleaned which prevents bacteria and odor buildup.</p>
ⓘ Align the washing machine	<p>The <i>SoftSteam</i> extra option which runs at the end of the program could not be carried out properly.</p> <ul style="list-style-type: none"> ■ Check whether the washing machine is aligned correctly (see "Installation - Leveling the machine"). ■ Check whether the maximum drain height of 39 3/8" (1 m) has been exceeded. <p>If the fault message appears again, contact Miele Customer Service. The washing machine can still be used, but without the <i>SoftSteam</i> extra option.</p>
ⓘ is almost empty. Only a few more cycles are possible	<p>The detergent in the cartridge is running low. There is enough left for approx. 4 to 8 wash programs.</p> <ul style="list-style-type: none"> ■ Order a new cartridge.
The following appears in the display: ⚠ Service Door release fault F35	<p>The door lock has jammed.</p> <ul style="list-style-type: none"> ■ Contact Customer Service.

fold here



Quick Start Guide

Washing machine



This Quick Start Guide is not a substitute for the operating instructions supplied with the appliance! It is essential to familiarize yourself with the washing machine before using it for the first time. Please read the operating instructions carefully and pay particular attention to the IMPORTANT SAFETY INSTRUCTIONS.

en-US

M.-Nr. 11 622 870 / 02

fold here