

## Cleaning and care

### Cleaning the central spout

Clean the central spout stainless steel cover **by hand** only.

- Open the appliance door.

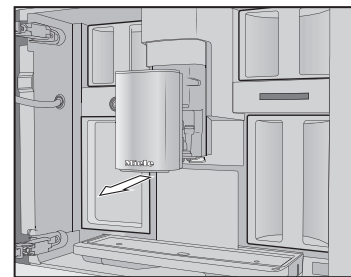

- Remove the central spout stainless steel cover and clean it.

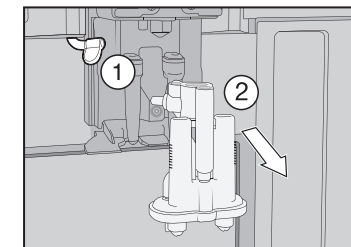

- Detach the milk pipework from the dispensing unit ①. Pull the dispensing unit down to remove it ②.

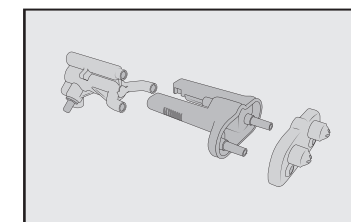

- Disassemble the dispensing unit into 3 parts.
- Clean all parts thoroughly. Clean the surfaces of the central spout with a damp cloth.
- Reassemble the dispensing unit.

- Push the dispensing unit back into the central spout and replace the stainless steel cover.
- Confirm the message with **OK**.

### Removing the brew unit and cleaning by hand

Clean the brew unit **by hand** only under warm running water. **Do not use washing-up liquid or any other cleaning agent.**

- Open the appliance door and remove the water container.

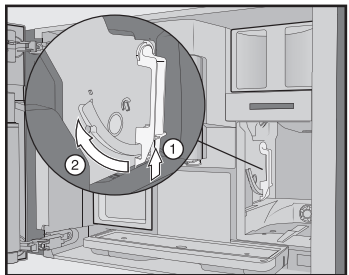

- Press the button under the handle of the brew unit ① and, whilst doing so, turn the handle forwards ②.

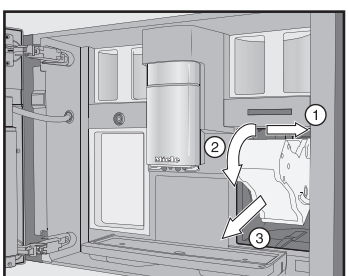

- Pull the brew unit sideways ① and then tilt it forwards ②. Pull the brew unit forwards to remove it ③.

When you have removed the brew unit, do not change the position of the handle on the brew unit.

- Clean the brew unit **by hand** under warm running water.

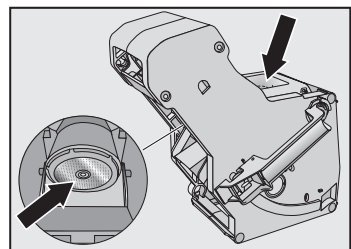

- Wipe any remaining coffee off the filters (see arrows).
- Dry the funnel in the brew unit.
- Carefully clean the inside of the coffee machine.
- Push the brew unit back into the coffee machine.
- Lock the brew unit. Press and hold the button under the brew unit handle and, whilst doing so, turn the handle to the right.
- Close the appliance door.
- Follow the further instructions given in the display.

The process is complete when rinsing has finished.

### Descaling the appliance

You will need **2** descaling tablets for the descaling programme.

The message *Descalc the appliance* appears in the display.

- Touch **OK**.
- Follow the instructions in the display.

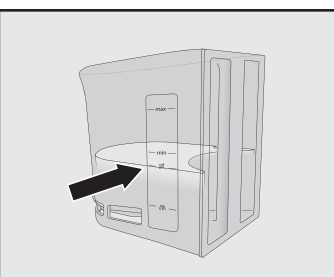

- Fill the water container to the  $\text{S}$  symbol with lukewarm water.
- Drop **2** descaling tablets in the water.
- Push the water container back into the machine.
- Follow the further instructions given in the display.

When Rinse the water container and fill with fresh water to the descaling symbol  $\text{S}$  appears in the display:

- Remove the water container and rinse it thoroughly with clean water. Fill the water container to the  $\text{S}$  symbol with fresh tap water.

The descaling process is complete at the end of the rinsing process.

## Drinks overview

### Coffee drinks

- **Ristretto** is a strong, concentrated espresso. It is prepared with the same amount of coffee as for an espresso but with a lot less water.
- **Espresso** is a strong aromatic coffee with a thick hazelnut brown coloured froth - known as the crema - on top.
- **Coffee** differs from espresso by the increased amount of water and the roast of the beans.
- **Long coffee** is a coffee with considerably more water.
- **Long black** is made with hot water and two shots of espresso.
- **Caffè Americano** consists of equal proportions of espresso and hot water. The espresso is made first, then the hot water is dispensed.

### Coffee drinks made with milk

- **Cappuccino** consists of approx. 2/3 milk froth and 1/3 espresso.
- **Latte macchiato** consists of 1/3 each of hot milk, milk froth and espresso.
- **Caffè latte** consists of hot milk and espresso.
- **Cappuccino Italiano** has the same proportions of milk froth and espresso as a cappuccino. The difference is that the espresso is added first and then the milk froth.
- **Espresso macchiato** is an espresso with a small amount of milk froth on top.
- **Flat white** is a special variation of the cappuccino: a much greater amount of espresso compared to milk froth creates an intensive coffee aroma.
- **Café au lait** is a French coffee speciality made from coffee and milk froth. Café au lait is normally served in a bowl.

### Tea drinks

(hot water at the optimum temperature)

- White tea
- Japanese tea
- Green tea
- Herbal tea
- Fruit tea
- Black tea
- **Chai Latte** is a tea speciality with milk.

### Other drinks

- Hot milk
- Milk froth
- Hot water
- Warm water

### Pot function

- (3 to 8 cups can be selected)
- Coffee pot
- Teapot for all types of tea

## Coffee the way you like it

### Displaying and changing parameters

You can change the portion size for all drinks.

For coffee drinks, you can also set the amount of coffee, the brewing temperature and pre-brewing for each drink individually.

- Touch the  $\text{C}$  sensor.
- Select a drink and confirm with **OK**.
- Touch Drink parameters.

The parameters that you can change for this drink will be displayed.

The Portion size menu option is displayed in the first line. If you select Portion size and confirm with **OK**, the drink will be dispensed immediately.

- Select the parameter you want and change the setting as required.
- Confirm with **OK**.

### Portion size

You can adjust the amount dispensed for all coffee drinks, hot and warm water, all teas and milk preparations.

- Place a cup or glass under the central spout.
- Select Portion size and confirm with **OK**.
- When the cup is filled to the level you want, touch **OK**.

If you want to change the portion size for coffee drinks made with milk or hot water, the ingredients (components) which make up the drink will be saved one after the other while the drink is being made.

### Performance mode

You can select the appropriate mode to suit your personal preferences under Settings  $\text{P}$  | Performance mode. The energy consumption varies depending on the selected mode.

- **Eco mode:** This is an energy-saving mode.
- **Barista mode:** This mode is optimised for espresso and coffee drinks.
- **Latte mode:** In this mode, drinks with milk can be prepared significantly faster.

In addition, you can activate **Party mode** for the occasional intensive use of the coffee machine, e.g. for family get-togethers (see the operating instructions).

## Settings

### Displaying and changing settings

- Touch the  $\text{P}$  sensor.
- Select Settings  $\text{P}$  and touch **OK**.
- Select the option you want to display or change. Touch **OK**.
- Change the setting as required and confirm with **OK**.

Factory default settings are marked in *italics*.

### Language $\text{P}$

- German | ... other languages
- Country

### Time of day

- Display: On | Off | Night dimming
- Clock format: 24 h | 12 h (am/pm)
- Set

### Date

(Setting)

### Timer

- Timer 1: Switch on at | Switch off at
- Timer 2: Switch on at | Switch off at
- Switch off after (0:20)

### TeaTimer

- Automatic | Manual

### Volume

- Signal tones
- Keypad tones
- Welcome melody: On | Off

### Display

- Display brightness
- QuickTouch: On | Off

### Lighting

- Appliance switched on
- Appliance switched off: switch off after

You can also specify how long the lighting should stay on for when the appliance is switched off.

### Info

- Number of drinks (Total No. of drinks | Total coffees | ...)
- No. of uses until maintenance programme: Descalc the appliance | Degrease the brew unit

### Mains water (CVA 7445)

- On | Off

### Altitude

0–250 m, 251–500 m, ...

### Performance mode

- Eco mode | Barista mode | Latte mode | Party mode

Party mode is a Performance mode for the occasional intensive use of the coffee machine (see the operating instructions).

### Water hardness

- Overall hardness

Set to 21 °dH at the factory.

### System lock $\text{P}$

- On | Off

When the system lock is activated, the Switch on at option for the timer cannot be selected.

### Miele@home

- Set up | Deactivate/Activate | Connection status | New setup

## Miele

## Quick Start Guide Coffee machine



These short instructions are **not** a substitute for the operating instructions supplied with the machine. It is essential to familiarise yourself with the coffee machine before using it for the first time. Please read the operating instruction manual carefully and pay particular attention to the Warning and Safety instructions.

Operation

Controls and indicators

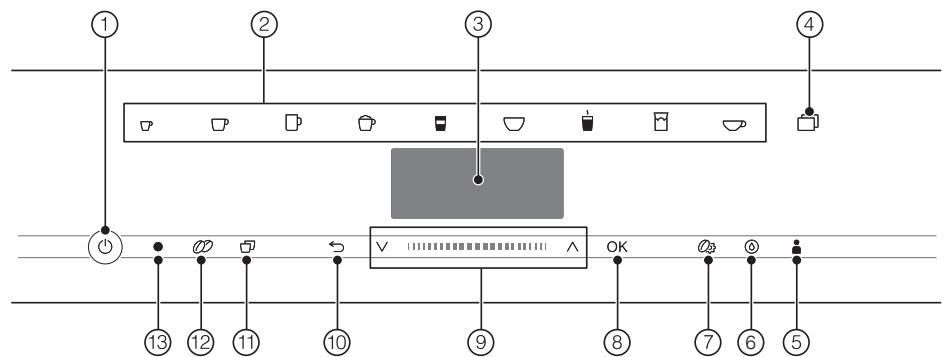

- 1 On/Off 1 sensor
- 2 Drink sensors
- 3 Display
- 4 sensor
- 5 Profile sensor
- 6 Maintenance sensor
- 7 Parameters sensor
- 8 OK sensor
- 9 Navigation area with arrow sensors
- 10 "Back" sensor
- 11 2 portions sensor
- 12 DoubleShot sensor
- 13 Optical interface (for Miele service technicians only)

Drink sensor symbols

- Espresso
- Coffee
- Long coffee
- Cappuccino
- Latte macchiato
- Cafè latte
- Hot milk
- Milk froth
- Tea water

Operating principles

To operate the coffee machine, touch the sensors with your finger.

Drinks menu

You are in the drinks menu when Select drink appears in the display.



You can find more drinks in the Other menu (sensor).

Navigation area

To select a menu option, keep pressing the arrow sensors V^ until the option you want is highlighted.

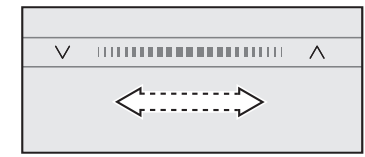

To scroll faster, swipe left or right in the area between the arrows.

The OK sensor lights up orange as soon as a value, setting or prompt can be confirmed.

Touch OK to confirm your selection.

Selecting a menu and navigating within a menu

To select a menu, touch the relevant sensor, e.g. the sensor.



Entering a name

Letters and numbers are entered via the navigation area. You can select both upper and lower case letters.

Tip: It is best to select short, memorable names.

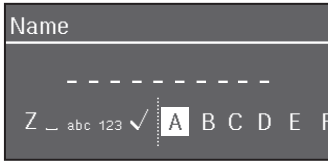

- To enter a character, highlight a character and confirm the selection with OK.
- To delete a character, touch the sensor.
- To save the name, select the tick checkmark and confirm with OK.

Description

Exterior view

- 1 On/Off 1 sensor
- 2 Control panel
- 3 Door handle
- 4 Automatic height-adjustable central spout with lighting
- 5 Drip tray cover
- 6 Milk flask

Interior view

- 1 Bean container
- 2 Milk valve
- 3 Automatic height-adjustable central spout with lighting
- 4 Grinder setting
- 5 Bean container
- 6 Fan outlet
- 7 Water container
- 8 Drip tray with lid
- 9 Brew unit
- 10 Waste container
- 11 Maintenance container
- 12 Drip catcher

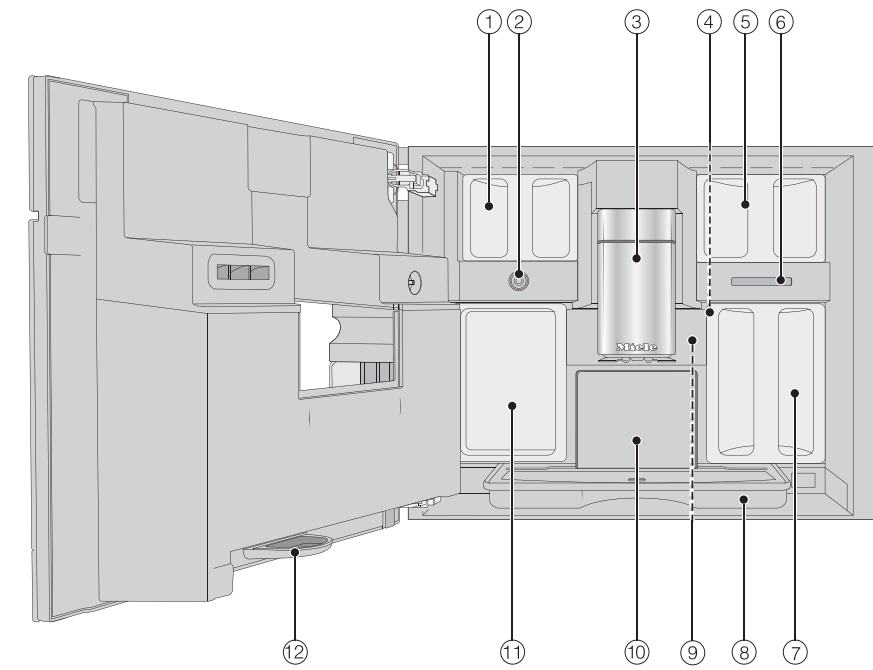
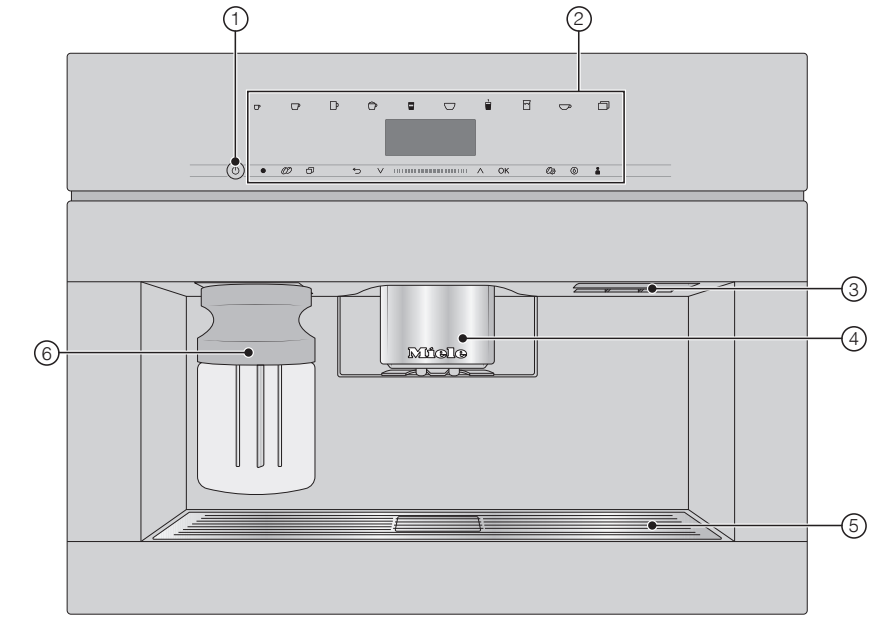

Preparing for use

Filling the water container

- Open the appliance door.

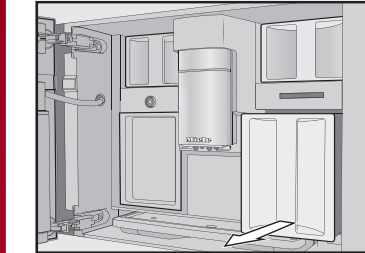

- Pull the water container out to remove it.
- Fill the water container with cold, fresh tap water up to the "max." mark.
- Push the water container back into the coffee machine and close the appliance door.

Filling the bean containers

Only put roasted coffee beans in the bean containers.

- Open the appliance door.

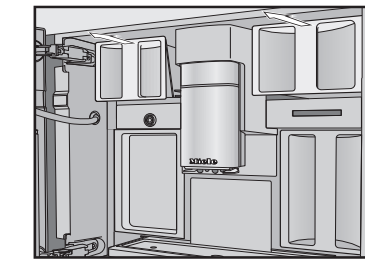

- Pull out the coffee bean containers and remove their lids.
- Fill the bean containers with coffee beans and put the lids back on the bean containers to seal them.
- Push the bean containers back into the coffee machine.
- Close the appliance door.

Making drinks

Making a drink

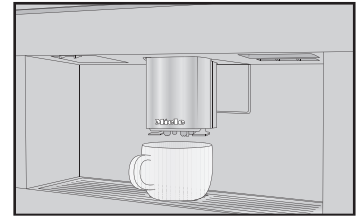

- Place a cup or glass under the central spout.
- Touch the sensor for the drink you want.

Cancelling preparation

- Touch the control panel symbol illuminated in orange again.

If you are making drinks with more than one component, e.g. latte macchiato, you can cancel the preparation of each component early.

- Touch OK when Stop appears in the display.

DoubleShot

Select the DoubleShot function if you would like a particularly strong and aromatic coffee. In this case, more coffee beans will be ground and brewed halfway through brewing.

- Touch the sensor whilst making your coffee.

Making two portions (sensor)

To fill two cups at the same time:

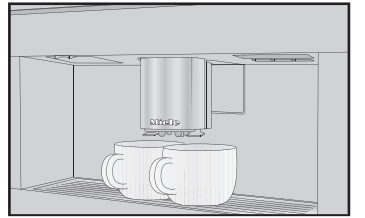

- Place one cup under each of the coffee spouts.
- Touch the sensor whilst making your drink.

Using the milk flask

Milk is not cooled in the milk flask. Therefore, place the milk flask in the refrigerator if you are not going to use milk for a while. Good milk froth can only be made with cold milk (< 10 °C).

- Fill the milk flask with milk up to a maximum of 2 cm below the rim.

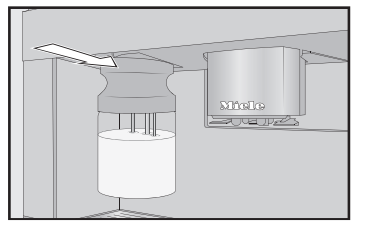

- Push the milk flask into the coffee machine until it clicks into place. You can now make drinks with milk.

Making tea

Hot water is heated to the optimum temperature for different types of tea.

If you touch the sensor, the menu with the different types of tea is displayed.

- Place the tea filter or the tea bag in the tea cup.
- Place the tea cup under the central spout.

- Select the type of tea you want and confirm your choice with OK.

Hot water will be dispensed into the cup.

- Remove the tea filter or tea bag when the desired brewing time has elapsed.

Tip: You can use the TeaTimer function to start a minute minder when making tea (see the operating instructions).

Pot function

You can make several cups of coffee or tea one after the other automatically with the Pot function (maximum of 1 litre). Up to 8 cups can be made in this way.

Preparing the pot

The drinks menu is displayed.

- Place a sufficiently large container under the central spout.

- Select the required pot function:
  - Coffee pot: Touch the sensor and select Coffee pot. Confirm with OK.
  - Teapot: Touch the drinks sensor and select Teapot.

- Select the number of portions you want to dispense (3 to 8).

- Follow the instructions in the display.

Expert mode

The Expert mode function allows you to change the portion size while the drink is being made (Settings | Expert mode).

The setting will not be saved and will only apply for the current drink.

The Expert mode function is switched off as the factory default setting.

Changing the portion size

The portion size can only be changed when the respective ingredient is being processed while the drink is being made.

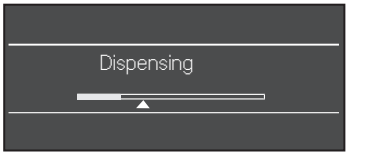

- While the drink is being made: move the indicator (small triangle) across the navigation area to the desired position.

Cleaning and care

Please observe the detailed information on cleaning and care in the operating instructions. Carefully clean the coffee machine regularly.

Recommended cleaning interval	What do I have to clean / maintain?
Every day (at the end of the day)	<ul style="list-style-type: none"><li>Milk flask and lid</li><li>Milk valve</li><li>Water container</li><li>Drip tray cover</li><li>Drip tray and waste container</li></ul>
Once a week (more often if heavily soiled)	<ul style="list-style-type: none"><li>Central spout</li><li>Cup rim sensor</li><li>Interior</li><li>Brew unit</li><li>Drip catcher</li><li>Appliance front</li></ul>
Once a month	<ul style="list-style-type: none"><li>Bean containers</li></ul>
As required / When prompted by display	<ul style="list-style-type: none"><li>Milk pipework</li><li>Degrease the brew unit</li><li>Descale the appliance</li></ul>

Clean by hand or in the dishwasher

Clean the following by hand only:

- Central spout stainless steel cover
- Brew unit
- Coffee bean containers and lids

The following parts are dishwasher safe:

- Drip tray with lid and waste container
- Drip tray cover
- Central spout (without stainless steel cover)
- Milk flask and lid
- Cup rim sensor
- Drip catcher
- Maintenance container
- Water container

MAKING DRINKS