

Programme chart

Programme	Load (in kg)	Temperature	Items	Extra
ECO 40-60 ^{1,2}	8.0	Cold to 90°C	For normally soiled cotton garments. A laundry load consisting of mixed cottons that are intended for washing at 40°C or 60°C can be washed in the same wash cycle. This programme is the most efficient in terms of energy and water consumption for washing cottons. Cottons, linens or cotton mix fabrics, e.g. table linen, towelling, underwear, T-shirts etc.	(A), (B)
Cottons	8.0	Cold to 90°C	Where particularly high levels of hygiene are required, please select a temperature of 60°C or higher. If you want to select a pre-wash, turn the programme selector to the Pre-wash position. With pre-wash. Synthetic and mixed fibre textiles and easy care cotton.	(A), (B)
Minimum iron	3.5	Cold to 40°C	Delicate garments made from synthetic fibre, mixed fibre, rayon and viscose.	(A), (B)
Delicates	2.0	Cold to 40°C	Performance outerwear (e.g. jackets and trousers) made from membrane fabric such as Gore-Tex®, SYMPATEX®, WINDSTOPPER®, etc. Curtains specified as machine-washable by the manufacturer. Machine-washable or hand-washable wool or wool blend fabric. If the care label does not specify a temperature, wash using the cold setting. The Miele App is used for selecting programmes and operating the machine.	(A), (B)
Woolens	2.0	Cold to 40°C	Cotton garments that have hardly been worn or are only very lightly soiled.	(A)
MobileStart	3.5	Cold to 60°C	Black and dark garments made from cotton, mixed fibres and denim.	(A), (B)
Express 20	3.0	Cold to 60°C	Shirts and blouses made of cotton and mixed fibre. Wash silk shirts and blouses in the Delicates programme.	(A), (B)
Dark garments/Denim	1.0/2.0	Cold to 60°C	If the preset Pre-ironing option is switched off, the maximum load capacity is increased to 2.0 kg.	(A), (B)
Shirts	2.5	40°C	For treating microfibre fabric, skiwear and table linen made from mainly synthetic fibres to provide a water and dirt resistant finish.	(A), (B)
Proofing	-	-	Drain only: Select for the spin speed.	(A), (B)
Drain/Spin	-	-		(A), (B)

← fold here

¹ Information for customers:
You cannot normally select any temperatures or Extras for the ECO 40-60 wash programme.

² Note for test institutes and customers:
For energy labelling programme according to AS/NZS 2040.1 & AS/NZS 2040.2 change the following settings:
Temperatures 60 and 40 light up in the temperature display.

Touch the 40 sensor for the Cottons test programme. Temperature 40 lights up brightly.

(A) = Short; (B) = Pre-ironing

PROGRAMME CHART

← fold here

Detergent

	Miele recommended detergents		Miele capsules	
	UltraPhase 1 and 2			
ECO 40-60	✓	-	✓	✓
Cottons	✓	-	✓	✓
Minimum iron	✓	-	✓	✓
Delicates	✓	✓	✓	-
Woolens	-	✓	-	-
Express 20	✓	-	✓	-
Dark garments/Denim	✓	✓	✓	-
Shirts	✓	-	✓	✓

✓ Recommended
 - Not recommended

Specialist detergents (e.g. WoolCare)
 Fabric care (e.g. fabric softener)
 Additive (e.g. booster)

← fold here

Cleaning and care

Cleaning the detergent dispenser drawer

Washing at low temperatures and the use of liquid detergent can lead to a build-up of mould and bacteria in the detergent dispenser drawer.

- For hygiene reasons, clean the entire drawer at regular intervals.

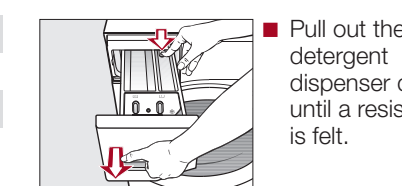

- Pull out the detergent dispenser drawer until a resistance is felt.

- Press down the release button and, at the same time, pull the drawer right out of the machine.
- Clean the detergent drawer with warm water.

Cleaning the siphon tube and the fabric softener channel

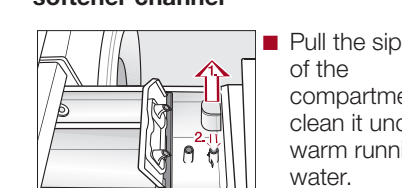

- Pull the siphon out of the compartment and clean it under warm running water.

- Clean the siphon tube in the same way.
- Refit the siphon.



- Clean the fabric softener channel using a brush and warm water.

Liquid starch results in clogging. If clogged, the siphon in the compartment will not work and the compartment can overflow.
Clean the siphon particularly thoroughly after using liquid starch a few times.

Cleaning the detergent dispenser drawer housing

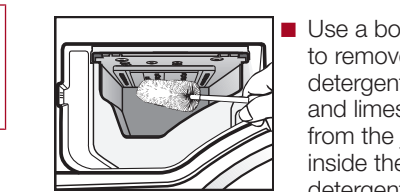

- Use a bottle brush to remove detergent residues and limescale from the jets inside the detergent dispenser drawer housing.

- Replace the detergent dispenser drawer slightly open to allow it to dry.

Cleaning the drum (Hygiene info)

Washing at low temperatures and/or using liquid detergent can cause bacteria and unpleasant odours to build up in the washing machine. Use the *Cottons* 90°C programme to clean the washing machine. Clean the drum no later than the point at which the **i** indicator light and **!** light up in the time display.

TwinDos maintenance

Damage resulting from dried laundry detergent.

If the system has not been used for a long time (more than two months), detergent in the hoses can become viscous or dry out. The hoses can become blocked and would then need to be cleaned by a service technician.
Clean the TwinDos system.

To clean the system, you need a "TwinDosCare" cleaning cartridge. These are available from shop.miele.com

CLEANING AND CARE

← fold here

Problem solving guide

With the help of the following guide, minor faults in the performance of the appliance, some of which may result from incorrect operation, can be remedied without contacting Miele. This will save you time and money because you won't need a service call.

Problem	Possible cause and remedy
The control panel remains dark.	<ul style="list-style-type: none"> There is no power to the machine. Check whether the mains plug is plugged in and switched on. Check whether the circuit breaker has tripped. <p>The washing machine has switched off automatically to save energy.</p> <ul style="list-style-type: none"> Switch the washing machine back on by turning the programme selector.
F and 34 alternate in the time display.	<ul style="list-style-type: none"> The door is not closed properly. The door lock could not engage. Close the door again. Start the programme again. <p>If the fault message appears again, contact Miele.</p>
The fault indicator light lights up. F and ! alternate in the time display and the buzzer sounds.	<ul style="list-style-type: none"> The water outlet is blocked or restricted. The drain hose has been fixed too high. Clean the filter and the drain pump (see the operating instructions). The maximum drain height is 1 m.
The fault indicator light lights up. F and ! alternate in the time display and the buzzer sounds.	<ul style="list-style-type: none"> The water inlet is blocked or restricted. Check whether the tap is turned on properly. Check whether the inlet hose is kinked. Check whether there is sufficient water pressure.
The fault indicator light lights up. F and ! alternate in the time display and the buzzer sounds.	<ul style="list-style-type: none"> The filter in the water inlet is blocked. Clean the filter (see the operating instructions).
The fault indicator light lights up. F and ! alternate in the time display and the buzzer sounds.	<ul style="list-style-type: none"> The water protection system has reacted. Turn off the tap. Call Miele.
F and XXX alternate in the time display and the buzzer sounds.	<ul style="list-style-type: none"> There is a fault. Disconnect the washing machine from the electricity supply, either by switching it off at the wall socket and withdrawing the plug, or by disconnecting it at the circuit breaker. Wait at least 2 minutes before reconnecting the washing machine to the electricity supply. Then switch the washing machine back on. Restart the programme. <p>If the fault message appears again, contact Miele.</p>

← fold here

Problem solving guide

Problem	Possible cause and remedy
-0- lights up in the time display.	<ul style="list-style-type: none"> The programme selector was moved to a different position after the programme had started. Turn the programme selector back to the original position.
The indicator light lights up.	<ul style="list-style-type: none"> Excessive foam has built up during washing. Use less detergent next time and follow the manufacturer's instructions on dosage given on the packaging.
The i indicator light lights up and ! appears in the time display.	<ul style="list-style-type: none"> A programme using a temperature above 60°C has not been run for a long period of time. Run the <i>Cottons</i> 90°C programme using the Miele IntenseClean machine cleaner or a universal powder detergent. <p>This will clean the washing machine and prevent a build-up of bacteria and odours.</p>
The i indicator light lights up and 2 appears in the time display.	<ul style="list-style-type: none"> TwinDos has not been used for a long time. It is possible that detergent has dried inside the hoses. Immediately carry out the TwinDos maintenance programme as described in "Cleaning and care – TwinDos maintenance".
The TwinDos Whites sensor flashes.	<ul style="list-style-type: none"> The UltraPhase 1 cartridge is empty. Replace the UltraPhase 1 cartridge while the washing machine is switched on.
The TwinDos Colours sensor flashes.	<ul style="list-style-type: none"> The UltraPhase 2 cartridge is empty. Replace the UltraPhase 2 cartridge while the washing machine is switched on.
F and 37 appear alternately in the time display.	<ul style="list-style-type: none"> The <i>Pre-ironing</i> Extra which runs at the end of the programme could not be carried out properly. Check that the washing machine is standing level. Check whether the maximum delivery head of 1 m has been exceeded. <p>If the fault message appears again, contact Miele. The washing machine can still be used, however without the <i>Pre-ironing</i> Extra.</p>
F and 35 alternate in the time display.	<ul style="list-style-type: none"> The door lock has jammed. Call Miele.

← fold here

Miele

Quick Start Guide

Washing machine



PROBLEM SOLVING GUIDE

← fold here

These short instructions are not a substitute for the operating instructions supplied with the appliance. It is essential to familiarise yourself with the washing machine before using it for the first time. Take note of the Warning and Safety instructions, as well as the full descriptions on how to use your appliance.

en-AU, NZ

M.-Nr. 11 625 480 / 01