

Applications

⚠ Before using the washer-dryer for the first time, ensure that it is correctly installed and connected. Install and connect the appliance as described in the operating instructions.

It is **essential** to read the separate operating instructions.

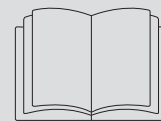

You can use this washer-dryer to:

- **wash separately**
with a maximum load of 8.0 kg,
- **dry separately**
with a maximum load of 4.0 kg,
- or
- **wash and dry in a continuous sequence**
with a maximum load of 4.0 kg.

Operation

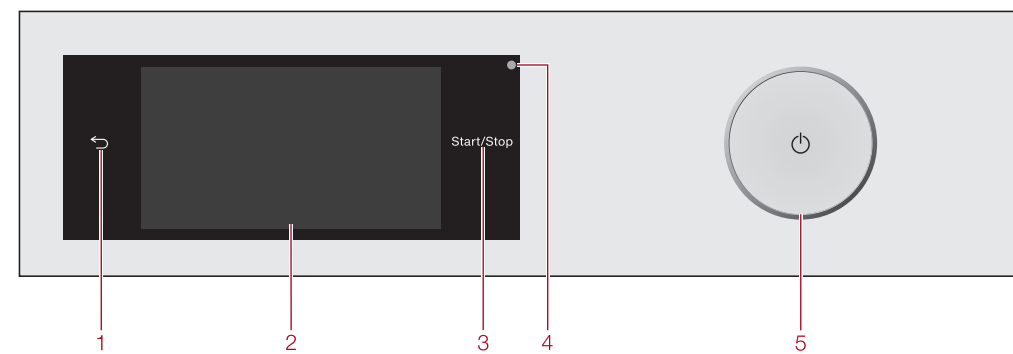

Touch display and sensors

The ↵ and Start/Stop sensors and the sensors in the display react to fingertip contact.

The touch display can be scratched by pointed or sharp objects, e.g. pens. Only touch the display with your fingers.

- 1 **↵ sensor**
Takes you back a level in a menu.
- 2 **Touch display**
- 3 **Start/Stop sensor**
Touching the Start/Stop sensor starts the selected programme or cancels a programme that has already started. The sensor flashes slowly as soon as it is possible for a programme to be started and then lights up constantly after the programme has started.
- 4 **Optical interface**
For service technicians.
- 5 **⏻ sensor**
For switching the washer-dryer on and off. The washer-dryer switches off automatically to save energy. It is switched off 15 minutes after the end of the programme/Anti-crease phase, or after being switched on if no further selection is made.

Main menu

After switching on the washer-dryer, the main menu will appear in the display.

You can access all important sub-menus from the main menu.

Touch the ⏻ sensor at any time to return to the main menu. Values that have not yet been confirmed with the OK sensor are not saved when you return to the main menu.

Washing

For selecting the wash programme.

Drying

For selecting the drying programme.

Washing + Drying

For selecting programmes which include a continuous washing and drying sequence.

☆ Favourite programmes

12 of your saved programmes.

📱 MobileStart

The washer-dryer can be operated remotely via the Miele@mobile App.

👤 Assistant

Guides you step by step so that you can select the optimum washing and drying programme.

⚙ Maintenance

Maintenance options for the TwinDos system and the *Clean machine* and *Rinse out fluff* programmes.

⚙ Settings

For altering the washer-dryer's electronics to suit changing requirements.

Operating the touch display

Scrolling through menus

You can scroll to the right or the left by swiping your finger across the screen. The orange bar under the pictures shows that there are further options to choose from.

Options

Touch an option in the menu to select it. If there are multiple options, the selected option will be highlighted in orange.

Pull-down menu

Touch the top edge of the screen in the middle and drag down with your finger.

Separate washing

1. Preparing the laundry

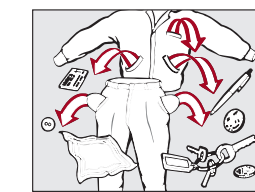

- Empty all pockets.

⚠ Foreign objects (e.g. nails, coins, paper clips etc.) can cause damage to fabrics and to components in the machine.

- Sort the laundry by colour and by care label. Most garments have a textile care label in the collar or side seam.
- Pre-treat stains and badly soiled areas (see "ABC of Stains" on the Miele website.).

2. Selecting a programme

Switching the washer-dryer on

- Press the ⏻ sensor.

Programme selection

- Touch the Washing sensor.
- Scroll to the right of the display until the programme you want appears.
- Touch the sensor for that programme. The display will then change to the standard menu for the programme. There are 3 other ways to select a programme:

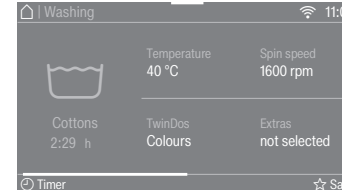

1. Favourite programmes
2. The Washing/Drying assistant
3. Miele MobileStart

3. Selecting programme settings

Selecting the temperature

- Touch the *Temperature* sensor and select the temperature you want.

Selecting the spin speed

- Touch the *Spin speed* sensor and select the spin speed you want.

Activating TwinDos

TwinDos dispensing is automatically activated for all programmes in which dispensing is possible.

- Switching TwinDos on or off
- Touch the *TwinDos* sensor, select *Off* or *On* and confirm with OK.

Selecting Extras

- Touch the *Extras* sensor and select one or more Extras.

Activating CapDosing

- Touch the *CapDosing* sensor and select the Cap you want to use.

Selecting stains

- Touch the *Stains* sensor and select the type of stains in your load from the list.

⌚ Timer

You can use the Timer to set the finish time or the start time for a programme.

- 1 **Detergent dispenser drawer**
- 2 **Control panel**
- 3 **Access to filters, pumps and emergency release**
- 4 **Door**
- 5 **Access panel for TwinDos containers**

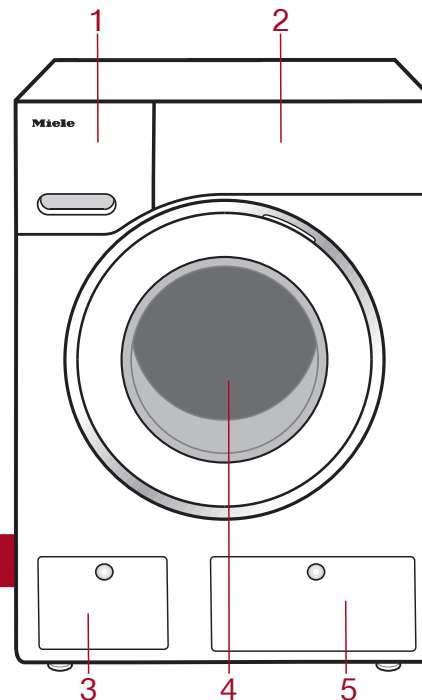

4. Loading the drum

Opening the door

- Reach under the door grip and pull the door open.
- Unfold the laundry and load loosely in the drum.
- Always observe the maximum recommended load for each programme.

Tip: The maximum load size for the programme selected will appear in the pull-down menu.

Closing the door

- Make sure that no items are caught between the door and the seal.
- Shut the door with a gentle swing.

5. Adding detergent

Detergent can be dispensed via TwinDos, the detergent dispenser drawer or CapDosing.

TwinDos

The optimum amount of UltraPhase 1 and UltraPhase 2 will be dispensed automatically according to the colour mix of the load.

- Touch the *TwinDos* sensor in the standard menu of the programme.

Detergent dispenser drawer

- Pull out the detergent drawer and add detergent to the compartments or .

CapDosing

There are different types of capsules available. Each capsule contains the correct amount of detergent for one wash cycle.

- Touch the Cap sensor in the standard menu of the programme, select the type of capsule and place a capsule in the compartment.

Separate drying

6. Starting the programme

- Touch the slowly flashing *Start/Stop* sensor. The door will lock and the programme will start. The programme status will appear in the display.

7. At the end of the programme

The door remains locked during the Anti-crease phase.

- Touch the *Start/Stop* sensor.
- Pull open the door.
- Remove the laundry.

⚠ Check that all items have been removed from the drum.

2. Selecting a programme

Switching the washer-dryer on

- Press the ⏻ sensor.

Selecting a programme

- Touch the *Drying* sensor.
- Scroll to the right of the display until the programme you want appears.
- Touch the sensor for that programme. The display will then change to the standard menu for the programme.

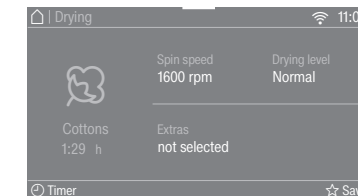

There are 3 other ways to select a programme:

1. Favourite programmes
2. The Washing/Drying assistant
3. Miele MobileStart

3. Selecting programme settings

- Touch the *Spin speed* sensor.
- Select the desired spin speed.

Selecting the drying level

- Touch the *Drying level* sensor.
- Select the desired drying level.

Selecting Extras

- Touch the *Extras* sensor.
- Select one or more Extras.
- Confirm with the OK sensor.

Timer

You can use the Timer to set the finish time or the start time for a programme.

4. Loading the drum

Opening the door

- Reach under the door grip and pull the door open.
- Load the laundry loosely in the drum.

Do not overload the drum. Overloading can cause unnecessary wear and tear of the laundry, give a disappointing drying result and cause more creasing.

- Remove foreign objects like detergent dispensing devices from the laundry.

⚠ They can melt and damage the dryer and the laundry.

Closing the door

- Shut the door with a gentle swing.

- Make sure that no items are caught between the door and the seal. Tip: The maximum load size for the programme selected will appear in the pull-down menu.

5. Starting the programme

- Touch the slowly flashing *Start/Stop* sensor. The door will lock and the drying programme will start. The programme status will appear in the display.

The mains water tap must be kept open for drying.

6. At the end of the programme

The door remains locked during the Anti-crease phase.

- Touch the *Start/Stop* sensor. The door will unlock.

If you have unloaded the drum during the Anti-crease phase, make sure you spread out the laundry to cool it down.

- Pull open the door.
- Remove the laundry.

See the section "After each washing or drying programme" under "Washing and drying in one continuous sequence".

- Switch the washer-dryer off.

Changing the programme sequence

Cancelling a programme

You can cancel a programme at any time after it has started.

- Touch the *Start/Stop* sensor. The following will appear in the display: Cancel the programme?
- Select Yes.

The suds will be drained away or the laundry will be cooled down before the door can be opened.

Removing the laundry

- Wait until the symbol in the display goes out and the door is unlocked.
- Pull the door open and unload the drum.

Selecting another programme

- Close the door.
- Select the required programme.
- Press the *Start/Stop* sensor.

Interrupting a programme

- Switch the washer-dryer off with the ⏻ sensor.
- To continue the programme, switch the washer-dryer back on with the ⏻ sensor.

⚠ Do not switch the washer-dryer off before the end of a drying programme unless all items are removed immediately and spread out to cool down.

Making changes

It is not possible to change the programme, the temperature, the spin speed or the selected Extras after the programme has started. This prevents the appliance being operated unintentionally, e.g. by children.

Adding laundry

Laundry can be added or removed if Add laundry is illuminated in the display.

- Touch the Add laundry sensor. The following will appear in the display: Please wait
- Pull open the door and add or remove items.
- Close the door.
- Touch the *Start/Stop* sensor. The programme will continue.

Washing and drying in one continuous sequence

Do not exceed the maximum load for the drying programme. It is very important to read the sections "Separate washing" and "Separate drying" before proceeding.

1. Preparing the laundry

- Sort the laundry according to the type of fibre and weave, garment care label symbol and the drying level required.

2. Selecting a programme

Switching the washer-dryer on

- Press the sensor.

Programme selection

- Touch the Washing + Drying sensor.
- Scroll to the right of the display until the programme you want appears.
- Touch the sensor for that programme. The display will then change to the standard menu for the programme. There are 3 other ways to select a programme:
 - Favourite programmes
 - The Washing/Drying assistant
 - Miele MobileStart

3. Loading the drum

- Open the door.
- Unfold the laundry and load loosely in the drum.

Detergent dispensing aids, e.g. plastic dispenser balls, can melt during the drying programme and cause damage to the machine and the laundry. These dispensing aids must be removed from the laundry before drying.

- Close the door.

When closing the door, make sure that laundry does not get trapped in the door opening.

4. Selecting programme settings

- Select the desired temperature, spin speed and drying level.
- Select TwinDos or CapDosing if desired.
- Select further Extras or stains as required.

Timer

You can use the Timer to set the finish time or the start time for a programme.

5. Adding detergent

- Dispense detergent via TwinDos, CapDosing or the detergent dispenser drawer.

6. Programme start/finish

- Touch the *Start/Stop* sensor. The door will lock. The programme status will appear in the display. The Anti-crease phase will start at the end of the programme.
- Touch the *Start/Stop* sensor. The door will unlock.

If you have unloaded the drum during the Anti-crease phase, make sure you spread out the laundry to cool it down.

- Pull the door open and unload the drum.

See "After each washing or drying programme".

After each washing or drying programme

- Open the drum door **fully**.

Risk of burning! The metal cap is hot after drying. Do not touch the metal cap located on the inside of the door glass.

- Remove the laundry.
- Check the folds in the door seal for any small articles, e.g. buttons, which might be lodged there.
- After drying, remove any fluff from around the door seal and the porthole glass.

Check that all items have been removed from the drum. Items left behind could be damaged in the next washing or drying programme.

- Switch the washer-dryer off.
- Tip:** Leave the detergent dispenser drawer slightly open to allow it to dry.

Rinse out fluff programme

During drying, fluff is developed and can collect in the drum and suds container.

The *Rinse out fluff* programme must not be used for rinsing laundry.

- Switch the washer-dryer on.
- Scroll through the main menu until Maintenance appears.
- Touch the Maintenance sensor.
- Select Rinse out fluff.

Do not use detergent.

- Touch the *Start/Stop* sensor. Any fluff will be rinsed away within a few minutes.
- If necessary, wipe any remaining fluff off the door seal and door glass.
- Switch the washer-dryer off.

Extras

Selecting Extras

- Touch the Extras sensor.
- Select one or more Extras.

Not all Extras can be combined. Extras that cannot be combined are greyed out and cannot be selected.

- Confirm with the OK sensor.

Washing and drying:

- SingleWash/Dry** – for the efficient washing and drying of very small loads.
- Extra quiet** – washing or drying with reduced noise.
- Pre-ironing** – for reducing creasing at the end of the programme.

Washing

- Quick** – for light soiling, with a shorter programme duration.
- Water plus** – more water when washing and rinsing.
- Pre-wash** – for laundry with large amounts of dirt.
- Soak** – for heavily soiled fabrics.
- Intensive** – for hard-wearing laundry that is very heavily soiled.
- AllergoWash** – where particularly high levels of hygiene are required.
- Rinse hold** – If Rinse hold is selected, the laundry remains in the water following the final rinse cycle.
- Separate rinse** – for a particularly good wash result.
- Extra gentle** – for gentle washing of lightly soiled fabrics.

Drying

- Gentle tumble** – for delicate fabrics such as acrylics.

Thermospin (drying only)

A spin cycle is carried out in some drying programmes to reduce energy consumption.

Programme chart - Washing

Programme	Load (in kg)	Items	Temperature
ECO 40-60	8.0	Normally soiled cotton garments. A laundry load that is intended for washing at 40°C or 60°C can be washed in the same wash cycle.	Cold to 90°C
Cottons	8.0	Cottons, linens or cotton mix fabrics, e.g. table linen, towelling, underwear, T-shirts etc.	Cold to 90°C
Minimum iron	3.5	Synthetic, mixed fibre and easy care cotton.	Cold to 60°C
QuickPower	4.0	Reduce the spin speed for fabrics which crease easily. Moderately soiled garments which are also suitable for washing in the Cottons programme. A special saturation process and wash rhythm ensure that the laundry is cleaned particularly quickly and thoroughly.	40°C to 60°C
Delicates	2.0	Delicate garments made from synthetic fibre, mixed fibre, rayon and viscose. For items which crease easily, deselect the spin.	Cold to 60°C
Shirts	2.0	Shirts and blouses made of cotton and mixed fibre. Turn shirts and blouses inside out, do up buttons and turn collars and cuffs inwards.	Cold to 60°C
Woolens	2.0	Machine-washable or hand-washable wool or wool blend fabric. If the care label does not specify a temperature, wash using the cold setting. Reduce the spin speed for items which crease easily.	Cold to 40°C
Denim	3.0	Items made of denim.	Cold to 60°C
Outerwear	2.5	Performance outerwear (e.g. jackets and trousers) made from membrane fabric such as Gore-Tex®, SYMPATEX®, WINDSTOPPER® etc.	Cold to 40°C

An explanation of further programmes can be found in the "Washing: Programme chart" in the operating instructions.

Programme chart - Drying

Programme	Load* (in kg)	Items	Drying levels
ECO 40-60	4.0	For cotton fabrics.	
Cottons	4.0	Cottons, linens or cotton mix fabrics, e.g. table linen, towelling, underwear, T-shirts etc.	, , , , ,
Minimum iron	3.5	For minimum iron items made of cotton, synthetic, or mixed fibre.	, , ,
QuickPower	4.0	Garments suitable for the Cottons programme.	, , , ,
Delicates	1.0	Delicate items with the symbol on the care label made of synthetic fibre, mixed fibre, rayon, and easy care cotton.	, , ,
Shirts	1.0	Shirt and blouses made of cotton and mixed fibres.	, , ,
Woolens	2.0	For woollen garments and fabric containing wool blends. Wool and wool blend fabrics and woollen garments are only fluffed up; they are not dried completely.	
Denim	3.0	All denim garments, e.g. jeans, jackets, skirts, shirts.	, , ,
Freshen up	1.0	Clean dry garments and garments that have been worn briefly and are not soiled.	, ,
Steam care	2.0	Reduces the amount of creasing in damp, freshly washed and spun cotton or linen garments.	
Outerwear	2.5	Outerwear which is suitable for drying in a tumble dryer.	, , ,
Proofing	2.5	For thermally fixing textiles which are suitable for tumble drying and have been treated with a proofing agent.	
Express 20	3.5	Garments suitable for the Cottons programme	, , ,

* Weight of dry laundry

= Extra dry; = Normal plus; = Normal; = Hand iron &; = Machine iron; = Timed drying

An explanation of further programmes can be found in the "Drying: Programme chart" in the operating instructions.

PROGRAMME OVERVIEW

To switch off the fault message, switch the washer-dryer off with the sensor.

Problem/Fault message	Possible cause and remedy
The display remains dark and the Start/Stop sensor indicator light does not come on. You are asked to enter a code.	There is no power to the machine. <ul style="list-style-type: none">Check whether the mains plug is plugged in and switched on.Check whether the circuit breaker has tripped. Access via a code has been activated. <ul style="list-style-type: none">Enter the code and confirm the entry. Deactivate the code if you do not wish this message to appear in the display the next time the machine is switched on.
The display is dark.	The display has switched off automatically to save energy (Standby mode). <ul style="list-style-type: none">Touch the <i>Start/Stop</i> sensor. This switches Standby off.
The following appears in the display: Door will not lock. Call Miele. or The door lock has jammed. Call Miele.	The door is not closed properly. The door lock could not engage. <ul style="list-style-type: none">Close the door again.Start the programme again. If the fault message appears again, contact Miele. The door will not open. The door lock has jammed. <ul style="list-style-type: none">Call Miele.
The programme has been cancelled and the following fault message appears in the display: Drainage fault	The water outlet is blocked or restricted. The drain hose has been fixed too high. <ul style="list-style-type: none">Clean the filters and the drain pump.Check whether the maximum delivery height of 1 m has been exceeded.
The programme has been cancelled and the following fault message appears in the display: Water intake fault.	The water inlet is blocked or restricted. <ul style="list-style-type: none">Check whether the tap is turned on properly.Check whether the inlet hose is kinked. If the fault message appears again, contact Miele.
The programme has been cancelled and the following fault message appears in the display: Waterproof system activated.	The water protection system has reacted. <ul style="list-style-type: none">Turn off the tap.Call Miele.
The programme has been cancelled and the following fault message appears in the display: Fault F	There is a fault. <ul style="list-style-type: none">Restart the programme. If the fault message appears again, contact Miele.

Problem/Fault message	Possible cause and remedy
The following appears in the display: Check load	There is very little or no laundry in the drum. <ul style="list-style-type: none">In future use a timed drying programme for drying only a few individual items. A machine overload was detected. <ul style="list-style-type: none">In future adhere to the maximum load limit for each programme.
The following appears in the display: Start "Rinse out fluff" programme in the "Maintenance" menu	The <i>Rinse out fluff</i> programme has not been used for a long time. <ul style="list-style-type: none">Start the <i>Rinse out fluff</i> programme.
The following appears in the display: Hygiene info	No drying programme or no wash programme using a temperature above 60°C has been run for a long time. <ul style="list-style-type: none">Start the <i>Clean machine</i> programme.
The following appears in the display: Use "TwinDos" or carry out "TwinDos" Maintenance in the "Maintenance" menu.	TwinDos or automatic dispensing via compartment ①/② has not been used for a long time. <ul style="list-style-type: none">Use TwinDos for one of your next loads.Carry out the TwinDos maintenance programme.
The following appears in the display: "TwinDos" Maintenance for compartment ① must be started in the "Maintenance" menu.	TwinDos or automatic dispensing via compartment ①/② has not been used for a long time. <ul style="list-style-type: none">Carry out the TwinDos maintenance programme immediately as described in "Cleaning and care – Maintenance programmes" in the operating instructions.
At the end of the programme or after a programme cancellation the following appears in the display: Extra cooling	For safety reasons, the door cannot be opened if the temperature in the drum exceeds 55°C during washing or 70°C during drying. <ul style="list-style-type: none">Wait until the temperature in the drum has decreased and the message has gone out in the display.
The laundry feels damp after drying. The laundry is too damp or too dry after a drying cycle.	Warm laundry can feel damp. <ul style="list-style-type: none">Spread the laundry out to cool it down. The desired residual moisture level is between two drying levels. <ul style="list-style-type: none">Change the level of drying as described in "Settings - Drying levels".

PROBLEM SOLVING GUIDE

These short instructions are not a substitute for the operating instructions supplied with the appliance. Please read the operating instructions supplied with your washer-dryer before using it for the first time and take note of the Warning and Safety instructions, as well as the full descriptions on how to use your appliance.



Quick Start Guide
Washer-dryer

