

Miele

Vacuum cleaner



Operating instructions

en-AU/NZ

HS22

M.-Nr. 12 963 210

Contents

Warning and Safety instructions	4
Sustainability and environmental protection	9
Guide to the appliance	10
Familiarisation	12
Accessories included	12
3D4U	12
Network connection	12
Symbols in the display	13
How the vacuum cleaner bag change indicator works	13
Function of the exhaust filter change indicator	13
Motor protection filter	13
Commissioning	14
Attaching the suction hose	14
Removing the suction hose	14
Connecting the suction hose to the handle	14
Connecting the handle to the suction tube	14
Connecting the suction tube to the adjustable floorhead	15
Activating the network function	15
Operation	16
Adjusting the telescopic tube	16
Adjusting the floorhead	16
Vacuuming staircases	17
Unwinding the mains cable	17
Rewinding the mains cable	17
Switching on and off	18
Update 	18
Regulating the suction power	18
Foot switches	18
Interim suction power levels	18
Removing accessories	19
Adjusting the 2-in-1 upholstery and crevice nozzle	19
Using the dusting brush integrated in the Comfort handle 2.0 (depending on the model)	20
Park system for pauses during vacuuming	20
Park system for storage	21
Cleaning and care	21
Purchasing accessories	22
Vacuum cleaner bag change indicator	22
Removing the vacuum cleaner bag	22
Inserting the vacuum cleaner bag	23
When the exhaust filter change indicator lights up	23

Replacing the AirClean Plus 50, Silence AirClean 50, Active AirClean 50 and HEPA AirClean 50 exhaust filters	24
Replacing one type of exhaust filter with another	24
Cleaning the motor protection filter	25
Replacing the thread lifters	25
Cleaning the vacuum cleaner and accessories	26
Troubleshooting	27
Technical data	28
Copyright and licences	28
Electrical connection AU, NZ	28
Service	29
Contact in case of malfunction	29
Warranty	29
Optional accessories	29

Warning and Safety instructions

This vacuum cleaner conforms to current safety requirements. Inappropriate use can lead to personal injury and damage to property.

Please read the operating instructions before using the vacuum cleaner for the first time. They contain important information on the safety, use, cleaning and care of the vacuum cleaner. This will prevent both personal injury and damage to the appliance.

In accordance with standard IEC 60335-1, Miele expressly and strongly advises that you read and follow the instructions in the "Commissioning" section as well as the warning and safety notes. Miele cannot be held liable for injury or damage caused by non-compliance with these instructions.

Keep these operating instructions in a safe place and pass them on to any future owner.

Always disconnect the vacuum cleaner from the power supply when you have finished using it, before changing any accessories and before performing cleaning, care and troubleshooting. Remove the plug from the socket.

Correct application

- ▶ This vacuum cleaner is intended for cleaning flooring in domestic households and similar residential environments. This vacuum cleaner is not suitable for use on construction sites.
- ▶ This vacuum cleaner can be used for all normal cleaning of carpets, rugs and robust hard flooring.
- ▶ This vacuum cleaner is not intended for outdoor use.
- ▶ This vacuum cleaner is intended for use at altitudes of up to 4000 m above sea level.
- ▶ The vacuum cleaner must only be used to vacuum dry floor surfaces. Do not vacuum people or animals. Any other types of use, modifications or alterations are not permitted.
- ▶ The vacuum cleaner can only be used by people (including children) with reduced physical, sensory, or mental capabilities, or lack of experience or knowledge, if they are supervised whilst using it or have been shown how to use it in a safe way and understand and recognise the consequences of incorrect operation.

Safety with children

- ▶ Danger of suffocation. Packaging, e.g. plastic wrappings, must be kept out of the reach of babies and children. Whilst playing, children could become entangled in packaging or pull it over their head and suffocate.
- ▶ Children under 8 years of age must be kept away from the vacuum cleaner unless they are constantly supervised.
- ▶ Children aged 8 and older may only use the vacuum cleaner without supervision if they have been shown how to use it in a safe manner. Children must be able to understand and recognise the possible dangers caused by incorrect operation.
- ▶ Children must not be allowed to clean or maintain the vacuum cleaner unsupervised.
- ▶ Please supervise children in the vicinity of the vacuum cleaner and do not let them play with it.

Warning and Safety instructions

Technical safety

- ▶ Check both the vacuum cleaner and all accessories supplied with it for any visible signs of damage before use. Do not use a damaged vacuum cleaner or damaged accessory.
- ▶ Compare the connection data on the data plate of the vacuum cleaner (mains voltage and frequency) with that of the mains electricity supply. This data must match exactly. Without modifications, the vacuum cleaner is suitable for 50 Hz or 60 Hz.
- ▶ The mains electrical outlet must be fitted with an appropriate circuit breaker.
- ▶ Temporary or permanent operation with a self-sufficient or non-mains synchronous energy supply system (e.g. isolated networks, back-up systems) is possible. A requirement for the operation is that the energy supply system complies with all current local and national requirements that apply to stand-alone, solar and/or battery systems. The protective measures provided in the domestic installation and in this Miele product must also be assured in their function and operation in isolated operation or in non-mains synchronous operation, or replaced with equivalent measures in the installation.
- ▶ While the vacuum cleaner is under warranty, repairs should only be undertaken by a Miele authorised service technician. Otherwise the warranty will be invalidated.
- ▶ Do not use the vacuum cleaner if the cable is damaged. If the cable is damaged it must be replaced together with a complete cable rewind. For safety reasons this must only be done by Miele Service or a Miele authorised service technician.
- ▶ Do not pull or carry the vacuum cleaner by the cable, and be careful not to damage the cable when withdrawing the plug from the socket. Keep the cable away from sharp edges and do not let it get squashed, for example, under a door. Avoid running the vacuum cleaner over the cable. This could damage the cable, plug or socket. The appliance must not be used if any of these have suffered damage.
- ▶ Repairs should only be carried out by a Miele authorised service technician. Repairs and other work by unqualified persons can cause considerable danger to users.

Correct use

- ▶ Do not use the vacuum cleaner without the vacuum cleaner bag, motor protection filter and exhaust filter in place.
- ▶ It is not possible to close the dust compartment lid if the vacuum cleaner bag is not inserted. Do not force it.
- ▶ Before closing the dust compartment lid, always make sure that the vacuum cleaner bag has been inserted far enough and has clearly clicked into position.
- ▶ Do not vacuum up anything which has been burning or is still glowing e.g. cigarettes, ashes or coal, whether glowing or apparently extinguished.
- ▶ Do not use the vacuum cleaner to vacuum toner dust. Toner, such as that used in printers and photocopiers, can conduct electricity.
- ▶ Do not use the vacuum cleaner to vacuum up any water, liquid or damp dirt. Wait until any freshly cleaned or shampooed rugs or carpets are completely dry before attempting to vacuum.
- ▶ Do not vacuum up any inflammable or combustible liquids or gases and do not vacuum in areas where such substances are stored.
- ▶ Do not vacuum at head height and do not let the suction get anywhere near a person's head.

Warning and Safety instructions

Cleaning

- ▶ Do not let the vacuum cleaner get wet. Clean only with a dry cloth or slightly damp cloth when disconnected from the mains supply.

Accessories and spare parts

- ▶ It is not advisable to vacuum directly with the handle, i.e. without an accessory attached as the rim could get damaged and you could hurt yourself on sharp edges.
- ▶ Only use vacuum cleaner bags, filters and original accessories bearing the Miele logo on the packaging. The manufacturer cannot otherwise guarantee the safety of the product.
- ▶ Miele can only guarantee the safety of the appliance when genuine Miele replacement parts are used. Faulty components must only be replaced with genuine Miele replacement parts.
- ▶ Miele will guarantee to supply functional spare parts for a minimum of 10 years and up to 15 years following the discontinuation of your vacuum cleaner.

Transport

- ▶ The packaging material protects the vacuum cleaner from transport damage. We recommend you keep the packaging for transport purposes.

Disposing of the packaging material

The packaging material is used for handling and protects the appliance from transport damage. The packaging material used is selected from materials which are environmentally friendly for disposal and can generally be recycled.

Recycling the packaging material reduces the use of raw materials. Use material-specific collection points for valuable materials and take advantage of return options.

We recommend you keep the packaging material for transport purposes.

Disposing of the vacuum cleaner bags and filters

Vacuum cleaner bags and filters are made from environmentally friendly materials. You can dispose of the filters with normal household waste. You can also dispose of the vacuum cleaner bag with normal household waste, providing it contains general household dust only.

Disposing of your old appliance

Electrical and electronic appliances contain many valuable materials. They also contain certain materials, compounds and components which were essential for their correct functioning and safety. These could be hazardous to human health and to the environment if disposed of with household waste or if handled incorrectly. Please do not, therefore, dispose of your old appliance with household waste.



Instead, please make use of officially designated collection and disposal points to dispose of and recycle electrical and electronic appliances in your local community, with your dealer or with Miele, free of charge. By law, you are solely responsible for deleting any personal data from the old appliance prior to disposal (depending on country). You are legally obliged to remove any old batteries which are not securely enclosed by the appliance and to remove any lamps without destroying them, where this is possible. These must be taken to a suitable collection point where they can be handed in free of charge. Please ensure that your old appliance poses no risk to children while being stored for disposal.

Guide to the appliance

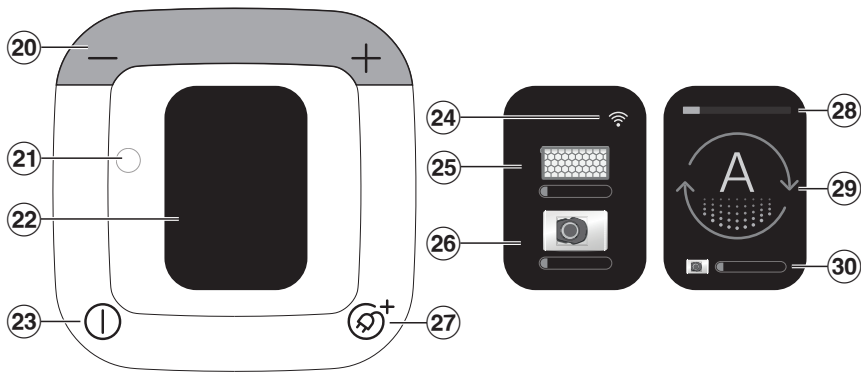
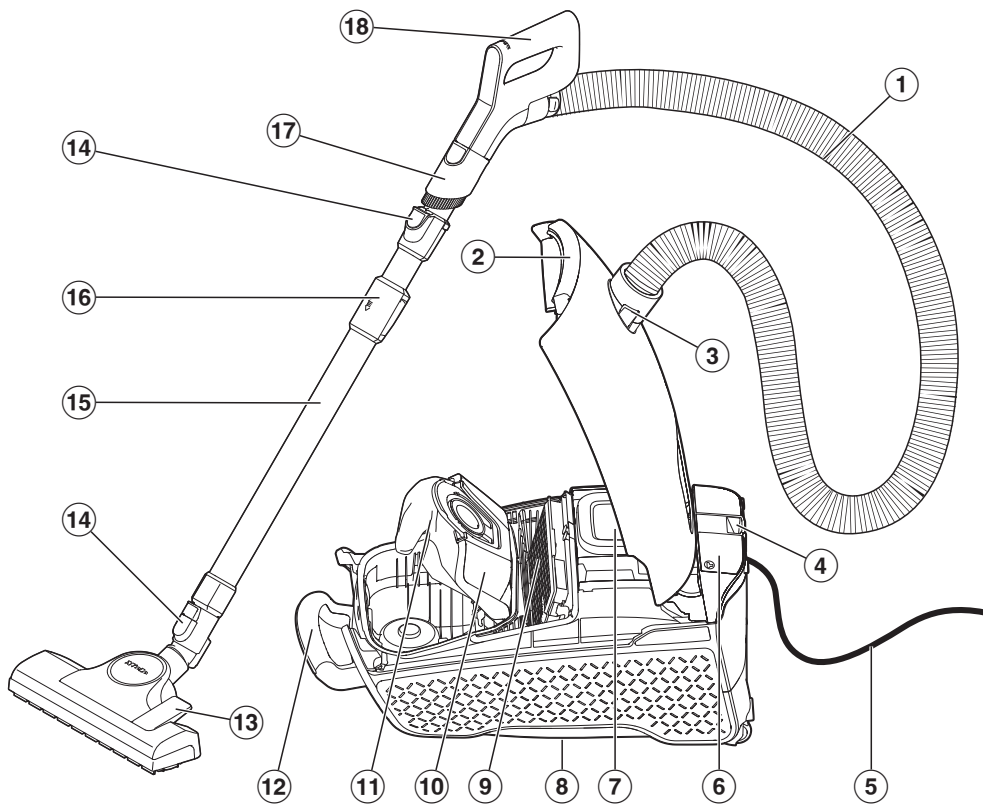

- ① Suction hose
- ② Dust compartment lid release button
- ③ Hose connector
- ④ Park system for pauses during vacuuming
- ⑤ Mains cable with plug
- ⑥ Accessories compartment for 2-in-1 upholstery and crevice nozzle
- ⑦ Control field
- ⑧ Park system for storage (underside of the vacuum cleaner)
- ⑨ Original Miele exhaust filter*
- ⑩ Vacuum cleaner bag holder
- ⑪ Original Miele vacuum cleaner bag
- ⑫ Carrying handle
- ⑬ Floorhead*
- ⑭ Release buttons
- ⑮ Telescopic tube
- ⑯ Telescopic tube release mechanism
- ⑰ Dusting brush
- ⑱ Comfort handle 2.0
- ⑲ +/- foot switches for setting the suction power
- ⑳ Optical interface for the Customer Service Department
- ㉑ Display
- ㉒ On/Off foot switch ①
- ㉓ WiFi signal status
- ㉔ Exhaust filter change indicator
- ㉕ Vacuum cleaner bag change indicator
- ㉖ Foot switch for automatic cable rewind ㉗⁺
- ㉘ Selected power level
- ㉙ Symbol for selected power level
- ㉚ Vacuum cleaner bag change indicator

* These features depend on the model and may vary or may not be available on your vacuum cleaner.

Familiarisation

This vacuum cleaner can be used for daily cleaning of carpets, rugs and robust hard floors.

Miele offers a range of suitable accessories for many special applications (see “Optional accessories”).

Accessories included

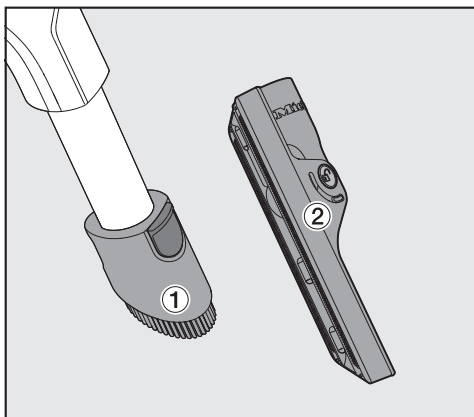

① Dusting brush

For vacuuming scratch-resistant surfaces, e.g. keyboards or vacuuming up crumbs.

② 2-in-1 upholstery and crevice nozzle

For cleaning in folds, crevices and corners as well as for vacuuming upholstered furniture, mattresses, cushions, curtains, etc.

3D4U

With 3D4U, Miele offers free accessories to download for your 3D printer (www.miele.com, Service, 3D4U).

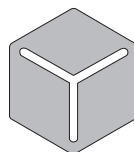

3 D 4 U

Network connection

The vacuum cleaner is equipped with an integrated WiFi module. The WiFi module makes it possible to connect to your home network and to use the Miele app on a mobile device.

Networking the vacuum cleaner allows you to do the following, among other things:

- Access status information
- Order more vacuum cleaner bags for your vacuum cleaner
- Access information about accessories based on your usage behaviour
- Keep the vacuum cleaner up to date with the latest Miele developments via software updates

Availability of the WiFi connection

The WiFi connection shares a frequency range with other appliances (including microwave ovens and remote control toys). This can give rise to sporadic or even complete connection failures. Therefore, the availability of featured functions cannot be guaranteed.

Symbols in the display

Symbols are shown on the display to indicate the type of use the power levels are suitable for.



Curtains, fabric



Upholstery, cushions



Automatic adjustment of the suction power to the surface



Cut pile carpets, rugs and runners



Hard floors and heavily soiled carpets and rugs



Manual selection of interim suction power levels



Saved interim suction power level

Other symbols for operation and function:

-	Reduces the suction power
+	Increases the suction power
①	On/Off
⌚ ⁺	Automatic cable rewind

How the vacuum cleaner bag change indicator works

The vacuum cleaner bag change indicator is set for normal household dust. This generally contains a mixture of dust, hair, threads, carpet fluff, grit, etc.

However, if the vacuum cleaner has been used to vacuum up fine dust, such as drilling dust, sand, plaster dust or flour, the pores of the vacuum cleaner bag will become blocked very quickly. The indicator will indicate that the vacuum cleaner bag is “full” even when it is not. The vacuum cleaner bag must be replaced if this is the case.

If, on the other hand, you vacuum up a significant amount of hair, carpet lint, etc., the vacuum cleaner bag will be full to bursting before the indicator reacts.

Function of the exhaust filter change indicator

The exhaust filter change indicator lights up after approximately 50 hours of operation, which is equivalent to about a year of average use. Change the exhaust filter when the indicator on the vacuum cleaner lights up. The level of soiling of the motor protection filter should also be checked at this point.

Each time you replace the exhaust filter and – if necessary – clean the motor protection filter, you must reset the indicator. Please refer to the “When the exhaust filter change indicator lights up” section in “Cleaning and care”.

Motor protection filter

Your vacuum cleaner is equipped with a Lifetime motor protection filter as standard. It will last for the entire service life of the vacuum cleaner and does not need to be replaced.

Commissioning

Attaching the suction hose

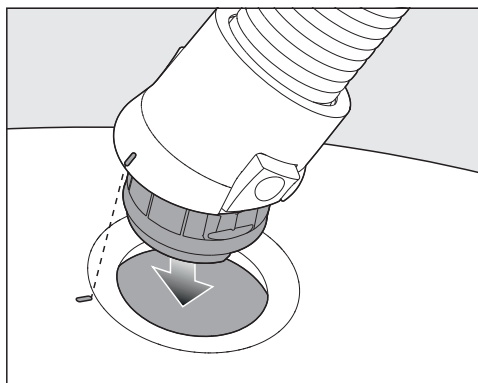

- Insert the hose connector into the suction opening on the vacuum cleaner until it clicks into position. To do this, line up the guides on the two pieces.

Removing the suction hose

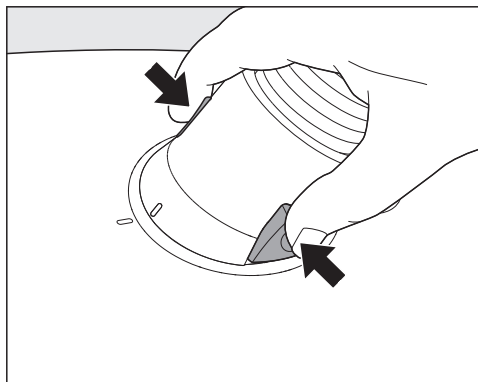

- Press the release buttons at the side of the hose connector, and lift the hose from the suction opening.

Connecting the suction hose to the handle

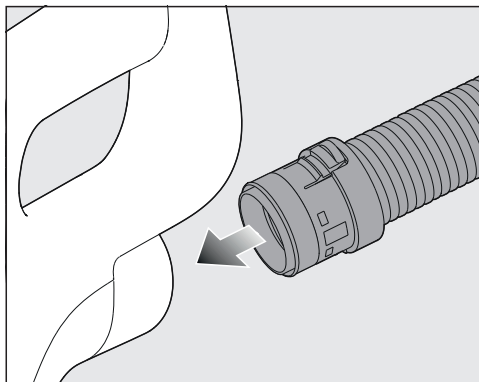

- Fit the suction hose connector into the handle until it clicks into position.

Connecting the handle to the suction tube

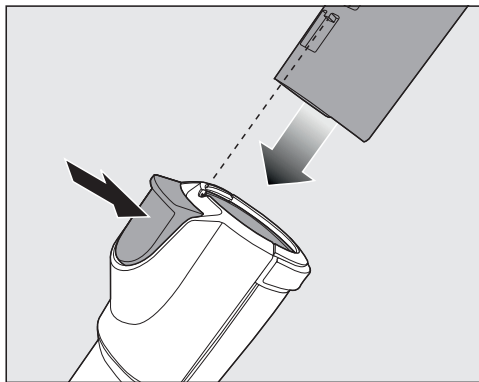

- Insert the handle into the suction tube until it clicks into position. To do this, line up the guides on the two pieces.
- To detach the handle from the suction tube, press the release button and pull the handle out of the suction tube, twisting it slightly as you do so.

Connecting the suction tube to the adjustable floorhead

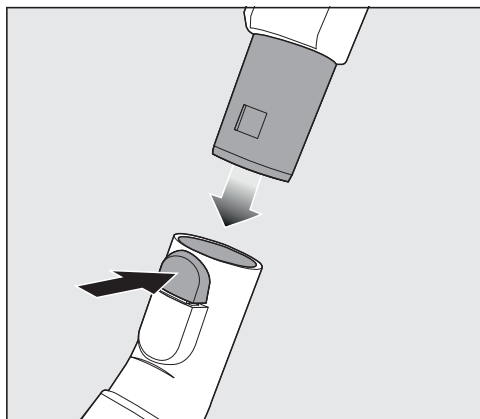

- Push the suction tube into the floorhead and turn it clockwise or anti-clockwise until it clicks into position.
- To separate the suction tube from the floorhead, press the release button and pull the suction tube away from the floorhead, twisting it slightly as you do so.

Activating the network function

Your vacuum cleaner is equipped with an integrated WiFi module.

Connecting your vacuum cleaner to your WiFi network will increase energy consumption.

Make sure that you have sufficient signal strength for your WiFi network where the vacuum cleaner will be used.

To set up this feature, you will need:

1. A WiFi network
2. Miele app
3. A Miele user account. You can create a user account via the Miele app.



- Scan the QR code to download the Miele app (if you do not have it yet).
- Open the Miele app and set up a user account.
- To start networking, scan the QR code again and follow the user navigation instructions in the Miele app.

The vacuum cleaner fan is switched off for the duration of the connection attempt. The vacuum cleaner display indicates that the connection has been established successfully.

You can also exit connection mode early without having established a connection. To do this, switch the vacuum cleaner off and on again using the On/Off Ⓢ foot switch.

Operation

Adjusting the telescopic tube

One part of the telescopic tube is packed inside the other, and it can be adjusted to suit your height for comfortable vacuuming.

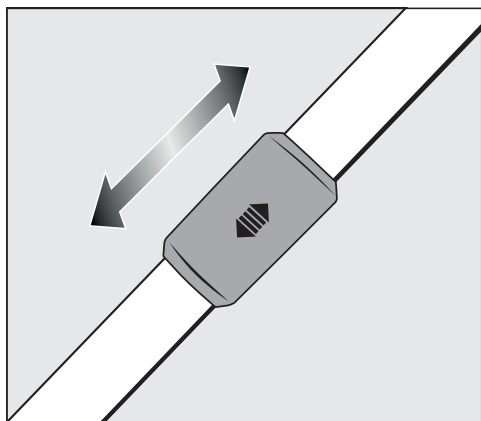

- Grasp the release mechanism and adjust the telescopic tube to the required length.

Adjusting the floorhead

Depending on the model, your vacuum cleaner will be fitted as standard with one of the floorheads illustrated.

Please observe the flooring manufacturer's cleaning and care instructions.

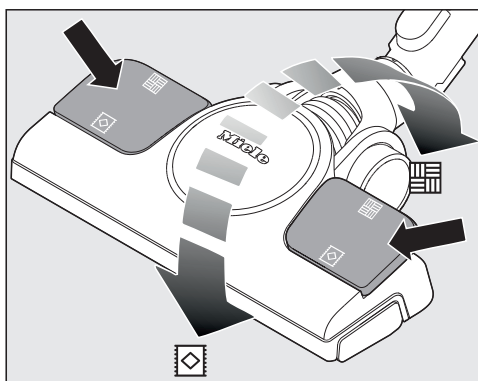
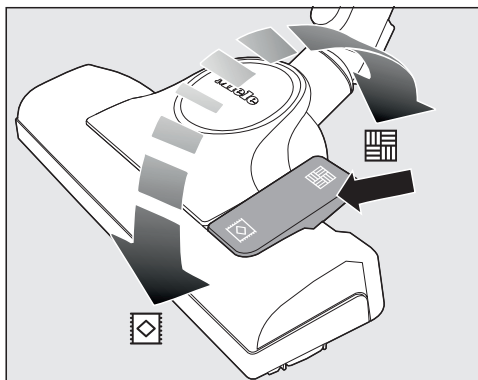

Clean hard flooring which is not susceptible to scratching, as well as flooring with gaps or deep crevices in it, with the brush protruding:

- Press the  foot switch.

Vacuum carpets and rugs with the brush retracted:

- Press the  foot switch.

Vacuuming staircases

⚠ Risk of injury caused by falling vacuum cleaner.
You or others may be injured if the vacuum cleaner should fall from the stairs.
When vacuuming stairs, it is best to start at the bottom of the stairs and move upwards.

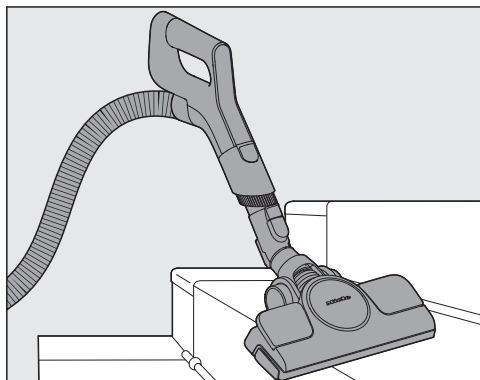

The adjustable floorhead can also be used for vacuuming the stairs.

Unwinding the mains cable

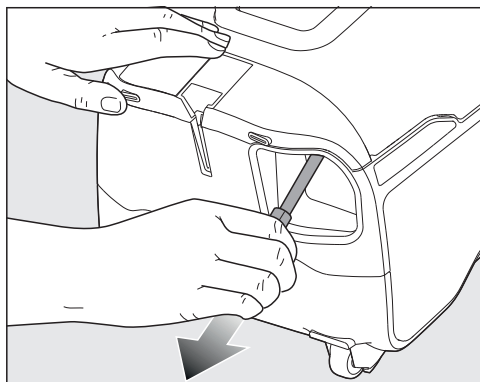

- Pull the mains cable out to the required length.
- Insert the power plug into the socket.

⚠ Risk of damage due to overheating.

The mains cable may overheat after a long period of use.

If vacuuming for longer than 30 minutes, the cable must be pulled out all the way.

Rewinding the mains cable

- Remove the plug from the socket.

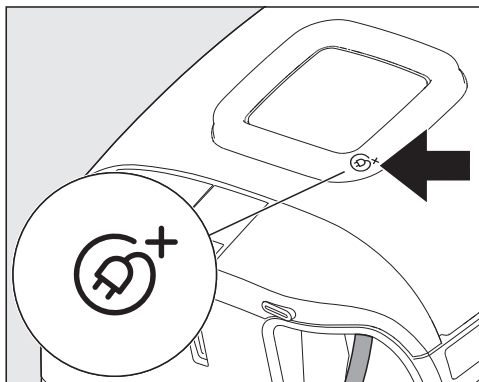

- Step briefly on the cable rewind foot switch.

The cable will then retract itself fully into the vacuum cleaner.

You can interrupt the cable rewind at any point.

- Give the cable a short pull while re-winding.

Switching on and off

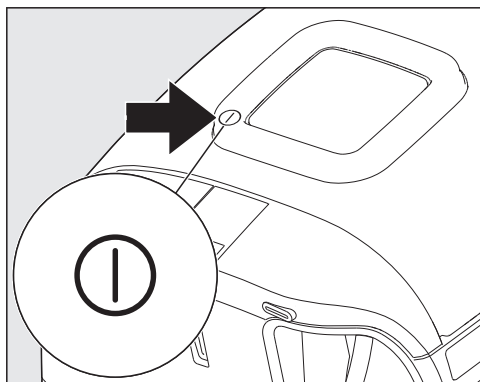

- Press the On/Off foot switch ①.

Update

Miele will provide you with updates  at irregular intervals. This will update the software in your vacuum cleaner and ensure that it is in line with the latest Miele developments.

After switching on the vacuum cleaner, you will be informed if there is an update  available.

- To start installing the update, press the + foot switch.

A progress bar will show you the status of the installation.

- To postpone the installation of the update, press the - foot switch.

The next time you switch on the vacuum cleaner, you will be prompted to install the update again.

Regulating the suction power

The suction power can be regulated to suit the type of flooring being cleaned. Reducing the suction power reduces the amount of effort required to manoeuvre the floorhead.

The selected power level is shown as a symbol and via an orange power indicator in the vacuum cleaner display, see the “Symbols in the display” section in “Familiarisation”.

Foot switches

The first time the vacuum cleaner is switched on, the highest power level will be selected automatically.

After that, the vacuum cleaner will switch on at the power level which was used previously.

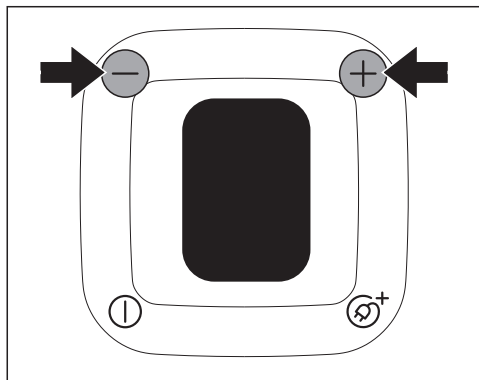

- Press the + foot switch to select a higher suction power level.
- Press the - foot switch to select a lower suction power level.

Interim suction power levels

You can deviate from the preset power levels and customise the suction power of your vacuum cleaner to meet your individual requirements.

To do this, proceed as follows:

- Press and hold the + or - button.

The display shows the symbol for manual selection of interim suction power levels.

- Press and hold the + or - button until the desired suction power is reached.
- Release the button.

Wait 5 seconds and do not touch the controls; the interim suction power setting will be saved to the next highest or lowest power level. A tick ✓ appears to confirm that the setting has been saved. The symbol for the saved interim suction power level is displayed.

The next time the vacuum cleaner is used it will switch on with the saved interim suction power level. This setting will be deleted if you then select one of the standard 4 power levels.

Removing accessories

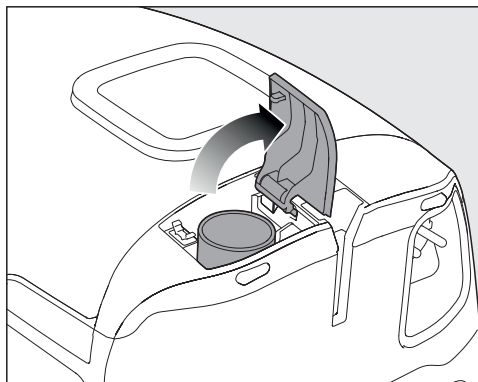

- Press the release button on the accessories compartment.

The accessories compartment will then open.

- Remove the combined upholstery and crevice nozzle.
- Press down firmly on the accessories compartment lid to close it.

Adjusting the 2-in-1 upholstery and crevice nozzle

Your vacuum cleaner is equipped with a combined upholstery and crevice nozzle as standard.

Crevice nozzle

Once removed from the accessories compartment, the 2-in-1 upholstery and crevice nozzle is suitable for cleaning in folds, crevices or corners.

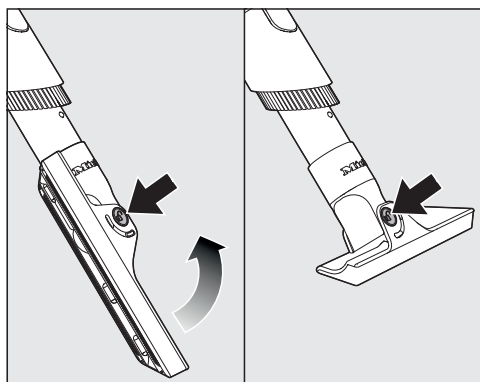

Upholstery nozzle

- Press the release button of the 2-in-1 upholstery and crevice nozzle and swivel the upholstery nozzle over the guide until it clearly engages in position.
- When you have finished cleaning, press the release button and swivel the upholstery nozzle back into its original position. Swivel the 2-in-1 upholstery and crevice nozzle until the release button clearly engages in position.

Using the dusting brush integrated in the Comfort handle 2.0

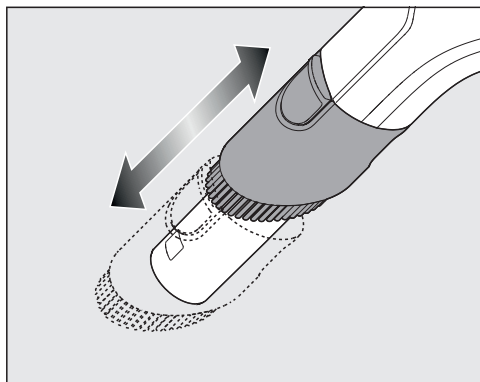

- Press the release button on the dusting brush and push the brush out until it clearly engages in position.

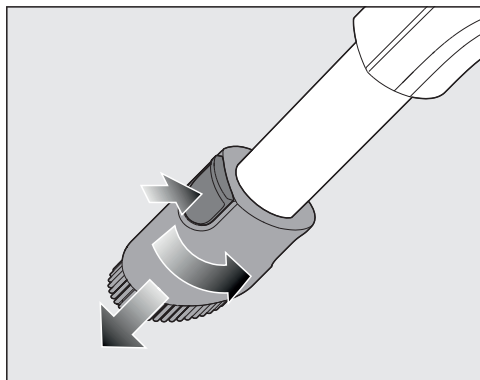

- Press the release button and turn the dusting brush to the side.
- Push the dusting brush down over the guide until it releases from the handle.

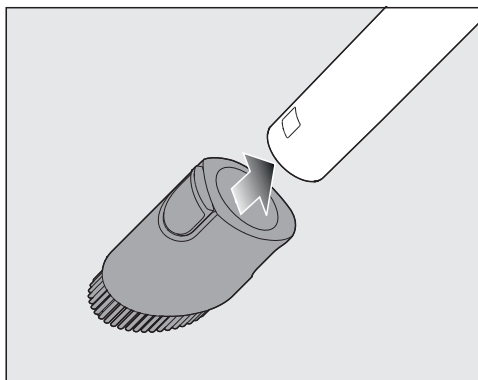

- Push the dusting brush onto the suction tube until it clicks into place.

When you have finished dusting

- Press the release button and pull the dusting brush off the suction tube.
- Push the dusting brush back onto the Comfort handle 2.0 until it clicks into place.
- Push the dusting brush to its original position so the handle can be pushed back into the suction tube.

Park system for pauses during vacuuming

The park system allows you to conveniently park the suction tube and floor-head during pauses.

 Risk of injury caused by vacuum cleaner falling over.

Do not use the park system if the vacuum cleaner is on a sloping surface, e.g. a ramp.

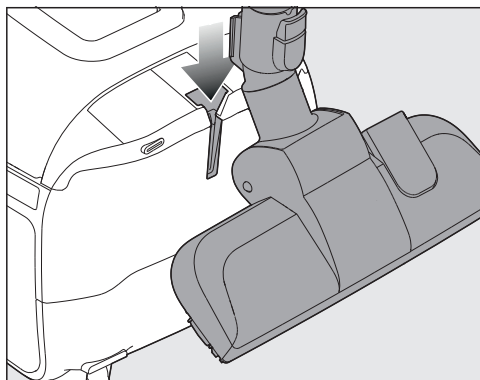

- Slot the floorhead downwards into the parking attachment on the underside of the vacuum cleaner.

Cleaning and care

 Risk of electric shock from mains voltage.

The mains voltage is applied to the appliance even if it is switched off. Before cleaning and care, switch the appliance off at the wall socket and unplug it.

- Slot the floorhead into the park system on the vacuum cleaner.

Park system for storage

 Risk of electric shock from mains voltage.

The mains voltage is applied to the vacuum cleaner even if it is switched off.

Always disconnect the vacuum cleaner from the power supply when you have finished using it. Remove the plug from the socket.

- Stand the vacuum cleaner upright.
- Retract the telescopic tube fully.

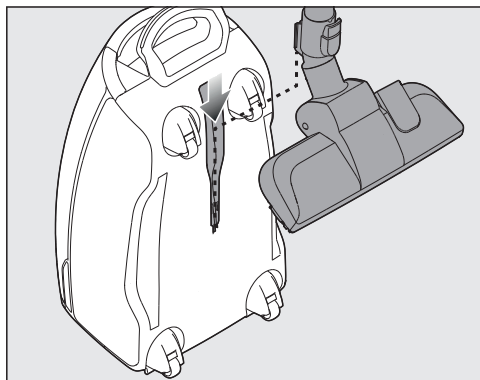

The Miele filter system consists of 3 accessories:

- Original Miele vacuum cleaner bag (model **TU**)
- Original Miele exhaust filter
- Motor protection filter

The vacuum cleaner bag and exhaust filter will need to be replaced from time to time to ensure that your vacuum cleaner performs efficiently.

We recommend using only genuine Miele accessories bearing the Miele logo on the packaging. Only these will guarantee the optimum suction power of your vacuum cleaner and the best possible cleaning results.

Vacuum cleaner bags with the Miele logo on the packaging are not made from paper or paper-based materials, nor do they have a cardboard collar. This is why Miele dustbags are particularly long-lasting and reliable.

Please note that faults and damage caused by use of accessories which do not bear the Miele logo on the packaging are not covered by the vacuum cleaner warranty.

Purchasing accessories

You can order genuine Miele accessories from the Miele online shop, Miele Customer Service or your Miele dealer.

You can identify genuine Miele accessories by the Miele logo on the packaging.

Every packet of original Miele vacuum cleaner bags contains 4 vacuum cleaner bags and one AirClean exhaust filter. Original Miele multipacks contain 16 vacuum cleaner bags and 4 AirClean exhaust filters.

For information on purchasing genuine Miele exhaust filters, see the sales designations in “Optional accessories” – “Filters”.

Vacuum cleaner bag change indicator

Replace the vacuum cleaner bag when indicated on the vacuum cleaner display.

Blocked pores reduce the suction power of the vacuum cleaner. Dispose of vacuum cleaner bags when they are full. Do not attempt to re-use vacuum cleaner bags.

Removing the vacuum cleaner bag

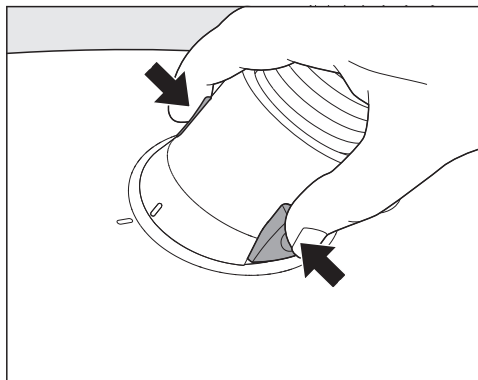

- Press the release buttons at the side of the hose connector and pull the hose out of the suction opening.

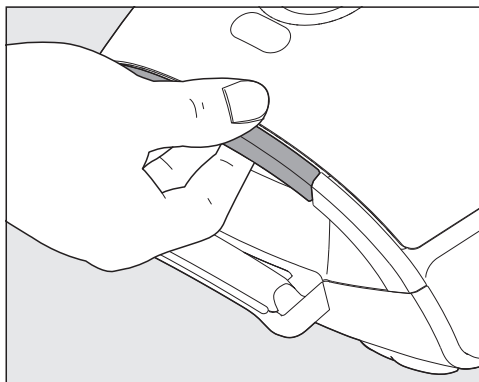

- Press the release button in the recessed grip for the dust compartment lid and raise the lid as far as it will go.

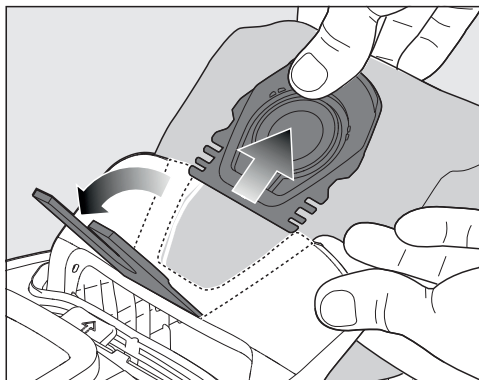

- Lift the vacuum cleaner bag holder with one hand.
- Pull out the vacuum cleaner bag with the other hand using the grip.

The turquoise catch element will lift up.

The turquoise catch element prevents the dust compartment lid from closing when there is no vacuum cleaner bag inserted.
Do not force it.

Inserting the vacuum cleaner bag

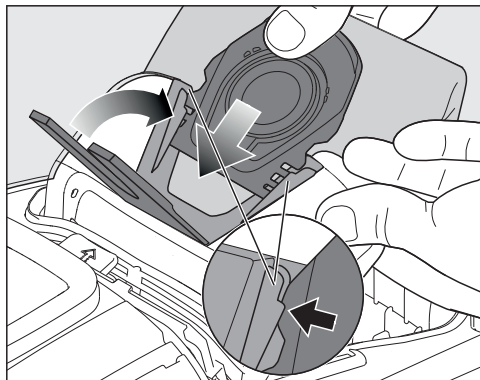

- Lift the vacuum cleaner bag holder with one hand.
- With the other hand, insert the new vacuum cleaner bag into the raised vacuum cleaner bag holder as far as it will go. Leave the vacuum cleaner bag folded up when you take it out of the packet.

Make sure that the collar of the vacuum cleaner bag is fully inserted into the guide on both sides (see magnified image).

The turquoise catch element closes and clicks into position.

- Close the dust compartment lid securely, making sure it clicks into position. Take care not to trap the vacuum cleaner bag when doing so.

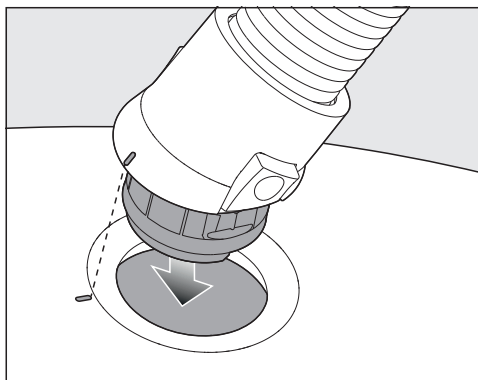

- Insert the hose connector into the suction opening on the vacuum cleaner until it clicks into position. To do this, line up the guides on the two pieces.

When the exhaust filter change indicator lights up

Replace the exhaust filter when indicated on the vacuum cleaner display. The level of soiling of the motor protection filter should also be checked at this point, see "Cleaning the motor protection filter".

You must reset the indicator each time you replace the exhaust filter. The vacuum cleaner must be switched on to do this.

- Press and hold the + button.

A countdown is displayed and the vacuum cleaner fan is switched off. The indicator will light up green to show it has been reset successfully. The indicator will then go out and reset to zero.

The indicator can only be reset when indicating that it is time to change the exhaust filter. It cannot be reset at other times.

Replacing the AirClean Plus 50, Silence AirClean 50, Active AirClean 50 and HEPA AirClean 50 exhaust filters

Do not use more than one exhaust filter at a time.

- Open the dust compartment lid.

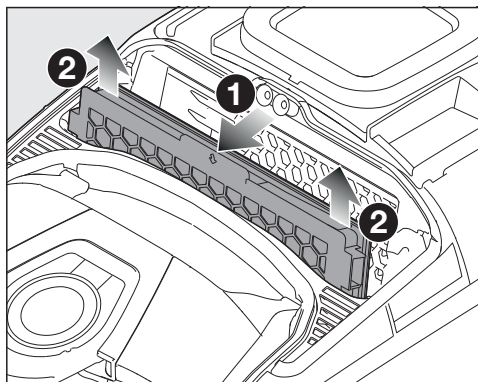

If you wish to fit an AirClean exhaust filter, see “Replacing one type of exhaust filter with another”.

- Pull the exhaust filter forwards and remove it upwards.

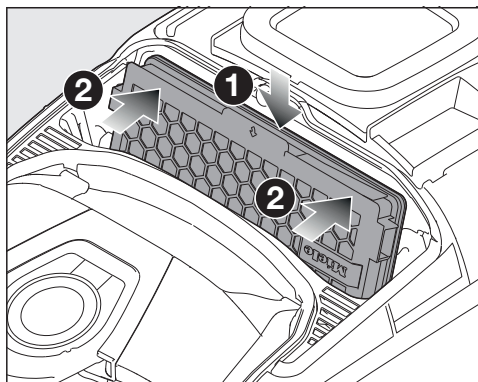

- Insert the new exhaust filter downwards, making sure it goes in properly, then press it backwards on both sides until it clicks into place.

Damage due to contamination in the dust compartment.

Large quantities of dust may get into the dust compartment and damage components if the vacuum cleaner bag has not clicked into position.

Before closing the dust compartment lid, always make sure that the vacuum cleaner bag has been inserted and the catch element is closed.

- Close the dust compartment lid securely, making sure it clicks into position. Take care not to trap the vacuum cleaner bag when doing so.

Replacing one type of exhaust filter with another

Do not use more than one exhaust filter at a time.

Depending on the model, your vacuum cleaner will be fitted as standard with one of the following exhaust filters:

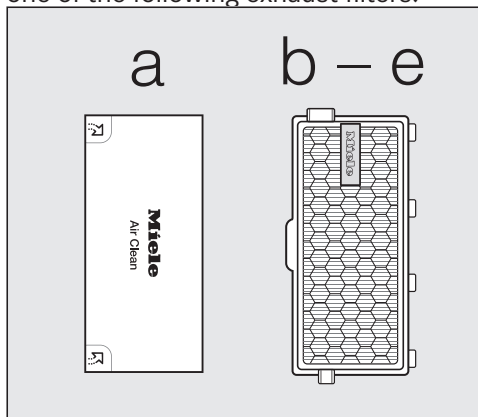

- a AirClean
- b AirClean Plus 50 (light blue)
- c Silence AirClean 50 (grey)
- d Active AirClean 50 (black)
- e HEPA AirClean 50 (white)

When changing the filter, please note

If you wish to replace exhaust filter **b**, **c**, **d** or **e** with filter **a**, it is essential that you also fit the filter grille, see the “Filter” section in “Optional accessories”.

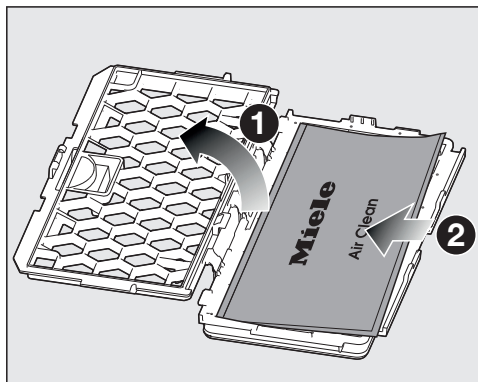

Cleaning the motor protection filter

- Open the dust compartment lid.
- Remove the vacuum cleaner bag.

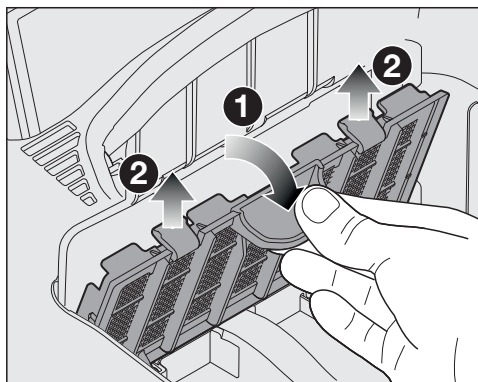

- Release the motor protection filter forwards and remove it upwards from the dust compartment.

⚠ Risk of damage caused by incorrect cleaning.

The motor protection filter can become damaged and be less effective as a result.

Do not clean the motor protection filter with water. Do not use pointed or sharp-edged objects to clean the filter.

- Clean the motor protection filter with a dry dust cloth or dust brush.

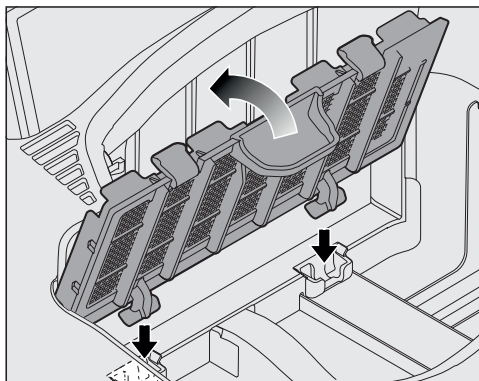

- Place the hinges of the motor protection filter carefully into the hinge recesses in the dust compartment and lock the motor protection filter so it clicks into place.
- Insert the vacuum cleaner bag into the holder until the catch element is firmly closed.
- Close the dust compartment lid securely, making sure it clicks into position. Take care not to trap the vacuum cleaner bag when doing so.

Replacing the thread lifters

(not possible for models with FlexTeQ/AllFloor floorheads)

Replace the thread lifters if the pile has worn down.

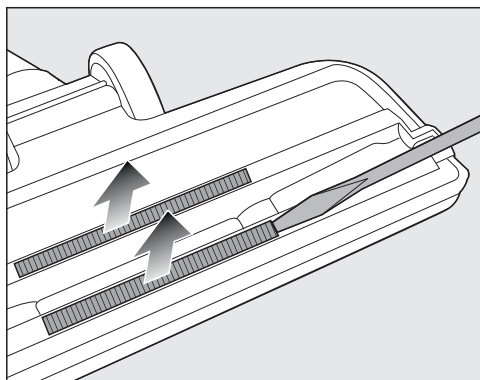

- Lever the thread lifters from the slots.
To do so use a suitable tool, e.g. a flat-head screwdriver.
- Fit new thread lifters.

Replacement parts are available from your Miele dealer or from the Miele Spare Parts Dept.

Cleaning the vacuum cleaner and accessories

 Risk of electric shock from mains voltage.

The mains voltage is applied to the vacuum cleaner even if it is switched off.

Before cleaning, switch the appliance off at the wall socket and unplug it.

 Risk of electric shock from mains voltage.

If moisture gets into the vacuum cleaner, there is a risk of electric shock.

Do not let the vacuum cleaner get wet.

- The vacuum cleaner and all plastic accessories should be cleaned with a commercially available cleaner suitable for plastic.

Static charge can cause a build-up of dust on the plastic parts of the vacuum cleaner. This should be removed using a soft, dry cloth.

 Damage due to unsuitable cleaning agents.

All surfaces are susceptible to scratching. Contact with unsuitable cleaning agents can alter or discolour the external surfaces.

Do not use abrasive cleaning agents, glass cleaning agents, all-purpose cleaners or oil-based care products.

Cleaning the dust compartment

The dust compartment can, if necessary, be cleaned using a dry duster, brush or, if available, a second vacuum cleaner to vacuum the dust out.

Also clean the underside of the dust compartment lid.

- Vacuum textile surfaces using a vacuum cleaner on the lowest power level with the dusting brush fitted.

Troubleshooting

Many malfunctions and faults that can occur in daily operation can be easily remedied. You can save time and money in many cases, as you do not need to call the Miele Customer Service Department.

Information to help you remedy faults yourself can be found at www.miele.com/service.

The following tables are designed to help you to find the cause of a malfunction or a fault and to resolve it.



Risk of electric shock from mains voltage.

The mains voltage is applied to the appliance even if it is switched off.

Before dealing with any problems, switch the appliance off at the wall socket and unplug it.

Problem	Cause and remedy
The vacuum cleaner switches off automatically.	<p>A temperature limiter switches the vacuum cleaner off automatically if it gets too hot. This can occur if, for instance, large objects block the suction tube or when the vacuum cleaner bag is full or contains particles of fine dust. A heavily soiled motor protection filter or exhaust filter can also be the cause of overheating.</p> <p>■ Switch the vacuum cleaner off immediately using the On/Off foot switch ①. Switch off at the wall socket and unplug it.</p> <p>After removing the cause, wait for approximately 20–30 minutes to allow the vacuum cleaner to cool down. It can then be switched on again.</p>

Technical data

Bluetooth

Frequency range	2.40–2.4835 GHz
Maximum transmission power	< 10 mW

WiFi

Frequency range	2.40–2.4835 GHz
Maximum transmission power	< 100 mW

Electricity consumption in standby mode

with WiFi activated	0,95 W
with WiFi deactivated	0,95 W

Copyright and licences

For the purpose of operating and controlling the vacuum cleaner, Miele uses proprietary or third-party software that is not covered by open source licensing terms. This software/these software components are protected by copyright. The copyrights held by Miele and third parties must be respected.

In addition, the vacuum cleaner contains software components which are distributed under open source licensing terms. The open source components contained in the appliance along with the corresponding copyright notices, copies of the licensing terms valid at the time, and any further information can be accessed locally by IP via a web browser (<http://<IP address>/Licenses>). The liability and warranty arrangements for the open source licences displayed in this location only apply in relation to the respective rights holders.

Electrical connection AU, NZ

All work must be carried out by a suitably qualified and competent person in strict accordance with national and local safety regulations. The voltage and rated load are given on the data plate located underneath the vacuum cleaner. Please ensure that these match the household mains supply. The appliance is supplied with a cable and moulded plug ready for connection to a 230V/50Hz AC single phase supply.

Test Marks	Electrical safety RCM Mark
Electrically suppressed according to	AS/NZS CISPR 14.1

Service

Information to help you rectify faults yourself and about Miele spare parts can be found at www.miele.com/service.

Contact in case of malfunction

In the event of any faults which you cannot remedy yourself, please contact your Miele Dealer or Miele Service.

Contact information for Miele Service can be found at the end of this document.

Please note that telephone calls may be monitored and recorded for training purposes and that a call-out charge will be applied to service visits where the problem could have been resolved as described in this booklet.

Warranty

For information on the appliance warranty specific to your country please contact Miele. See end of this document for contact details.

In the UK, your appliance warranty is valid for 2 years from the date of purchase. However, you must activate your cover by calling 0330 160 6640 or registering online at www.miele.co.uk.

Optional accessories

Please observe the flooring manufacturer's cleaning and care instructions.

Please note that faults and damage caused by use of accessories which do not bear the Miele logo on the packaging are not covered by the vacuum cleaner warranty.

These and many other products can be ordered from the Miele online shop, the Miele Customer Service Department or your Miele dealer.

Certain models are supplied with one or more of the following accessories as standard.

Floorheads / brushes

(only available in selected countries)

AllFloor (SBD AF) floorhead

Flat floorhead for cleaning underneath very low furniture. It is also quiet, light and stands out due to its very good pick-up of coarse dirt.

TurboTeQ Turbobrush (STB 305-3)

This brush is ideal for cleaning cut pile carpet.

Parquet Twister floorbrush with swivel action (SBB 300-3)

With natural bristles for vacuuming smooth hard floors and small gaps.

Parquet Twister XL floorbrush with swivel action (SBB 400-3)

With natural bristles for quickly vacuuming smooth hard floors and small gaps.

Other accessories

(only available in selected countries)

Turbo Mini hand turbobrush (STB 101)

For vacuuming upholstery, mattresses or car seats, etc.

Universal brush (SUB 20)

For dusting books, shelves, etc.

Radiator brush (SHB 30)

For dusting radiators, narrow shelves and crevices.

Mattress nozzle (SMD 10)

For vacuuming upholstery, mattresses, cushions, curtains, covers etc.

Crevice nozzle, 300 mm (SFD 10)

Extra long crevice nozzle for cleaning in folds, crevices and corners.

Crevice nozzle, 560 mm (SFD 20)

Flexible crevice nozzle for vacuuming hard to reach places.

XL upholstery nozzle (SPD 20)

Wide upholstery nozzle for cleaning upholstery, mattresses and cushions.

Filters

AirClean Plus 50 exhaust filter (SF-AP 50)

Effective filtration for particularly clean room air.

Exhaust filter Silence AirClean 50 (SF-SA 50)

For a significant reduction in noise whilst vacuuming.

Active AirClean 50 exhaust filter (SF-AA 50)

For a significant reduction of unpleasant odours. Ideal for households with pets or smokers.

HEPA AirClean 50 exhaust filter (SF-HA 50)

Effectively filters fine dust and allergens. Ideal for people allergic to house dust.

Filter grille

This is required if you wish to replace an AirClean Plus 50, Silence AirClean 50, Active AirClean 50 or HEPA AirClean 50 filter with an AirClean filter.

Miele Australia Pty. Ltd.

ACN 005 635 398

ABN 96 005 635 398

Level 4, 141 Camberwell Road
Hawthorn East, VIC 3123

1300 464 353 (1300 4 MIELE)

info@miele.com.au

www.miele.com.au

Miele New Zealand Limited

IRD 98 463 631

8 College Hill
Freemans Bay, Auckland 1011

0800 464 353 (0800 4 MIELE)

customercare@miele.co.nz

www.miele.co.nz

Miele Global Headquarters

Germany

Miele & Cie. KG

Carl-Miele-Straße 29

33332 Gütersloh

Federal Republic of Germany