

Operating and installation instructions

SmartLine downdraft extractor

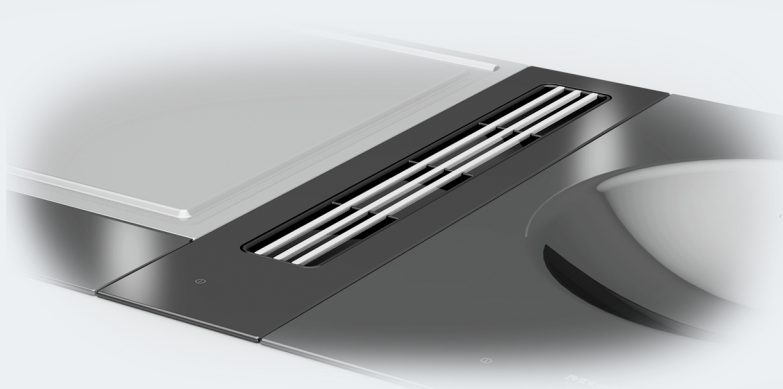

To prevent the risk of accidents or damage to the appliance, it is **essential** to read these instructions before it is installed and used for the first time.

Contents

Warning and Safety instructions	4
Caring for the environment	14
Overview	15
Downdraft extractor	15
Controls and display	16
Accessories supplied	17
How it works	18
Tips on saving energy	19
Cleaning the SmartLine appliance for the first time	20
Operation	21
Switching the downdraft extractor on	21
Setting/Changing the power level	21
Switching the downdraft extractor off	21
Run-on time	21
Cleaning and care	22
Cleaning the ceramic surface	23
Cleaning the drip tray	23
Grease filter / Extraction grille	24
Problem solving guide	26
Optional accessories	27
Service	28
Contact in case of fault	28
Data plate	28
Warranty	28
Installation	29
Safety instructions for installation	29
Installation examples	30
Installation notes – surface-mounted	31
Worktop cut-out – surface-mounted	33
Spacer bars – surface-mounted	36
Installation dimensions – Surface-mounted	37
Air duct dimensions – surface-mounted – worktop depth 600 mm	38
Air duct dimensions – surface-mounted – worktop depth greater than 600 mm	42
Installation – surface-mounted	46
Installation notes – flush-fit	53

Worktop cut-out – flush-fit 55

Spacer bars – flush-fit 58

Installation dimensions – Flush-fit 59

Air duct dimensions – flush-fit – worktop depth 600 mm 60

Air duct dimensions – flush-fit – worktop depth greater than 600 mm 64

Installation – flush-fit 68

Exhaust ducting..... 75

Electrical connection 76

Warning and Safety instructions

This downdraft extractor complies with all relevant safety requirements. However, inappropriate use can lead to personal injury and damage to property.

Please read these operating and installation instructions carefully before using the downdraft extractor for the first time. They contain important information on safety, installation, use and maintenance of the appliance. This prevents both personal injury and damage to the downdraft extractor.

In accordance with standard IEC 60335-1, Miele expressly and strongly advises that you read and follow the instructions in "Installation" and in "Warning and Safety instructions".

Miele cannot be held liable for injury or damage caused by non-compliance with these instructions.

Keep these instructions in a safe place and pass them on to any future owner.

For safe operation, please also refer to the operating and installation instructions for the SmartLine appliances and cooktops installed adjacent to the downdraft extractor.

Correct application

- ▶ This downdraft extractor is designed for domestic use and for use in similar environments by guests in hotel or motel rooms, bed & breakfasts and other typical living quarters. This does not include common/shared facilities or commercial facilities within hotels, motels or bed & breakfasts.
- ▶ The downdraft extractor is not suitable for outdoor use.
- ▶ The downdraft extractor must only be used to extract vapours and remove odours from cooking.
Any other usage is at the owner's risk. Miele cannot be held liable for damage resulting from incorrect or improper use or operation.
- ▶ This downdraft extractor is not intended for use by persons (including children) with reduced physical, sensory or mental capabilities, or lack of experience and knowledge, unless they are supervised whilst using it or have been given instruction concerning its use by a person responsible for their safety.
They must be able to recognise the dangers of misuse.

Warning and Safety instructions

Safety with children

- ▶ Young children must be kept away from the downdraft extractor.
- ▶ Older children may only use the downdraft extractor without supervision if they have been shown how to use it in a safe manner. They must be aware of the potential dangers caused by incorrect operation.
- ▶ Cleaning work may only be carried out by older children under the supervision of an adult.
- ▶ Please supervise children in the vicinity of the downdraft extractor and do not let them play with it.
- ▶ Danger of suffocation! Whilst playing, children may become entangled in packaging material (such as plastic wrapping) or pull it over their head with the risk of suffocation. Keep packaging material away from children.

Technical safety

- ▶ Unauthorised installation, maintenance and repairs (including removal of any cover) can cause considerable danger for the user. Installation, maintenance and repairs must only be carried out by a Miele authorised technician.
- ▶ The downdraft extractor must only be installed and operated in combination with those SmartLine appliances and cooktops specified by Miele.
- ▶ A damaged appliance is dangerous. Check it for any visible damage. Never install or attempt to use a damaged appliance.
- ▶ Temporary or permanent operation with a self-sufficient or non-mains synchronous energy supply system (e.g. isolated networks, back-up systems) is possible. A requirement for the operation is that the energy supply system complies with all current local and national requirements that apply to stand-alone, solar and/or battery systems.

The protective measures provided in the domestic installation and in this Miele product must also be assured in their function and operation in isolated operation or in non-mains synchronous operation, or replaced with equivalent measures in the installation.
- ▶ The electrical safety of this appliance can only be guaranteed when continuity is complete between it and an effective earthing system. It is most important that this basic safety requirement is present and tested regularly and, where there is any doubt, the household wiring system should be inspected by a qualified electrician.
- ▶ Before connecting the appliance to the mains electricity supply, make sure that the rating on the data plate (voltage and frequency) corresponds to that of the household supply.

This data must correspond in order to avoid risk of damage to the appliance. Consult a qualified electrician if in any doubt.

Warning and Safety instructions

- ▶ Multi-socket adapters and extension leads do not guarantee the required safety of the appliance (fire hazard). Do not use these to connect the downdraft extractor to the mains electricity supply.
- ▶ For safety reasons, this downdraft extractor may only be used after it has been built in.
- ▶ This downdraft extractor must not be installed and operated in mobile installations (e.g. on a ship).
- ▶ Touching or tampering with electrical connections or components and mechanical parts is highly dangerous to the user and can cause operational faults.
Only open the housing as described in the installation instructions and in the Cleaning and care section of this booklet. Under no circumstances should any other parts of the housing be opened.
- ▶ The manufacturer's warranty will be invalidated if the appliance is not repaired by a Miele authorised service technician.
- ▶ Faulty components must only be replaced by genuine Miele spare parts. The manufacturer can only guarantee the safety of the appliance when Miele replacement parts are used.
- ▶ The downdraft extractor is not intended for use with an external timer switch or a remote control system.
- ▶ If the plug is removed from the connection cable or if the cable is supplied without a plug, the downdraft extractor must be connected to the mains electricity supply by a suitably qualified electrician.
- ▶ If the mains connection cable is damaged, it must be replaced with a special mains connection cable by a qualified and competent electrician in order to avoid a hazard (see “Installation - Electrical connection”).

Warning and Safety instructions

► During installation, maintenance and repair work, the downdraft extractor must be completely disconnected from the mains electricity supply. It is only completely isolated from the electricity supply when:

- the mains circuit breaker is switched off, or
- the screw-out fuse is removed (in countries where this is applicable), or
- it is switched off at the wall socket and the plug is withdrawn from the socket. Do not pull the mains connection cable but the mains plug to disconnect your appliance from the mains electricity supply.

Warning and Safety instructions

Using at the same time as other heating appliances that depend on the air from the room

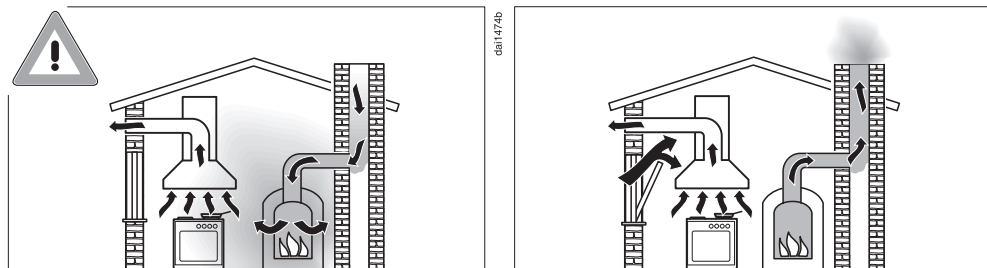

Warning - danger of toxic fumes!

Great care should be taken when using the downdraft extractor at the same time and in the same room or area of the house as another heating appliance which depends on the air in the room. Such appliances include gas, oil, wood or coal-fired boilers and heaters, continuous flow or other water heaters, gas cooktops, or ovens which draw air in from the room and duct exhaust gases out through a chimney or extraction ducting.

When used in extraction mode, with or without an external motor fitted, or in recirculation mode with a recirculation box installed outside the room, the downdraft extractor draws air in from the room in which it is installed and from neighbouring rooms.

If there is insufficient air, an underpressure will occur. The heating appliance will be starved of oxygen, impairing combustion. Harmful gases could be drawn out of the chimney or extraction ducting back into the room, with potentially fatal consequences.

Warning and Safety instructions

In order to ensure safe operation, and to prevent gases given off by the heating appliances from being drawn back into the room when the downdraft extractor and the heater are in operation simultaneously, an underpressure in the room of 0.04 mbar (4 pa) is the maximum permissible.

Ventilation can be maintained by air inlets which cannot be blocked, in windows, doors or outside wall vents, or by other technical measures, such as ensuring that the downdraft extractor can only be switched on when the heating appliance is switched off or vice versa. A ventilation brick alone is not generally sufficient to ensure safe ventilation.

The overall ventilation condition of the dwelling must be taken into account. If in any doubt, the advice of a competent builder or, for gas, a qualified gas fitter (registered with an official gas safety body in accordance with national safety regulations) must be sought.

If the downdraft extractor is used in recirculation mode, where the air is directed back into the room in which it is located, operating a heating appliance which depends on the room air at the same time is not hazardous.

Warning and Safety instructions

Correct use

- ▶ Open flames are a fire hazard!

Never use an open flame beside the downdraft extractor. To avoid the danger of fire, do not flambé or grill over an open flame. When switched on, the downdraft extractor could draw flames into the filter. Kitchen grease deposits could ignite.

- ▶ Overheated oil and fat can ignite, causing fire damage to the downdraft extractor.

When cooking with oil or fat, chip pans and deep fat fryers etc., do not leave the pans unattended. Similarly, never leave an open grill unattended when grilling.

- ▶ Do not use the downdraft extractor without the filter in place. This way you will avoid the risk of grease and dirt getting into the appliance and hindering its smooth operation.

- ▶ The downdraft extractor can get very hot during cooking due to the heat from the cooktop.

Do not touch the housing or the grease filter until the downdraft extractor has cooled down.

- ▶ Do not use the downdraft extractor for resting objects on.

- ▶ Keep liquids away from the downdraft extractor.

Liquids can damage the extractor if they get into it.

- ▶ Light objects can be drawn into the downdraft extractor and impair its operation.

Do not place any light objects (e.g. paper towels) within close proximity of the downdraft extractor.

- ▶ If you are operating a gas cooking appliance directly next to the downdraft extractor, the FlameGuard must be placed between the downdraft extractor and the appliance.

Cleaning and care

► The steam from a steam cleaning appliance could reach electrical components and cause a short circuit.

Do not use a steam cleaner to clean the downdraft extractor.

► There is a risk of fire if cleaning is not carried out as described in these operating instructions.

► Miele will guarantee to supply functional spare parts for a minimum of 10 years and up to 15 years following the discontinuation of your SmartLine appliance.

Accessories

► Use only genuine original Miele spare parts. If spare parts or accessories from other manufacturers are used, the warranty will be invalidated, and Miele cannot accept liability.

Caring for the environment

Disposal of the packing material

The transport and protective packaging has been selected from materials which are environmentally friendly for disposal, and can normally be recycled.

Recycling the packaging reduces the use of raw materials in the manufacturing process and also reduces the amount of waste in landfill sites. Ensure that any plastic wrappings, bags etc. are disposed of safely and kept out of the reach of babies and young children. Danger of suffocation.

Disposing of your old appliance

Electrical and electronic appliances often contain valuable materials. They also contain specific materials, compounds and components, which were essential for their correct function and safety. These could be hazardous to human health and to the environment if disposed of with your domestic waste or if handled incorrectly. Please do not, therefore, dispose of your old appliance with your household waste.



Please dispose of it at your local community waste collection / recycling centre for electrical and electronic appliances. You are also responsible for deleting any personal data that may be stored on the appliance prior to disposal. Please ensure that your old appliance poses no risk to children while being stored prior to disposal.

Downdraft extractor

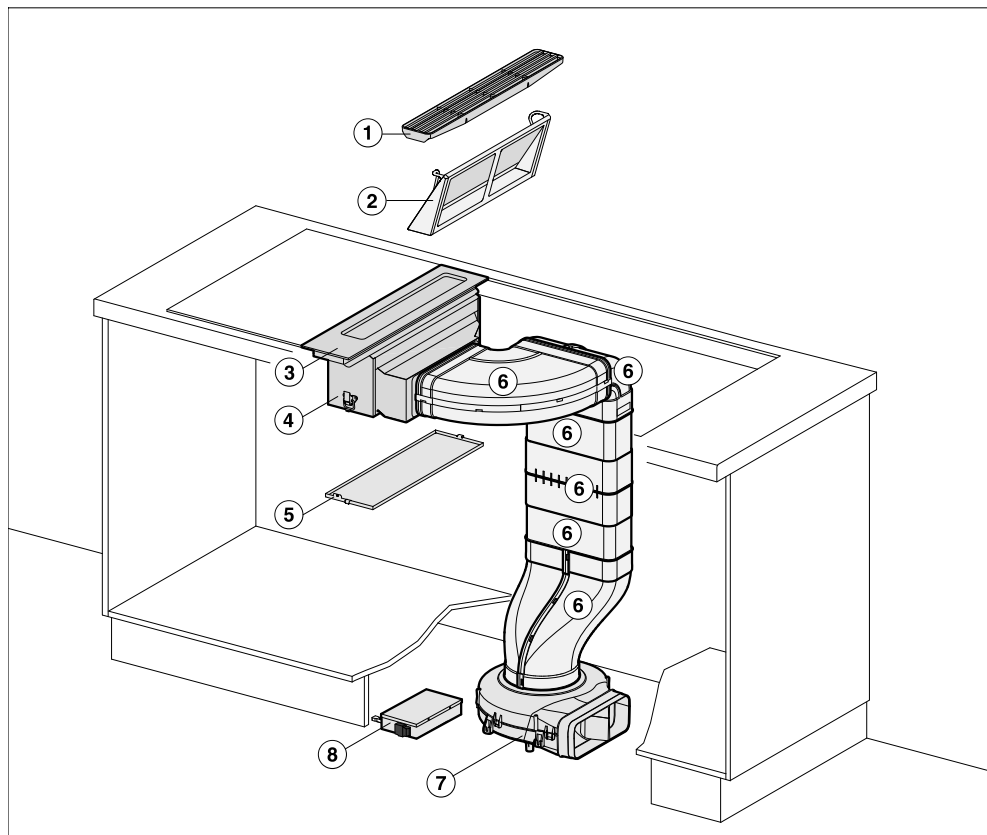

- ① Extraction grille
- ② Grease filter
- ③ Cover with control unit
- ④ Casing
- ⑤ Removable drip tray
- ⑥ Air duct
(accessory supplied)
- ⑦ Fan
In the plinth on the floor
- ⑧ E-box

Overview

Controls and display

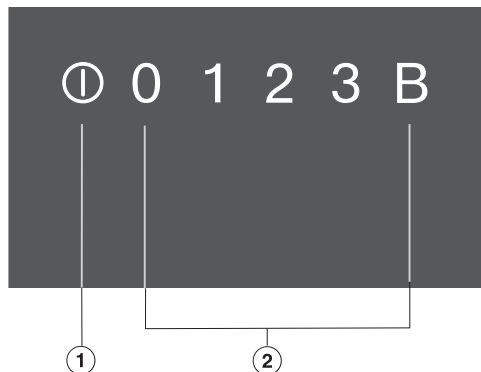

- ① Downdraft extractor On/Off
- ② Numerical keybank
For setting a power level

Accessories supplied

The accessories supplied with your appliance, as well as a range of optional ones, are available to order from Miele (see “Optional accessories”).

Air duct

Flat ducting system for routing air from the casing to the fan.

How it works

Air extraction mode

The air is drawn in and cleaned by the grease filter and directed outside.

Recirculation mode

(DUU 1000(-1) conversion kit required)

The air is drawn in and cleaned by the grease filter. The air is then directed into the recirculation box where it is also cleaned by the charcoal filter. The cleaned air is then recirculated back into the kitchen.

This downdraft extractor operates very efficiently and economically. The following will help you to save even more energy when using it:

- It is important to ensure that the kitchen is well ventilated during operation. In extraction mode if there is insufficient air flow, the downdraft extractor cannot operate efficiently and this causes increased operating noise levels.
- Always cook with the lowest possible cooking setting. This produces fewer cooking vapours, so you can use a lower extractor power level and therefore benefit from reduced energy consumption.
- Check the selected power level on the downdraft extractor. A low power level is usually sufficient. Only use the Booster setting when necessary.
- When a large volume of cooking vapours are being produced, switch to a high power level in good time. This is more efficient than operating the downdraft extractor for longer to try to capture cooking vapours which have already been distributed throughout the kitchen.
- Switch the downdraft extractor off after cooking.
- Clean or replace the filters at regular intervals. Heavily soiled filters reduce performance, increase the risk of fire and are unhygienic.

Cleaning the SmartLine appliance for the first time

- Please stick the extra data plate for the appliance supplied with this documentation in the space provided in the “Service” section of this booklet. Alternatively, the additional label can be stuck near the appliance if the appliance markings are not visible after installation.
- Remove any protective wrapping and stickers (except the data plate).
- Clean the ceramic surface with a damp cloth, and then wipe dry.

Switching the downdraft extractor on

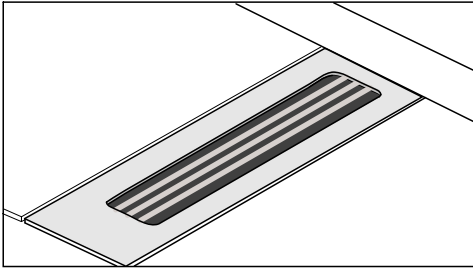

- Insert the extraction grille.
- Touch the ① sensor.

The sensor controls will light up.

If no further entry is made, the downdraft extractor will switch itself off after a few seconds.

Setting/Changing the power level

For light to heavy cooking vapours and odours, select from power levels **1** to **3**. For short periods of cooking food with intensive vapours and a strong aroma, e.g. when searing meat, select Booster setting **B**.

- Touch the required power level.

Booster

The maximum duration for the Booster is 10 minutes.

- To switch the Booster off early, set a different power level.

Switching the downdraft extractor off

- Touch the ① sensor.

The sensor controls go out.

If the downdraft extractor is not switched off, it will switch itself off 12 hours after the last automatic operation.

Run-on time

In order to rid kitchen air of steam and odours, the downdraft extractor continues to run for 5 minutes on the power level that was set last. The power level is gradually reduced during the run-on time. The current power level pulsates during the run-on time.

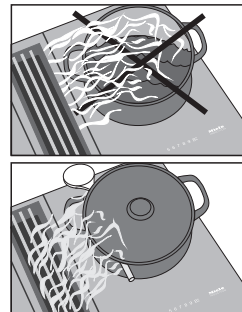

Useful tip: To help release vapours effectively with pans over 15 cm high, place a wooden spoon between the lid and the pan.

Cleaning and care

 Risk of burning due to hot surfaces.

The surfaces will be hot after use. Switch the downdraft extractor and the cooking elements off.

Allow the surfaces to cool down before cleaning the downdraft extractor.

 Risk of damage due to moisture ingress.

The steam from a steam cleaning appliance could reach electrical components and cause a short circuit.

Do not use a steam cleaner to clean the downdraft extractor.

The use of unsuitable cleaning agents can cause the surfaces to discolour or alter. All surfaces are susceptible to scratching.

Remove any residual cleaning agent immediately.

Never use abrasive sponges or cleaning agents.

Allow the SmartLine appliance to cool down before cleaning.

- Clean the SmartLine appliance and accessories after each use.
- Dry the SmartLine appliance thoroughly every time after cleaning to avoid limescale residue.

Unsuitable cleaning agents

To avoid damaging the surfaces of the appliance, do not use:

- washing-up liquid,
- cleaning agents containing soda, alkalines, ammonia, acids or chlorides,
- cleaning agents containing descaling agents,
- stain and rust removers,
- abrasive cleaning agents, e.g. powder cleaners and cream cleaners,
- solvent-based cleaning agents,
- dishwasher cleaner,
- grill and oven cleaners,
- glass cleaning agents,
- hard, abrasive brushes or sponges (e.g. pot scourers), or sponges which have been previously used and still contain abrasive cleaning agents,
- dirt erasers.

Cleaning the ceramic surface

⚠ Risk of damage by pointed objects.

The seal between the SmartLine element and the worktop could suffer damage.

Do not use pointed objects for cleaning.

Do not use washing-up liquid to clean the appliance. Using washing-up liquid will not remove all soiling and residues. An invisible film can develop that can lead to discolouration of the ceramic glass. This discolouration cannot be removed.

Clean the ceramic surface regularly with a proprietary ceramic glass cleaning agent.

- Remove any coarse soiling with a damp cloth and more stubborn soiling with a glass scraper.
- Then clean the ceramic glass surface with the Miele ceramic and stainless steel cooktop cleaner (see "Optional accessories") or with a proprietary ceramic glass cleaner applied with paper towel or a clean cloth. Please follow the cleaning agent manufacturer's instructions.
- Clean the ceramic surface with a damp cloth, and then wipe dry. Ensure that all cleaner residues are removed.
- Any **marks** left by limescale and water residues can be removed using Miele's ceramic and stainless steel cooktop cleaner.

Cleaning the drip tray

Clean the drip tray if liquids have boiled over or spilled into the downdraft extractor.

- Remove and clean the grease filter as described in "Grease filter / Extraction grille".

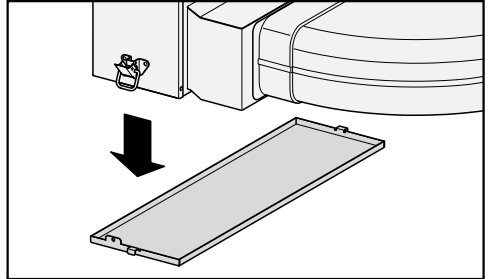

- Hold the drip tray and open the 2 clips (1x front, 1x rear). Carefully remove the tray from the casing, making sure it is kept horizontal.
- Pour out the liquid.
- Clean and dry the drip tray.
- Clean and dry the accessible inside of the downdraft extractor.
- Fasten the drip tray back onto the casing.
- Refit the grease filter and the cover.

Cleaning and care

Grease filter / Extraction grille

The extraction grille and the reusable metal grease filter in the downdraft extractor collect solid matter from kitchen vapours (grease, dust, etc.) and therefore prevent soiling of the downdraft extractor. Accumulated grease solidifies over a longer period of time and makes cleaning more difficult. The grease filter should therefore be cleaned at least every 3 to 4 weeks.



Risk of fire due to soiled grease filter.

Grease collected in the grease filter can ignite.

Clean the grease filter regularly.

Removing the grease filter

- Remove the FlameGuard if necessary.
- Lift up the extraction grille.
- Carefully remove the grease filter. Ensure that you do not tilt the grease filter.
- Pour out any liquid which has collected at the bottom of the grease filter.

Cleaning the grease filter and the extraction grille by hand

- Clean the extraction grille and the grease filter with a soft nylon brush in a mild solution of hot water and a little washing-up liquid. Do not use concentrated washing-up liquid.

Cleaning the grease filter and the extraction grille in the dishwasher

- Place the extraction grille upright in the lower basket.
- Place the grease filter with its base facing upwards in the lower basket. Ensure the spray arm is not obstructed.
- Use a standard household dishwasher detergent.
- Select a dishwasher programme with a maximum wash temperature of:
 - 55 °C for the extraction grille
 - 65 °C for the grease filter

Depending on the detergent used, cleaning the grease filter in a dishwasher can cause permanent discolouration to the internal surfaces of the filter. This will not affect the functioning of the grease filter in any way.

Fitting the grease filter

- Fit the grease filter so that the straight side of the grease filter is on the side that connects to the air duct.

Example: connector for air duct on the left

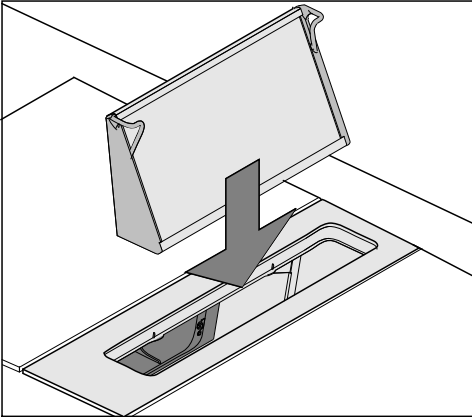

Interior of the casing

- When removing the grease filter for cleaning, also clean off any accessible oil or fat build-up from the casing. Doing so will prevent a fire hazard.

Problem solving guide

With the help of the following guide, minor faults in the performance of the appliance, some of which may result from incorrect operation, can be remedied without contacting Miele. This will save you time and money because you won't need a service call.

Please note that a call-out charge will be applied to unnecessary service visits where the problem could have been rectified as described in these operating instructions.

Problem	Possible cause and remedy
The power levels 1 to B light up one after the other.	An automatic reset is performed after an interruption to the power supply.
The SmartLine appliance cannot be switched on.	There is no power to the SmartLine appliance. ■ Check if the circuit breaker has tripped. Contact an electrician or Miele (for the minimum fuse rating, see data plate).
	There may be a technical fault. ■ Disconnect the SmartLine appliance from the mains electricity supply for approx. 1 minute by – switching off at the wall socket and withdrawing the plug, or – switching off the main circuit breaker or residual current device. ■ If, after resetting the fuse in the mains fuse box or the residual current protection device, the SmartLine appliance will still not switch on, contact a qualified electrician or Miele.

Miele offers a range of useful accessories, as well as cleaning and conditioning products for your appliance.

These products can be ordered from the Miele online shop.

They can also be ordered directly from Miele (see end of this booklet for contact details).

FlameGuard

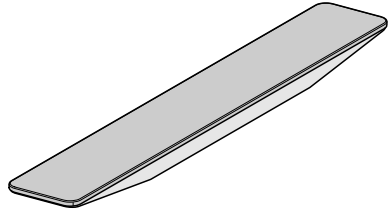

For fitting in place between the downdraft extractor and a gas cooking appliance.

Original Miele ceramic and stainless steel cooktop cleaner 250 ml



Removes heavy soiling, limescale deposits and aluminium residues.

Original Miele all purpose microfibre cloth

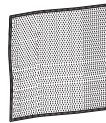

Removes finger marks and light soiling.

Service

Contact in case of fault

In the event of any faults which you cannot remedy yourself, please contact Miele.

You can book a Miele customer service call-out online at www.miele.com.au/service or www.miele.co.nz/service.

Contact information for Miele can be found at the end of this booklet.

Please quote the model and serial number of your appliance when contacting Miele. This information can be found on the data plate.

Data plate

Adhere the extra data plate supplied with the appliance in the space below. Make sure that the model number matches the one specified on the back cover of these operating and installation instructions.

Warranty

The manufacturer's warranty for this appliance is 2 years.

For further information, please refer to your warranty booklet.

Safety instructions for installation



Risk of damage from incorrect installation.

Incorrect installation can cause damage to the SmartLine appliance.

The SmartLine appliance must only be installed by a suitably qualified and competent person.



Damage from falling objects.

Take care not to damage the SmartLine appliance when fitting wall units above it.

Fit the wall units before the SmartLine appliance.

► After installation, the mains connection cable of the SmartLine appliance must not come into contact with any moving kitchen component (e.g. a drawer) or be subject to mechanical loads which could damage it.

► Combination with gas appliances

Only Miele CS 7xxx gas appliances may be installed next to the downdraft extractor.

► Carefully observe the safety clearances listed on the following pages.

► All pipework, ducting and fittings must be of non-flammable material and comply with all relevant national and local building regulations.

► The appliance must not be connected to a chimney or vent flue which is in current use for exhausting fumes from appliances burning gas or other fuels. Neither should it be connected to ducting which ventilates rooms with fireplaces.

► If exhaust air is to be extracted into a chimney or ventilation duct no longer used for other purposes, seek professional advice.

Installation

Installation examples

Recirculation mode

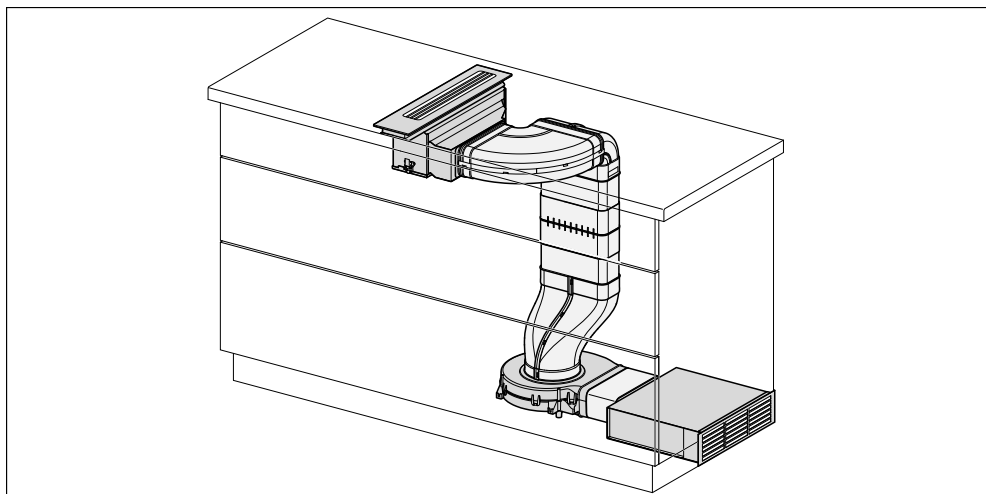

Air extraction mode

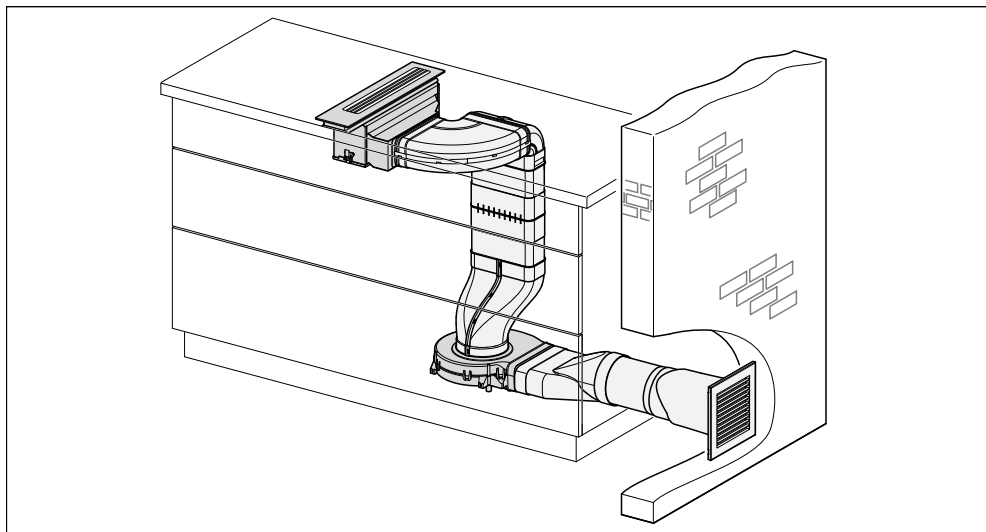

Installation notes – surface-mounted

Sealing between the SmartLine appliance and the worktop

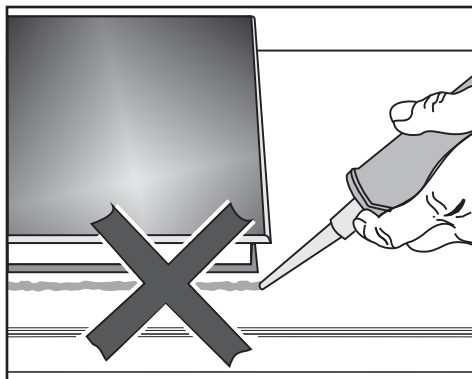

The SmartLine appliance and worktop may be damaged if the appliance needs to be removed after it has been sealed with a sealant.

Do not use any sealant between the SmartLine appliance and the worktop.

The sealing strip under the edge of the top part of the appliance provides a sufficient seal for the worktop.

Tiled worktop

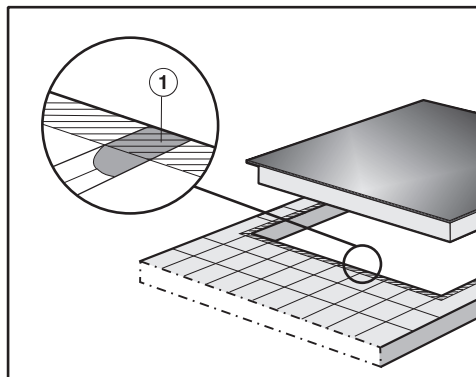

Grout lines ① and the hatched area underneath the SmartLine appliance frame must be smooth and even. If they are not, the SmartLine appliance will not sit flush with the worktop and the sealing strip underneath the top part of the appliance will not provide a good seal between the appliance and the worktop.

Sealing strip

Dismantling the SmartLine appliance for service purposes may damage the sealing strip underneath the edge of the SmartLine appliance.

Always replace the sealing strip before reinstalling the cooktop.

Installation

Installing several SmartLine appliances

The gaps between the individual SmartLine appliances must be sealed with a silicone sealant that is heat-resistant to at least 160 °C. With flush-fit installation, the gap between the SmartLine appliance(s) and the worktop must also be sealed with a silicone sealant that is heat-resistant to at least 160 °C.

After installation, the SmartLine appliances must be easily accessible from below, so that the bottom half of the casing can be removed for maintenance. If the SmartLine appliances are not accessible from below, the sealant must be removed so that they can be removed.

Worktop depth

The downdraft extractor can be installed with the connector for the air duct on either the right or the left-hand side.

Minimum worktop depth for





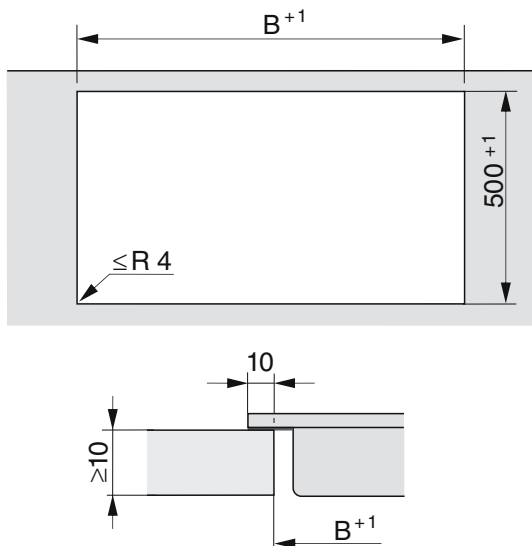

- right connector 600 mm
- left connector 665 mm

Worktop cut-out – surface-mounted

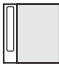

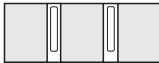





Installation

Installation with a downdraft extractor

Sample combinations	Number x width [mm]		Dimension B [mm]
	Cooking appliances	Downdraft extractor	
	1 x 378	1 x 120	481
	2 x 378	1 x 120	862
	1 x 378 1 x 620	2 x 120	1226
	3 x 378	2 x 120	1365
	2 x 378 1 x 620	2 x 120	1607
	4 x 378	2 x 120	1746
	1 x 620	2 x 120	845

Installation without a downdraft extractor

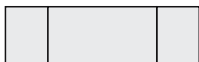
Sample combinations	Number x width [mm] Cooking appliances	Dimension B [mm]
	1 x 378	359
	2 x 378	740
	1 x 378 1 x 620	982
	3 x 378	1121
	2 x 378 1 x 620	1363
	4 x 378	1502
	2 x 378 1 x 800	1554
	2 x 378 1 x 936	1680

Installation

Spacer bars – surface-mounted

If you are installing several appliances, you must fit spacer bars between them.

The clips supplied with the spacer bars are only required for installing a CSDA 700x FL.

Installing 3 appliances and 2 spacer bars

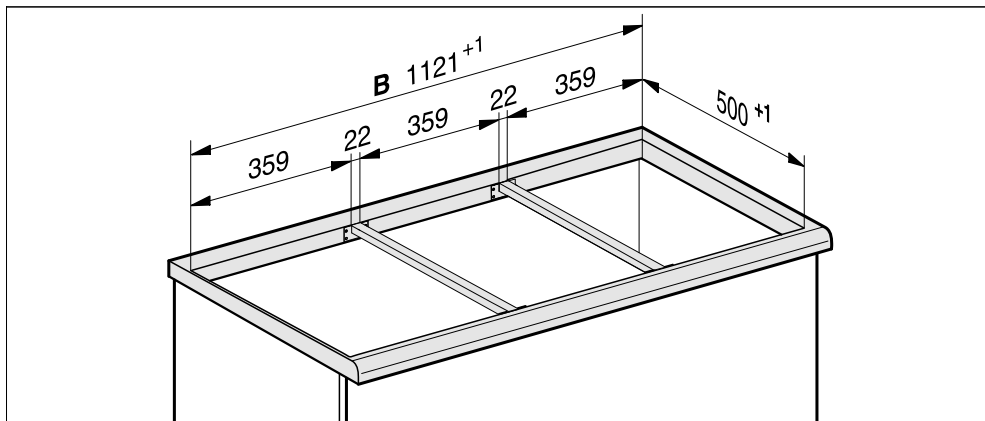

Spacer bars for the downdraft extractor – surface-mounted

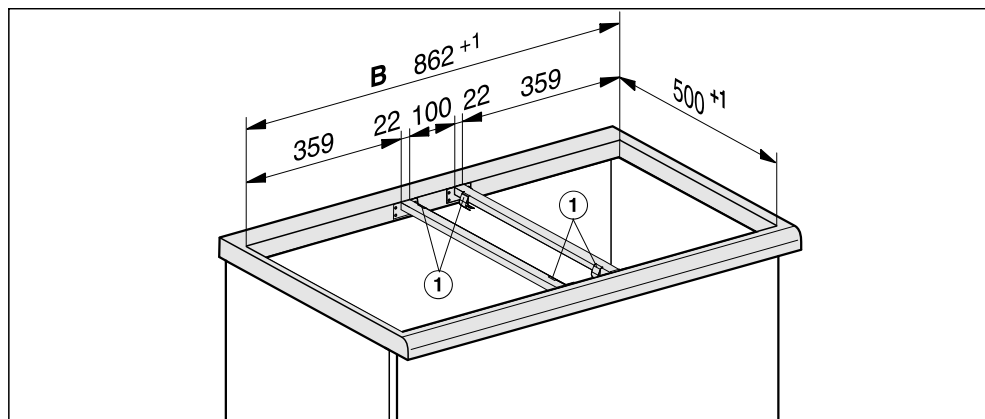

① Brackets

Installation dimensions – Surface-mounted

All dimensions in this instruction booklet are given in mm.

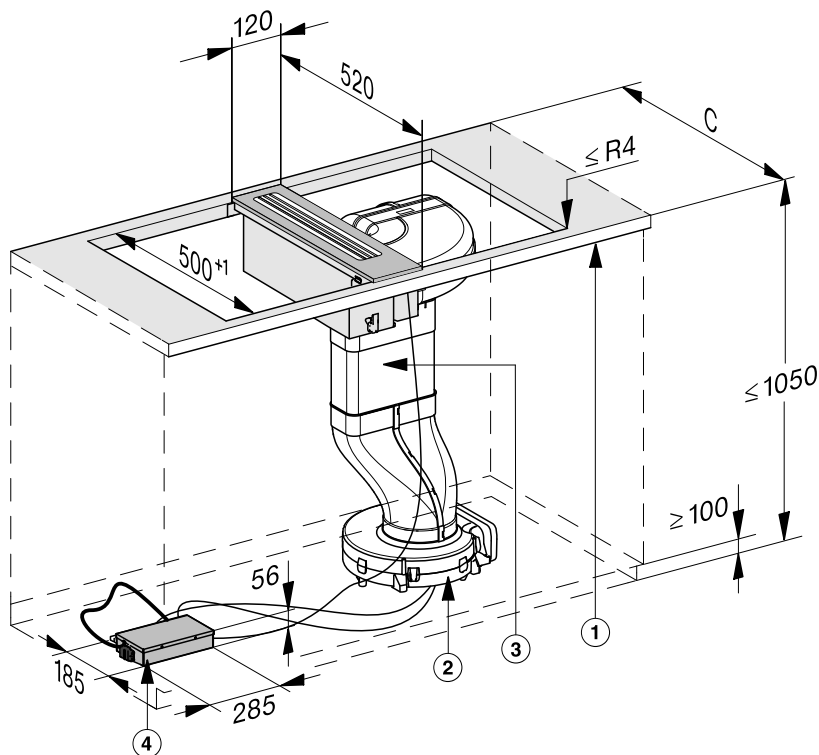

- ① Front
- ② Fan
In the plinth on the floor
- ③ Air duct
(accessory supplied)
- ④ E-box

Installation

Air duct dimensions – surface-mounted – worktop depth 600 mm

Side view

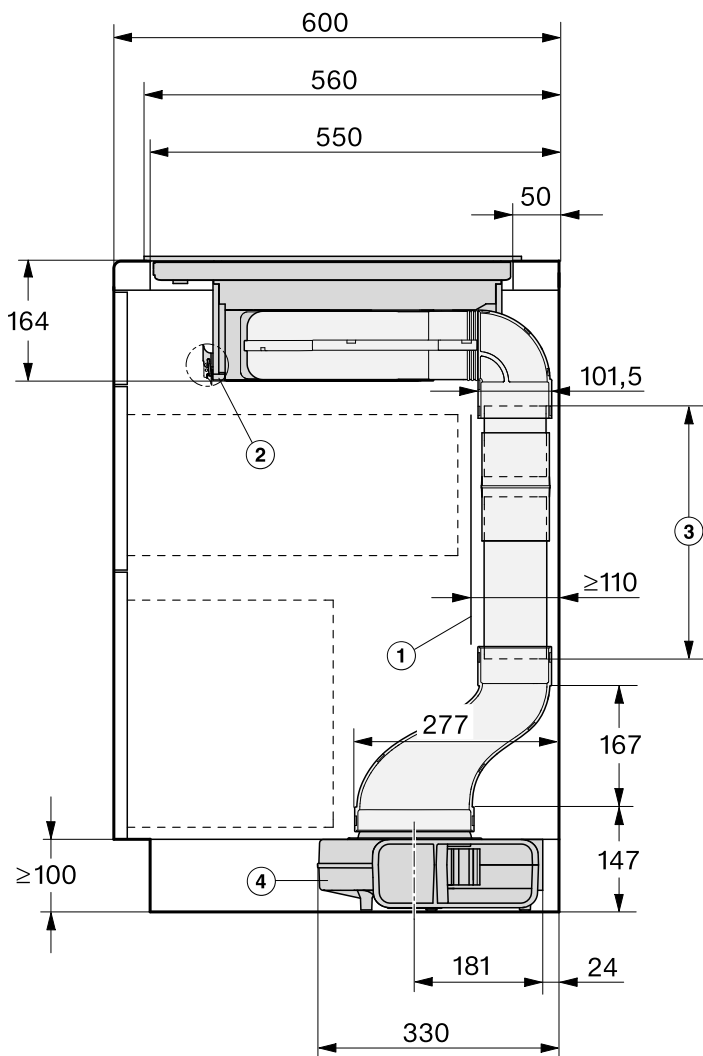

- ① For maintenance work, it must be possible to remove the rear cabinet wall.
The cabinet wall and an adjoining room wall or a piece of furniture must be at least 110 mm apart to ensure sufficient room for the exhaust ducting.
- ② After installation the removable drip tray must be accessible from below.
Two quick-release catches have to be opened at the front and rear to remove the tray.
- ③ Duct length must be adapted to the height of the base unit.
Standard delivery 500 mm
Installing the length compensation, see “Installation – Installation – surface-mounted”.
- ④ Fan
In the plinth on the floor

Installation

Front view

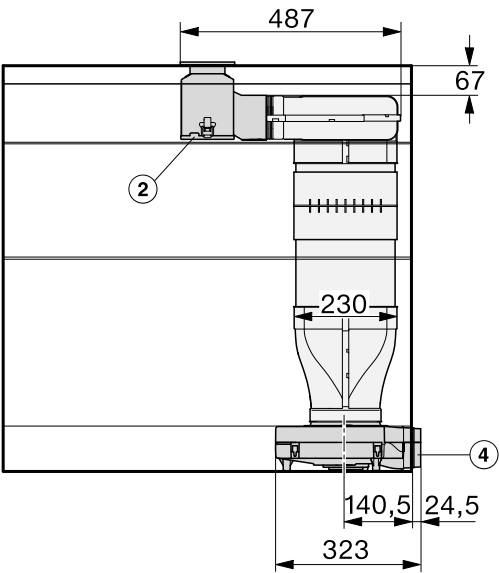

View from above

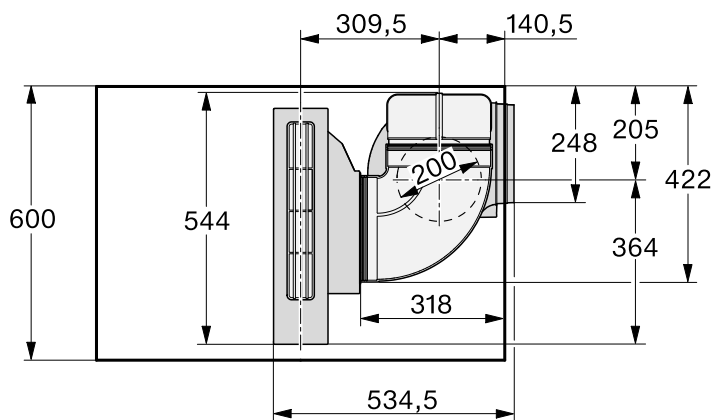

Installation

Air duct dimensions – surface-mounted – worktop depth greater than 600 mm

View from the side – right air duct connection

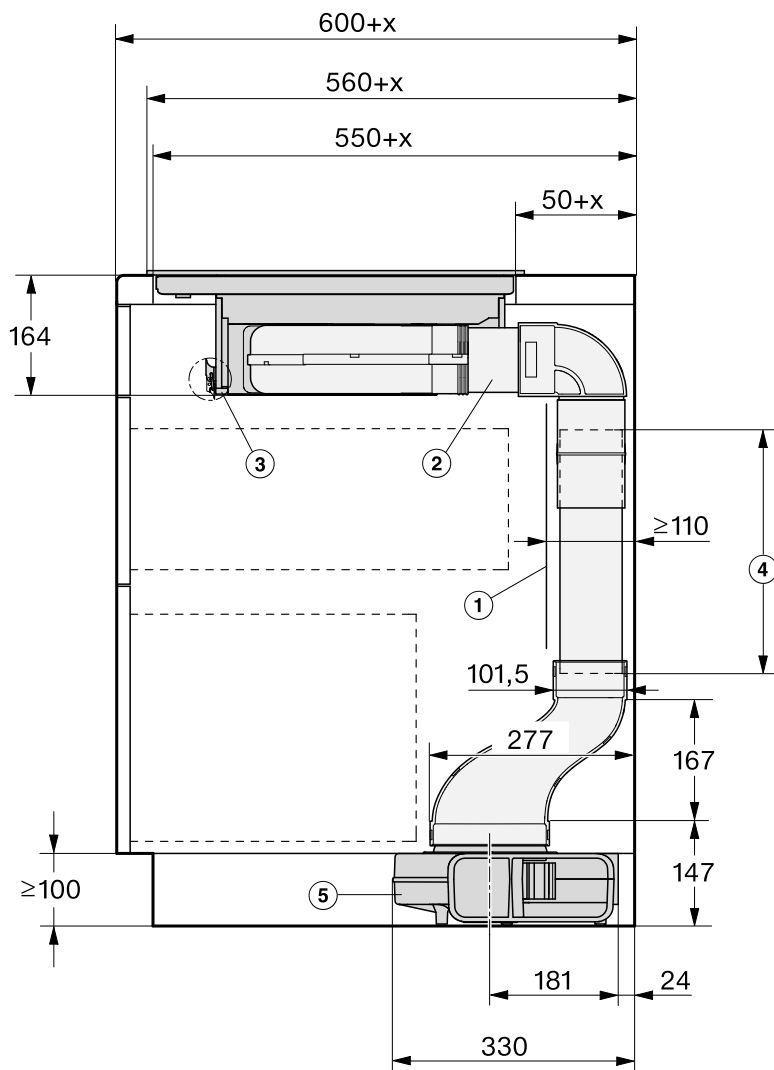

- ① For maintenance work, it must be possible to remove the rear cabinet wall.
The cabinet wall and an adjoining room wall or a piece of furniture must be at least 110 mm apart to ensure sufficient room for the exhaust ducting.
 - ② Duct connector, adapted to the worktop depth
 - ③ After installation the removable drip tray must be accessible from below.
Two quick-release catches have to be opened at the front and rear to remove the tray.
 - ④ Duct length must be adapted to the height of the base unit.
Standard delivery 500 mm
Installing the length compensation, see “Installation – Installation – surface-mounted”.
 - ⑤ Fan
In the plinth on the floor
- x Dimension of which the worktop is deeper than 600 mm.

Installation

View from the front – right air duct connection

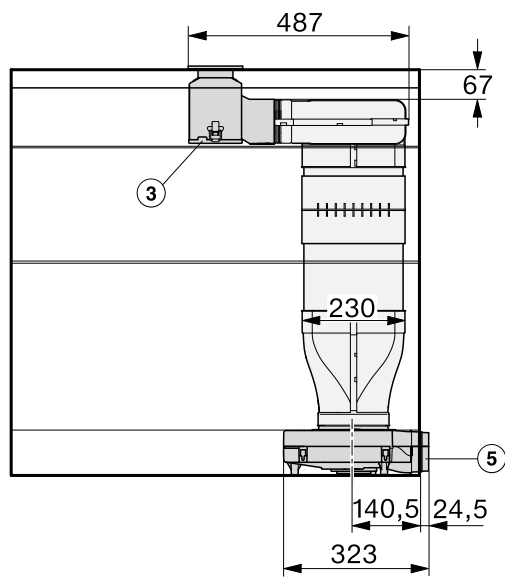

View from above – right air duct connection

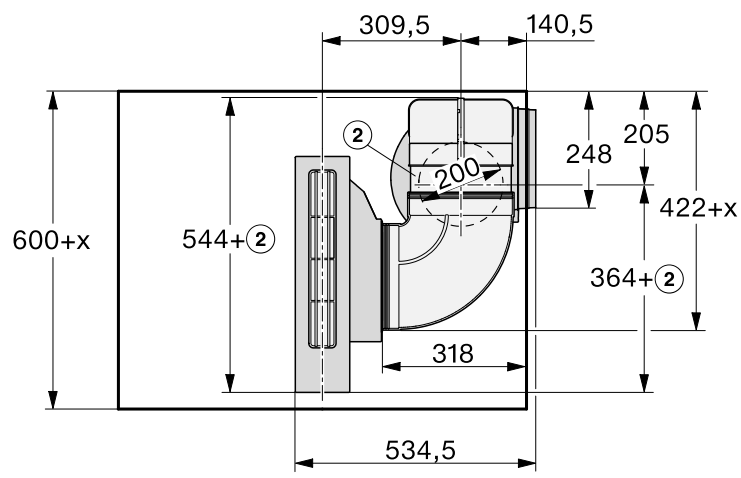

If you want to install the air duct to the left of the downdraft extractor, the worktop must be at least 665 mm deep.

View from the front – left air duct connection

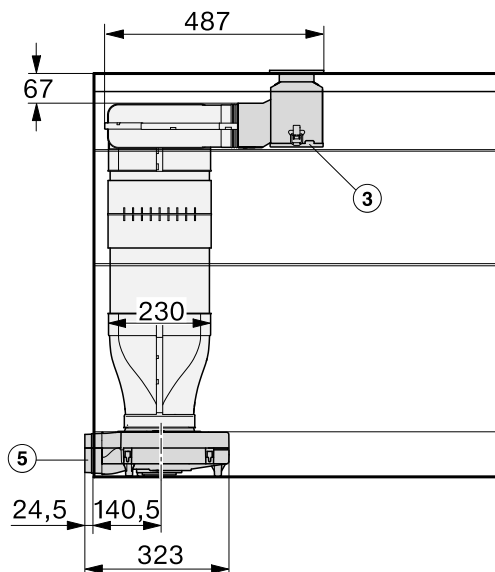

View from above – left air duct connection

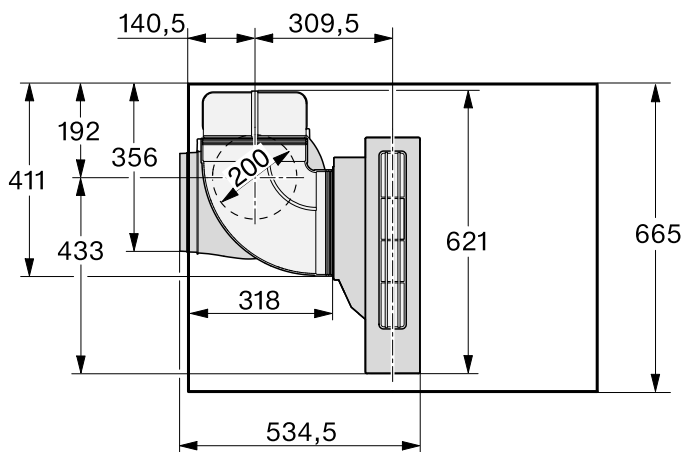

Installation

Installation – surface-mounted

If the worktop is more than 24 mm deep, it must be cut out underneath on the building-in side on the right or left-hand side.

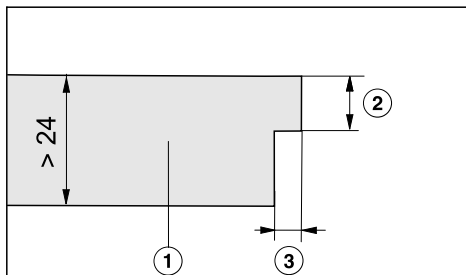

- ① Worktop
- ② Maximum 24 mm
- ③ 12 mm

Securing the bracket

1 bracket (supplied with the spacer bar) must be secured centrally to the right or left-hand side of the cut-out.

Wooden worktops

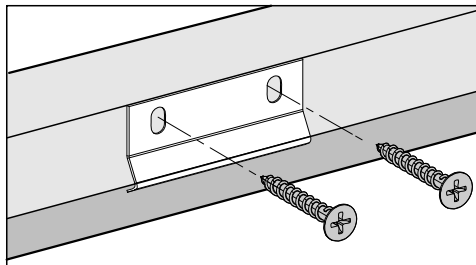

- Fit the bracket so that it sits flush with the top edge of the worktop cut-out.
- Secure the bracket with the 3.5 x 25 mm wood screws supplied.

Granite and marble worktops

You will need heavy-duty double-sided tape (not supplied) to secure the bracket.

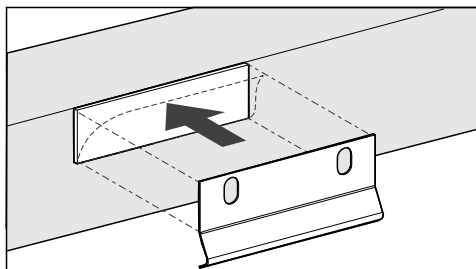

- Stick the tape along the top edge of the worktop cut-out.
- Fit the bracket so that it sits flush with the top edge of the worktop cut-out.
- Press the bracket firmly into position.

Preparing the worktop

- Create the worktop cut-out.
Remember to maintain the minimum safety distances (see "Installation – Safety distances").
- Seal the cut surfaces of **wooden worktops** with a suitable sealant to avoid swelling caused by moisture. The sealant must be heat-resistant.

Make sure the sealant does not come into contact with the top surface of the worktop.

Fitting the spacer bars

Use the middle screw holes if one of the following SmartLine appliances is installed to the right or left of the spacer bar: CS 7611, CS 7641, CS 7101(-1), CS 7102(-1)

Wooden worktops

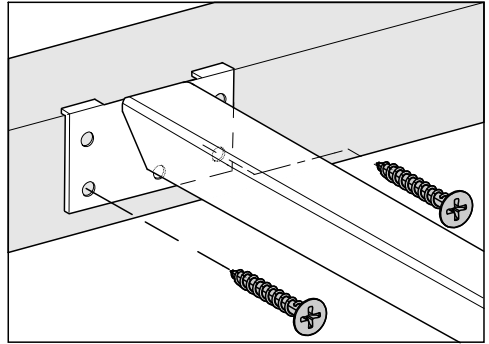

- Position the spacer bars flush onto the upper edge of the cut-out.
- Secure the spacer bars with the 3.5 x 25 mm wood screws supplied.

Granite and marble worktops

You will need heavy-duty double-sided tape (not supplied) to secure the spacer bars.

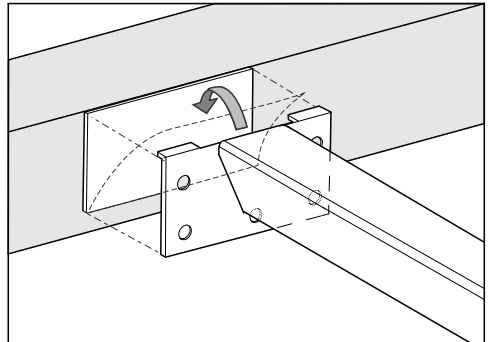

- Stick the tape along the top edge of the worktop cut-out.
- Position the spacer bars flush onto the upper edge of the cut-out.
- Press the spacer bars firmly into place.

Installation

Installing the downdraft extractor

The downdraft extractor can be installed with the connector for the air duct on either the right or the left-hand side.

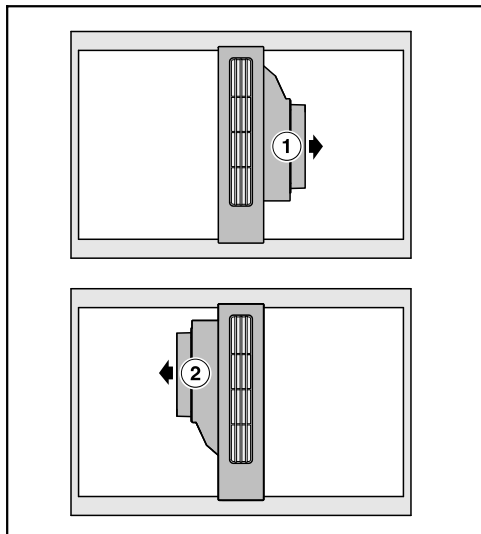

- ① Connector for air duct on the right
- ② Connector for air duct on the left

- Stick the supplied sealing strip under the edge of the cover. Do not apply the sealing strip under tension.
- Fit the clips onto the spacer bars.
- Guide the control cable downwards between the spacer bars.
- Fit the cover onto the spacer bars.

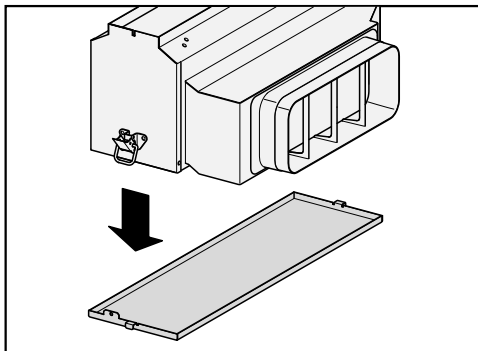

- Remove the drip tray from the casing.

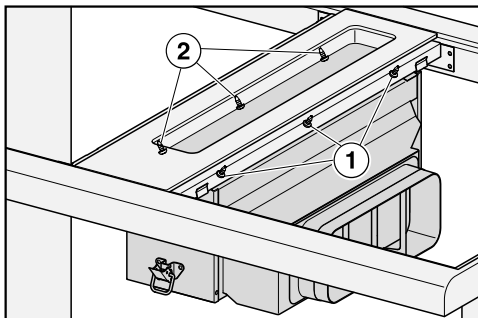

- Fasten the casing from the inside with the screws on the right ① and left ② sides (3 in each case).
- Fasten the drip tray.

Installing the air duct

- Mount the air duct.

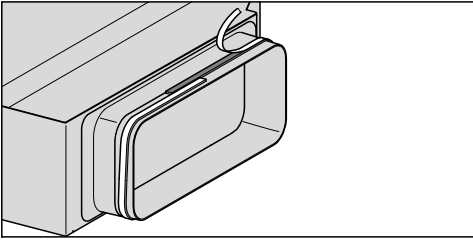

- Stick the supplied sealing strip on the exhaust connection if the ducting does not sit securely up against the exhaust connection.

Ensure that the air duct is not under mechanical tension after installation.

Length compensation

The length compensation ④ facilitates customer service and repair work. The installation position of the length compensation depends on the worktop depth.

Length compensation – worktop depth 600 mm

Length compensation does not fit. The duct piece ② must be at least 100 mm long.

- Divide the flat ducting into 2 pieces to suit your installation situation. The upper piece must have a minimum length of 100 mm.

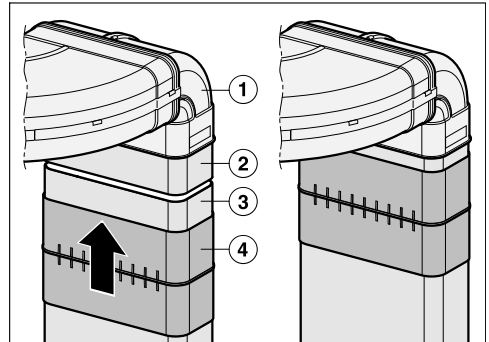

- Insert the short bend ① into the horizontal bend.
- Connect the duct piece ② to the short bend ①. Fix the connection with the sealing strip.
- Adapt the remaining duct piece ③ to the height of the base unit.
- Slide the length compensation ④ over the adapted duct piece ③. Hold the adapted duct piece ③ under the duct piece on the bend ②. Slide the length compensation ④ over the duct piece on the bend ②. Fix the connection with the sealing strip.

Installation

Length compensation – worktop depth greater than 600 mm

- Divide the flat ducting into 2 pieces. 1 piece must correspond to the difference between 600 mm and the worktop depth.

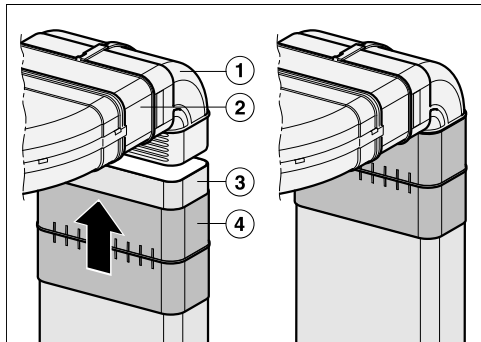

- Insert the duct piece (2) into the horizontal bend.
- Connect the duct piece (2) to the short bend (1). Fix the connection with the sealing strip.
- Adapt the remaining duct piece (3) to the height of the base unit.
- Slide the length compensation (4) over the adapted duct piece (3). Hold the adapted duct piece (3) under the short bend (1). Slide the length compensation (4) over the short bend (1) from below. Fix the connection with the sealing strip.

Installing the fan motor

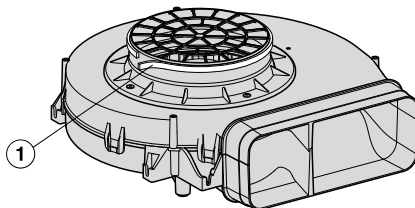

- ① Sealing strip

- Stick the sealing strip supplied to the fan connection.

E-box

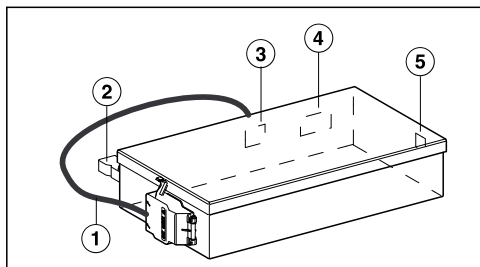

- ① Mains connection cable
- ② Connection to window contact
- ③ Connection socket for the fan power cable
- ④ Connection socket for the fan control cable
- ⑤ Connection socket for the control unit cable

Connection to window contact, if required

⚠ The window contact is connected to the mains voltage. Danger of electric shock! Disconnect the downdraft extractor from the mains electricity supply before connecting the switching system.

The connection cable of the switching system must only be connected by a suitably qualified and competent electrician.

The connection cable of the switching system must be of the correct type and cross-sectional area in strict accordance with current national and local safety regulations and must not exceed 2.0 m in length. The switching system must be equipped with a potential-free contact suitable for 230 V, 1 A. The extractor is switched off when the switch is open.

Only use suitable switching systems (e.g. window contact switches, pressure switches).

The switching system must be suitable for use with inductive loads (BLDC motor).

Use switching systems in strict accordance with current national and local safety regulations.

Installation

- Loosen the lug and pull the plug out.

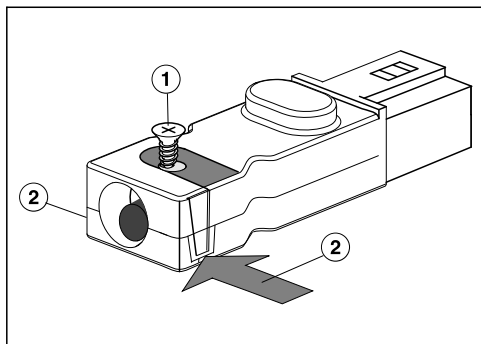

- Loosen the strain relief screw ① and unlock the casing on both sides ②.
- Open the casing.
- Remove the stopper.

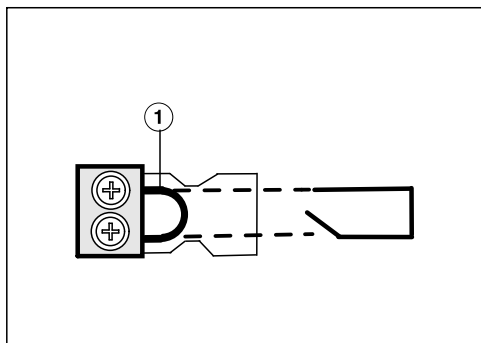

- Exchange the jumper ① with the connection cable of the switching system.
- Close the casing.
- Tighten the strain relief screw.
- Reinsert the plug.

Connecting the e-box

- Connect the fan power cable and fan control cable to the e-box and the fan.
- Connect the control unit cable to the e-box.

The socket positions are designed in such a way that they cannot be mixed up.

- Connect the downdraft extractor to the mains electricity supply.
- Check that the downdraft extractor works.

Sealing the gaps

- Seal the gaps between the individual SmartLine appliances, and between the flush-fit SmartLine appliances and the worktop, with a silicone sealant that is heat-resistant to at least 160 °C.

Unsuitable sealant can damage natural stone.

For natural stone worktops and natural stone tiles, only use silicone sealant that is specially formulated for natural stone.

Please follow the manufacturer's instructions.

Installation notes – flush-fit

Flush-fit installation is only possible in natural stone (granite, marble), solid wood and tiled worktops. For installation in worktops made of other materials, please consult the relevant manufacturer as to whether their worktops are suitable for flush-fit installation.

The internal width of the base unit underneath the appliance must be at least as wide as the inner worktop cut-out (see “Installation – Installation dimensions – Flush”), so that the SmartLine appliance is easily accessible from underneath after installation and the bottom half of the casing can be removed for maintenance. If the appliance is not freely accessible from below after installation, the sealant must be removed so that the appliance can be removed.

Natural stone worktops

The SmartLine appliance is set directly in the cut-out.

Solid wood worktops, tiled worktops, glass worktops

The SmartLine appliance is set on a wooden frame inside the cut-out. The frame must be provided on site and is not supplied with the appliance.

Sealing strip

Dismantling the SmartLine appliance for service purposes may damage the sealing strip underneath the edge of the SmartLine appliance.

Always replace the sealing strip before reinstalling the cooktop.

Installation

Installing several SmartLine appliances

The gaps between the individual SmartLine appliances must be sealed with a silicone sealant that is heat-resistant to at least 160 °C. With flush-fit installation, the gap between the SmartLine appliance(s) and the worktop must also be sealed with a silicone sealant that is heat-resistant to at least 160 °C.

After installation, the SmartLine appliances must be easily accessible from below, so that the bottom half of the casing can be removed for maintenance. If the SmartLine appliances are not accessible from below, the sealant must be removed so that they can be removed.

Worktop depth

The downdraft extractor can be installed with the connector for the air duct on either the right or the left-hand side.

Minimum worktop depth for

- right connector 600 mm
- left connector 665 mm

Worktop cut-out – flush-fit

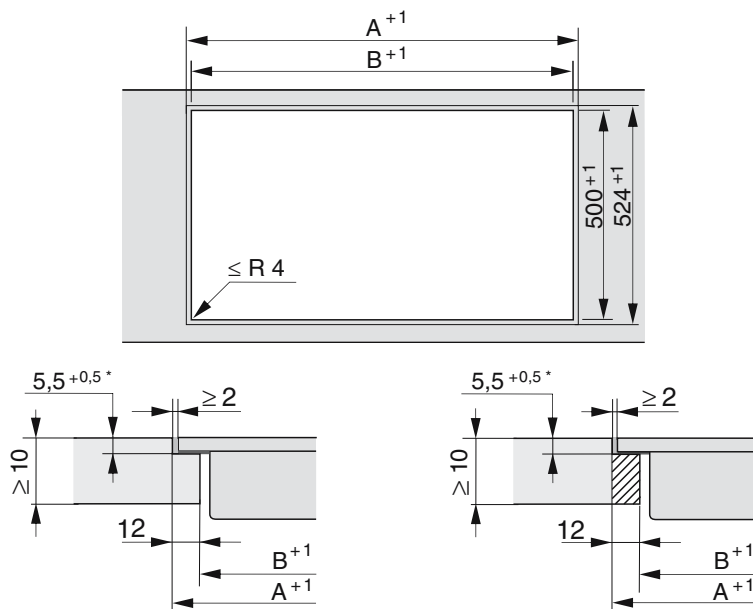







Natural stone worktop

Wooden worktop

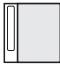
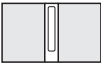







* $7^{+0,5}$ mm with CS 7611 FL

Installation

Installation with a downdraft extractor

Sample combinations	Number x width [mm]		Dimension A [mm]	Dimension B [mm]
	Cooking appliances	Downdraft extractor		
	1 x 378	1 x 120	505	481
	2 x 378	1 x 120	886	862
	1 x 378 1 x 620	2 x 120	1250	1226
	3 x 378	2 x 120	1389	1365
	2 x 378 1 x 620	2 x 120	1631	1607
	4 x 378	2 x 120	1770	1746
	1 x 620	2 x 120	869	845

Installation without a downdraft extractor

Sample combinations	Number x width [mm] Cooking appliances	Dimension A [mm]	Dimension B [mm]
	1 x 378	383	359
	2 x 378	764	740
	1 x 378 1 x 620	1006	982
	3 x 378	1145	1121
	2 x 378 1 x 620	1387	1363
	4 x 378	1526	1502
	2 x 378 1 x 800	1567	1543
	2 x 378 1 x 936	1703	1679

Installation

Spacer bars – flush-fit

If you are installing several appliances, you must fit spacer bars between them.

The clips supplied with the spacer bars are only required for installing a CSDA 700x FL.

Installing 3 appliances and 2 spacer bars

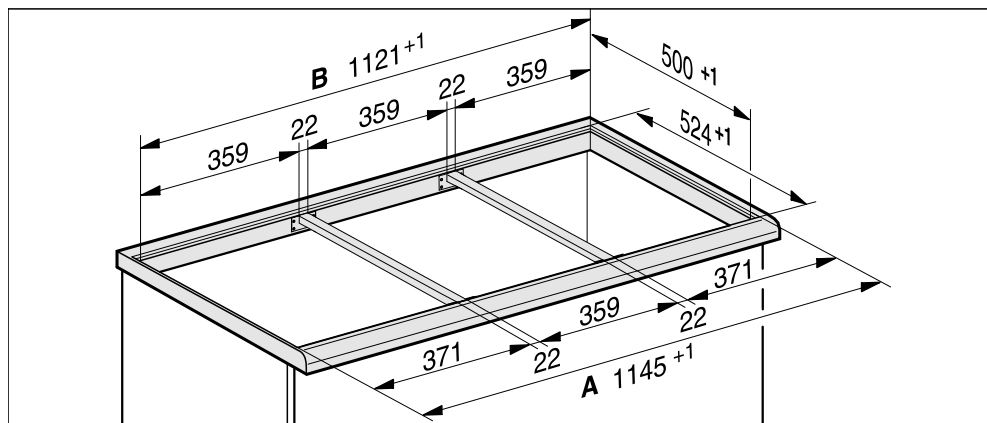

Spacer bars for the downdraft extractor – flush-fit

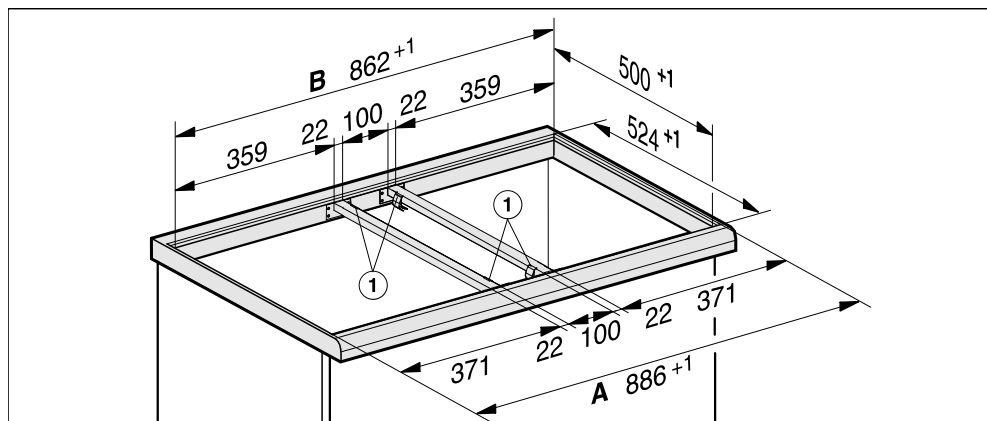

① Brackets

Installation dimensions – Flush-fit

All dimensions in this instruction booklet are given in mm.

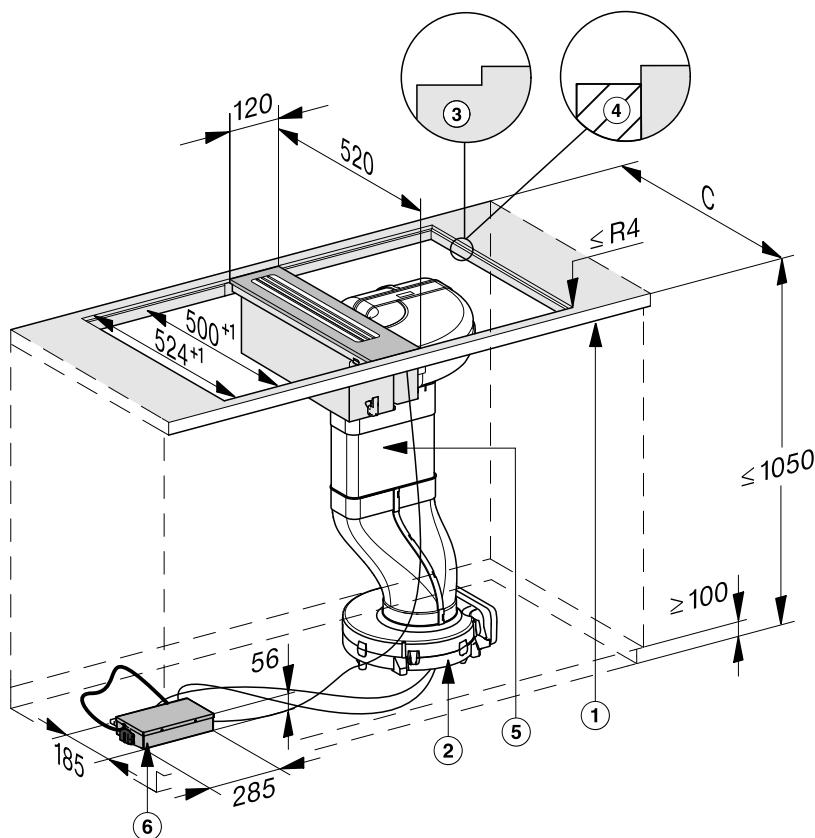

- ① Front
- ② Fan
In the plinth on the floor
- ③ Stepped cut-out (for detailed illustrations, see “Installation – Worktop cut-out – flush-fit”)
- ④ 12 mm wooden frame (not supplied, for detailed illustrations, see “Installation – Worktop cut-out – flush-fit”)
- ⑤ Air duct
(accessory supplied)
- ⑥ E-box

Installation

Air duct dimensions – flush-fit – worktop depth 600 mm

Side view

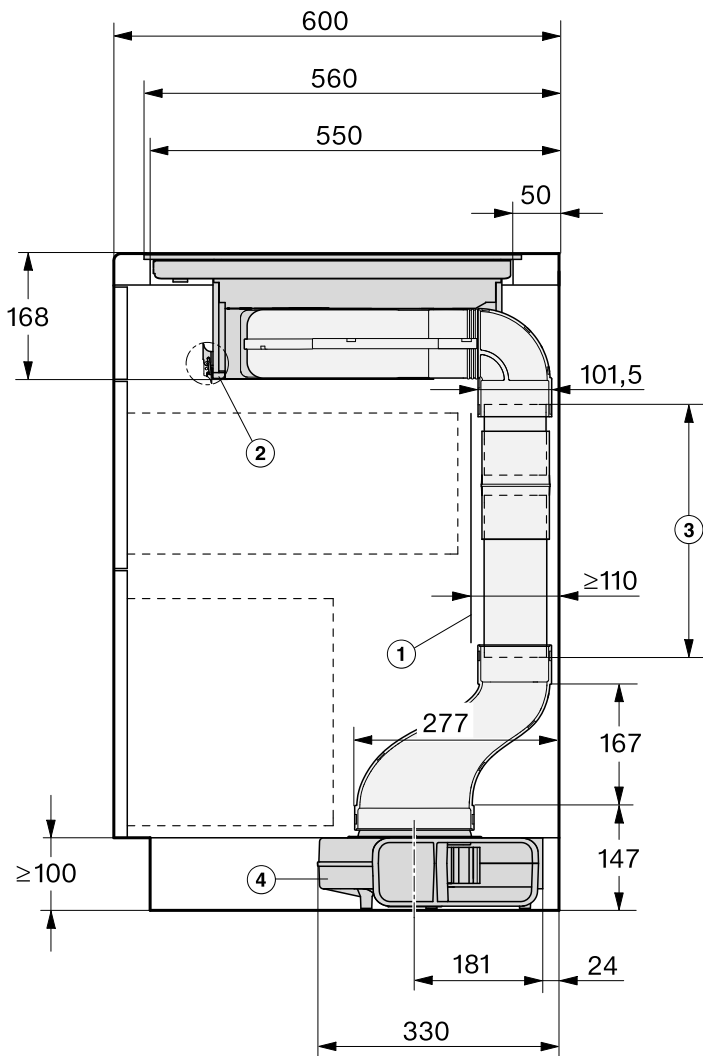

- ① For maintenance work, it must be possible to remove the rear cabinet wall.
The cabinet wall and an adjoining room wall or a piece of furniture must be at least 110 mm apart to ensure sufficient room for the exhaust ducting.
- ② After installation the removable drip tray must be accessible from below.
Two quick-release catches have to be opened at the front and rear to remove the tray.
- ③ Duct length must be adapted to the height of the base unit.
Standard delivery 500 mm
Installing the length compensation, see chapter “Installation – Installation – flush-fit”.
- ④ Fan
In the plinth on the floor

Installation

Front view

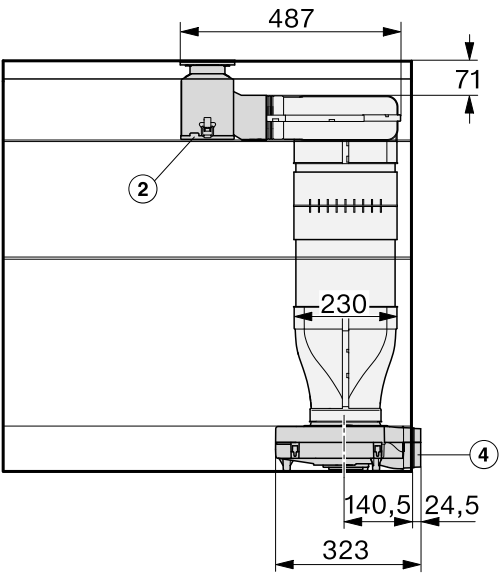

View from above

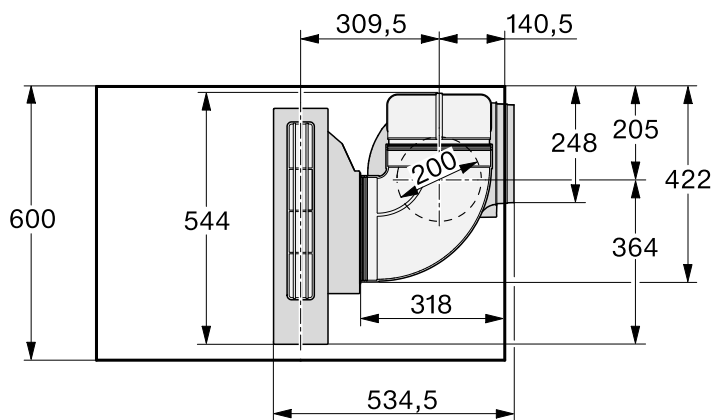

Installation

Air duct dimensions – flush-fit – worktop depth greater than 600 mm

View from the side – right air duct connection

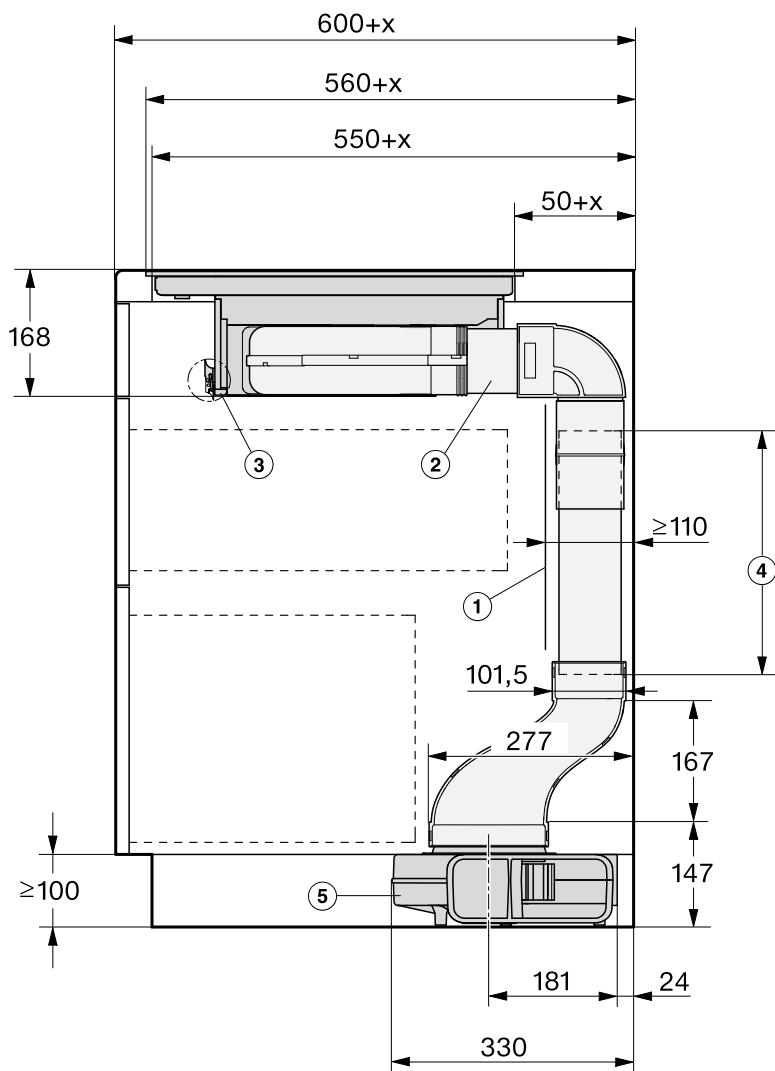

- ① For maintenance work, it must be possible to remove the rear cabinet wall.
The cabinet wall and an adjoining room wall or a piece of furniture must be at least 110 mm apart to ensure sufficient room for the exhaust ducting.
 - ② Duct connector, adapted to the worktop depth
 - ③ After installation the removable drip tray must be accessible from below.
Two quick-release catches have to be opened at the front and rear to remove the tray.
 - ④ Duct length must be adapted to the height of the base unit.
Standard delivery 500 mm
Installing the length compensation, see chapter “Installation – Installation – flush-fit”.
 - ⑤ Fan
In the plinth on the floor
- x Dimension of which the worktop is deeper than 600 mm.

Installation

View from the front – right air duct connection

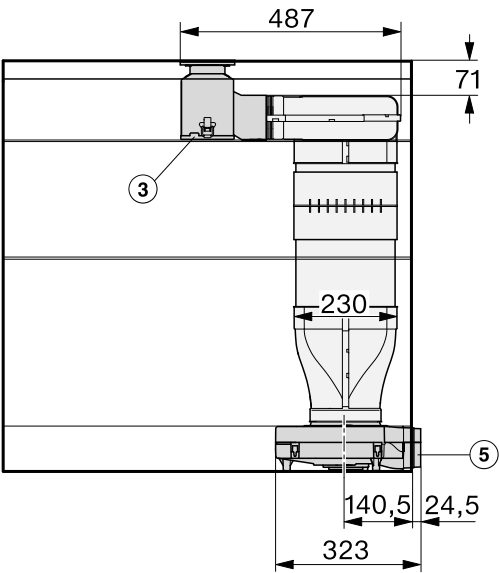

View from above – right air duct connection

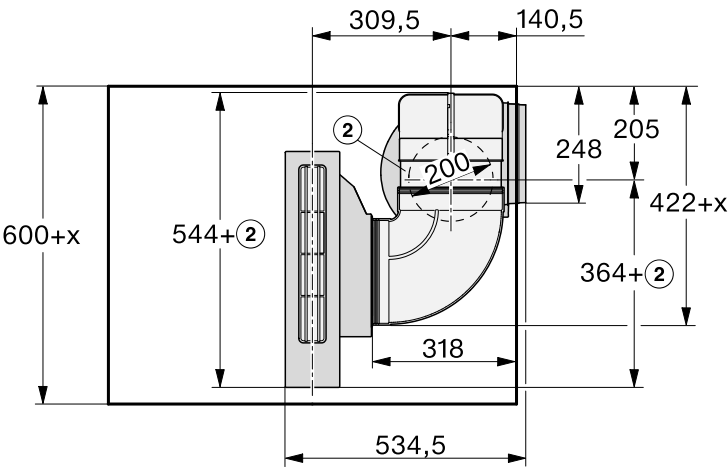

If you want to install the air duct to the left of the downdraft extractor, the worktop must be at least 665 mm deep.

View from the front – left air duct connection

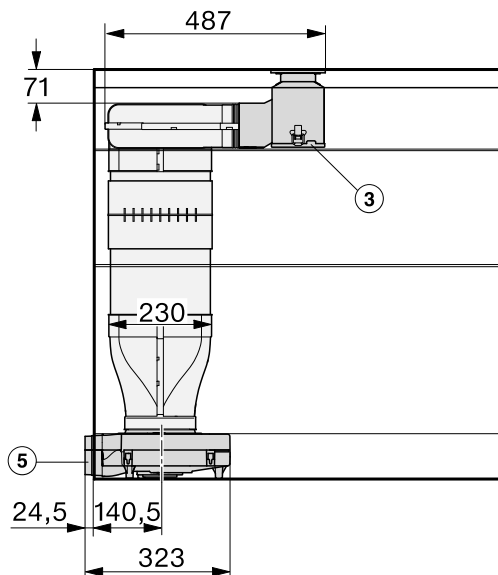

View from above – left air duct connection

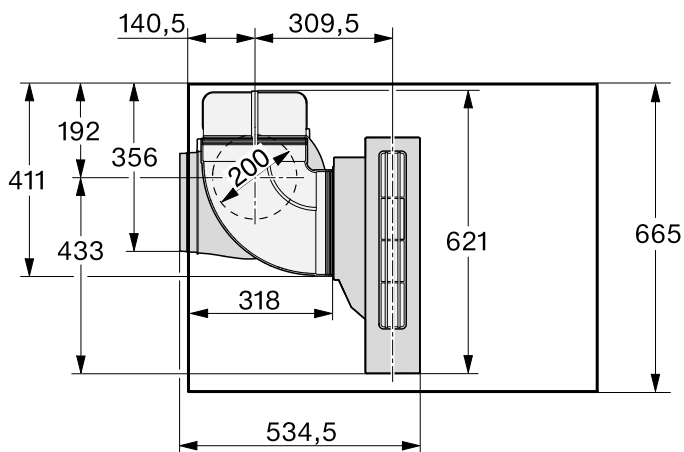

Installation

Installation – flush-fit

If the worktop is more than 28 mm deep, it must be cut out underneath on the building-in side on the right or left-hand side.

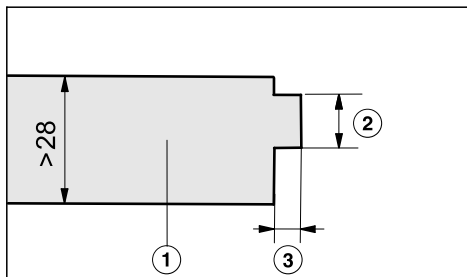

- ① Worktop
- ② Maximum 24 mm
- ③ 12 mm

Securing the bracket

1 bracket (supplied with the spacer bar) must be secured centrally to the right or left-hand side of the cut-out.

Wooden worktops

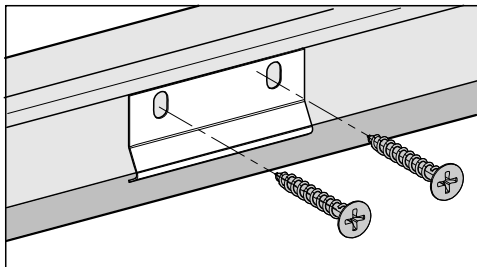

- Fit the bracket so that it sits flush with the top edge of the lower step of the stepped cut-out.
- Secure the bracket with the 3.5 x 25 mm wood screws supplied.

Granite and marble worktops

You will need heavy-duty double-sided tape (not supplied) to secure the bracket.

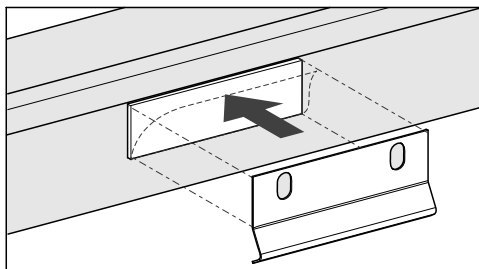

- Stick the tape onto the upper edge of the lower step of the stepped cut-out.
- Fit the bracket so that it sits flush with the top edge of the lower step of the stepped cut-out.
- Press the bracket firmly into position.

Preparing the worktop

- Create the worktop cut-out.
Remember to maintain the minimum safety distances (see "Installation – Safety distances").
- Seal the cut surfaces of **wooden worktops** with a suitable sealant to avoid swelling caused by moisture. The sealant must be heat-resistant.

Make sure the sealant does not come into contact with the top surface of the worktop.

- For wooden worktops, secure the wooden frames 5.5 mm below the upper edge of the worktop.
For CS 7611 FL, the wooden frame must be secured 7 mm under the upper edge of the worktop.

Fitting the spacer bars

Use the middle screw holes if one of the following SmartLine appliances is installed to the right or left of the spacer bar: CS 7611, CS 7641, CS 7101(-1), CS 7102(-1)

Wooden worktops

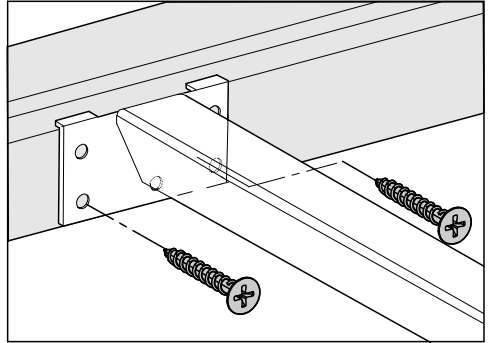

- Position the spacer bars flush onto the lower step of the stepped cut-out.
- Secure the spacer bars with the 3.5 x 25 mm wood screws supplied.

Granite and marble worktops

You will need heavy-duty double-sided tape (not supplied) to secure the spacer bars.

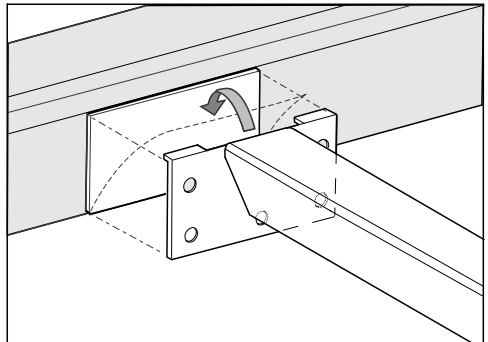

- Stick the tape onto the lower step of the stepped cut-out.
- Position the spacer bars flush onto the lower step of the stepped cut-out.
- Press the spacer bars firmly into place.

Installation

Installing the downdraft extractor

The downdraft extractor can be installed with the connector for the air duct on either the right or the left-hand side.

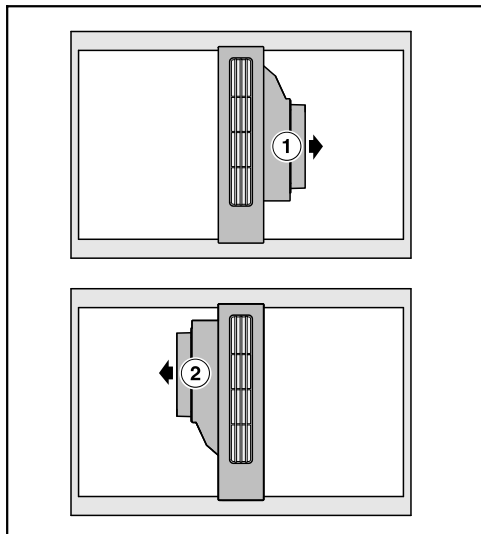

- ① Connector for air duct on the right
- ② Connector for air duct on the left

- Stick the supplied sealing strip under the edge of the cover. Do not apply the sealing strip under tension.
- Fit the clips onto the spacer bars.
- Guide the control cable downwards between the spacer bars.
- Fit the cover onto the spacer bars.

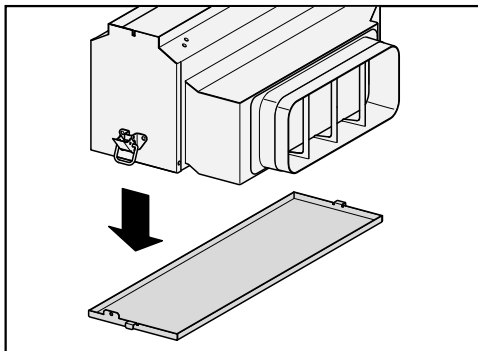

- Remove the drip tray from the casing.

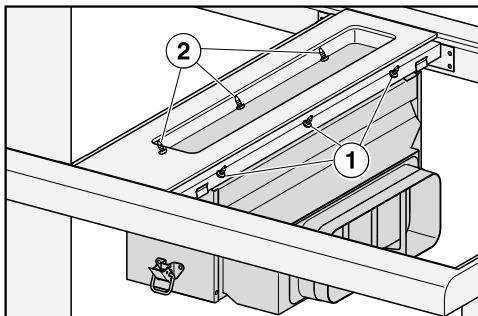

- Fasten the casing from the inside with the screws on the right ① and left ② sides (3 in each case).
- Fasten the drip tray.

Installing the air duct

- Mount the air duct.

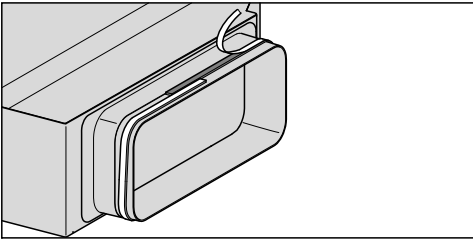

- Stick the supplied sealing strip on the exhaust connection if the ducting does not sit securely up against the exhaust connection.

Ensure that the air duct is not under mechanical tension after installation.

Length compensation

The length compensation ④ facilitates customer service and repair work. The installation position of the length compensation depends on the worktop depth.

Length compensation – worktop depth 600 mm

Length compensation does not fit. The duct piece ② must be at least 100 mm long.

- Divide the flat ducting into 2 pieces to suit your installation situation. The upper piece must have a minimum length of 100 mm.

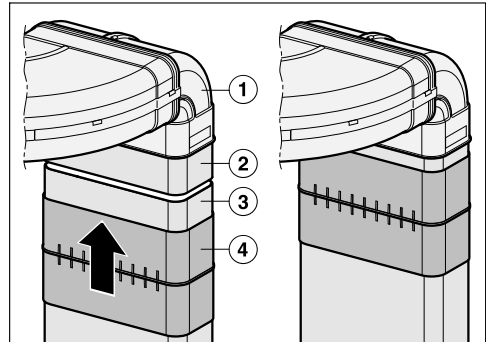

- Insert the short bend ① into the horizontal bend.
- Connect the duct piece ② to the short bend ①. Fix the connection with the sealing strip.
- Adapt the remaining duct piece ③ to the height of the base unit.
- Slide the length compensation ④ over the adapted duct piece ③. Hold the adapted duct piece ③ under the duct piece on the bend ②. Slide the length compensation ④ over the duct piece on the bend ②. Fix the connection with the sealing strip.

Installation

Length compensation – worktop depth greater than 600 mm

- Divide the flat ducting into 2 pieces. 1 piece must correspond to the difference between 600 mm and the worktop depth.

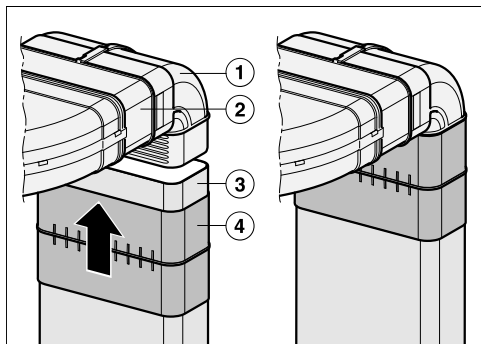

- Insert the duct piece ② into the horizontal bend.
- Connect the duct piece ② to the short bend ①. Fix the connection with the sealing strip.
- Adapt the remaining duct piece ③ to the height of the base unit.
- Slide the length compensation ④ over the adapted duct piece ③. Hold the adapted duct piece ③ under the short bend ①. Slide the length compensation ④ over the short bend ① from below. Fix the connection with the sealing strip.

Installing the fan motor

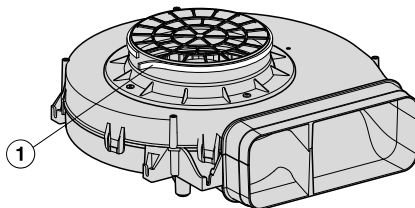

- ① Sealing strip

- Stick the sealing strip supplied to the fan connection.

E-box

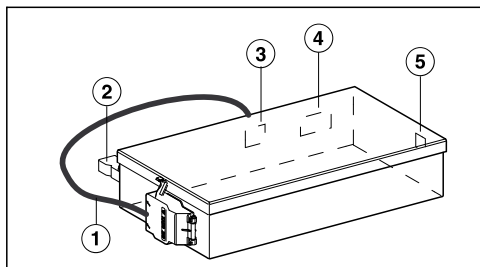

- ① Mains connection cable
- ② Connection to window contact
- ③ Connection socket for the fan power cable
- ④ Connection socket for the fan control cable
- ⑤ Connection socket for the control unit cable

Connection to window contact, if required

⚠ The window contact is connected to the mains voltage. Danger of electric shock! Disconnect the downdraft extractor from the mains electricity supply before connecting the switching system. The connection cable of the switching system must only be connected by a suitably qualified and competent electrician.

The connection cable of the switching system must be of the correct type and cross-sectional area in strict accordance with current national and local safety regulations and must not exceed 2.0 m in length. The switching system must be equipped with a potential-free contact suitable for 230 V, 1 A. The extractor is switched off when the switch is open. Only use suitable switching systems (e.g. window contact switches, pressure switches). The switching system must be suitable for use with inductive loads (BLDC motor). Use switching systems in strict accordance with current national and local safety regulations.

Installation

- Loosen the lug and pull the plug out.

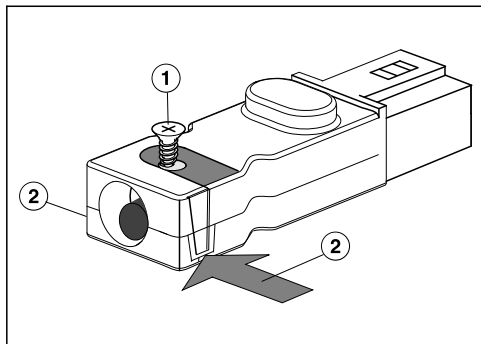

- Loosen the strain relief screw ① and unlock the casing on both sides ②.
- Open the casing.
- Remove the stopper.

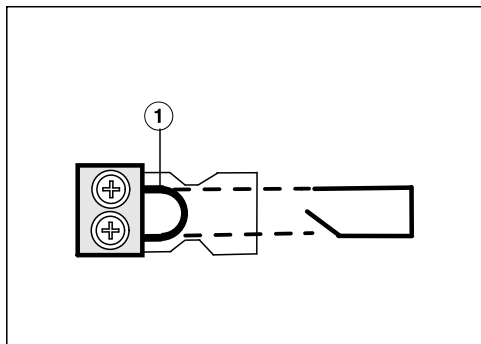

- Exchange the jumper ① with the connection cable of the switching system.
- Close the casing.
- Tighten the strain relief screw.
- Reinsert the plug.

Connecting the e-box

- Connect the fan power cable and fan control cable to the e-box and the fan.
- Connect the control unit cable to the e-box.

The socket positions are designed in such a way that they cannot be mixed up.

- Connect the downdraft extractor to the mains electricity supply.
- Check that the downdraft extractor works.

Sealing the gaps

- Seal the gaps between the individual SmartLine appliances, and between the flush-fit SmartLine appliances and the worktop, with a silicone sealant that is heat-resistant to at least 160 °C.

Unsuitable sealant can damage natural stone.

For natural stone worktops and natural stone tiles, only use silicone sealant that is specially formulated for natural stone.

Please follow the manufacturer's instructions.

Exhaust ducting

⚠ Before installation, it is important to read the following information. This is particularly crucial when using the downdraft extractor at the same time as a heating appliance that relies on oxygen from the same room, which could result in the build-up of toxic fumes.

It is particularly important that the “Warning and Safety instructions” are observed.

The downdraft extractor should be installed according to local and national building regulations. Seek approval from the building inspector where necessary.

The downdraft extractor has an exhaust connection of 222 x 89 mm.

- Only use smooth pipes or flexible ducting made from approved non-flammable materials for exhaust ducting.
- To achieve the most efficient air extraction with the lowest noise levels, please note the following:
 - The cross-section of the exhaust ducting must not be smaller than the cross-section of the exhaust connection (refer to appliance dimensions).
 - The exhaust ducting should be as short and straight as possible.
 - Only use wide radius bends.
 - The exhaust ducting must not be kinked or compressed.
 - Ensure that all connections are strong and airtight.

Remember that any constriction of the airflow will reduce extraction performance and increase operating noise.

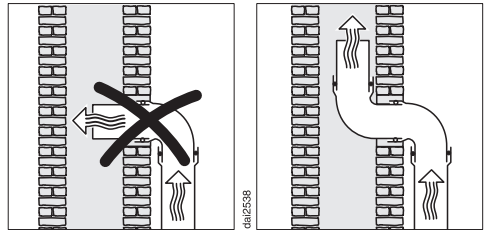

- If the exhaust air is to be ducted into a flue, the ducting must be directed in the flow direction of the flue.
- If ducting is to be laid horizontally, it must be laid with a downwards sloping gradient. This is to ensure that condensate cannot drain back into the extractor.
- If the exhaust ducting is to run through rooms, ceiling space, etc. there may be great variations in temperature between the different areas. The problem of condensation will need to be addressed. The exhaust ducting will need to be suitably insulated.

Installation

Electrical connection

The SmartLine appliance is supplied with a mains connection cable with moulded plug ready for connection to a suitable earthed socket.

The socket should be easily accessible after the SmartLine appliance has been installed. If the socket is not easily accessible, ensure that a suitable means of disconnection is provided on the installation side for each pole.



Risk of fire from overheating.
Connecting the SmartLine appliance to multi-socket adapters or extension cables can overload the cables.
For safety reasons, do not use an extension cable or multi-socket adapter.

Risk of damage from incorrect connection. Incorrect installation, maintenance and repairs can be dangerous to users.
Miele cannot be held liable for damage or injury (e.g. electric shock) caused by unauthorised installation, maintenance or repair work, or by an inadequate or faulty on-site earthing system.

All electrical work must be carried out by a suitably qualified and competent person in strict accordance with national and local safety regulations.

For safety reasons, we recommend using a suitable residual current device (RCD) in the relevant electrical installation for connecting the SmartLine appliance.

If the mains connection cable is damaged, it must only be replaced with a specific mains connection cable of the same type (available from Miele). For safety reasons, such replacement may only be carried out by a suitably qualified and competent electrician or a Miele authorised service technician, in order to avoid a hazard.

These operating instructions and the data plate indicate the nominal power consumption and the connection data. Compare this information with the data of the on-site electrical connection. If in any doubt, consult a qualified electrician.

Temporary or permanent operation with a self-sufficient or non-mains synchronous energy supply system (e.g. isolated networks, back-up systems) is possible. A requirement for the operation is that the energy supply system complies with all current local and national requirements that apply to stand-alone, solar and/or battery systems.

The protective measures provided in the domestic installation and in this Miele product must also be assured in their function and operation in isolated operation or in non-mains synchronous operation, or replaced with equivalent measures in the installation.

Miele Australia Pty. Ltd.

ACN 005 635 398

ABN 96 005 635 398

Miele Head Office Melbourne:

Level 4, 141 Camberwell Road
Hawthorn East, VIC 3123

Miele Experience Centre Doncaster:

1136/7 Doncaster Shopping Centre
619 Doncaster Rd, Doncaster, VIC 3108

Miele Experience Centre South Melbourne:

206-210 Coventry Street
South Melbourne, VIC 3205

Miele Experience Centre and Office Sydney:

3 Skyline Place
Frenchs Forest, NSW 2086

Miele Experience Centre and Office Brisbane:

Tenancy 4C, 63 Skyring Terrace
Newstead, QLD 4006

Miele Experience Centre Gold Coast:

131 Ferry Road
Southport, QLD 4215

Miele Experience Centre and Office Adelaide:

83-85 Sir Donald Bradman Drive
Hilton, SA 5033

Miele Experience Centre and Office Perth:

205-207 Stirling Highway
Claremont, WA 6010

1300 464 353 (1300 4 MIELE)

www.miele.com.au

Miele New Zealand Limited

IRD 98 463 631

**Miele Experience Centre
and Head Office Auckland:**

8 College Hill
Freemans Bay, Auckland 1011

**Miele Experience Centre
Wellington:**

183 Featherston Street
Wellington 6011

0800 464 353 (0800 4 MIELE)

www.miele.co.nz

Miele Global Headquarters**Germany****Miele & Cie. KG**

Carl-Miele-Straße 29
33332 Gütersloh
Federal Republic of Germany

CSDA 7001 FL

en-AU, NZ

M.-Nr. 11 478 760 / 02