

Cleaning and care

Cleaning the central spout

If the central spout is in the uppermost position it cannot be dismantled. The central spout must be moved into the maintenance position to do this.

- Press the ↵ control for 3 seconds.

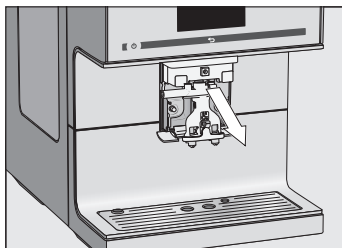

- Carefully pull the stainless steel cover off and then pull the dispensing unit off.

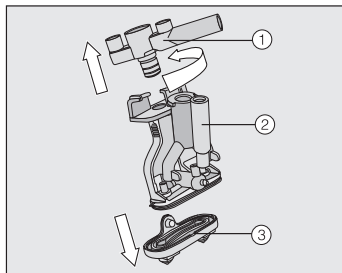

- Twist the upper section with the holder for the milk pipework ① and pull it off. Then pull the Y-shaped piece ② off. Remove the dispensing spouts ③.
- Clean all parts thoroughly. Clean the surfaces of the central spout with a damp cloth.
- Fit the dispensing unit back together.
- Push the dispensing unit back into the central spout and replace the stainless steel cover.
- Touch OK.

Degreasing the brew unit

You need 1 Miele cleaning tablet to degrease the brew unit. The process takes approx. 12 minutes.

The message Degrease the brew unit will appear in the display.

- Touch OK.

The maintenance programme will then start.

- Follow the instructions in the display.

Only clean the brew unit **by hand** with warm water. **Do not use any cleaning agents.**

- Open the appliance door.
- Release the brew unit. Press and hold the button under the brew unit handle and, whilst doing so, turn the handle to the left.

- Carefully pull the brew unit out of the coffee machine.

When you have removed the brew unit, do not change the position of the handle on the brew unit.

- Clean the brew unit **by hand** under warm running water.

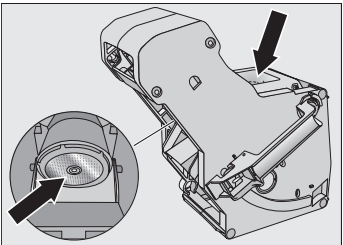

- Wipe any remaining coffee off the filters (see arrows).
- Dry the funnel in the brew unit.
- Carefully clean the inside of the coffee machine.

The following message will appear in the display: Fit the brew unit with a tablet in it.

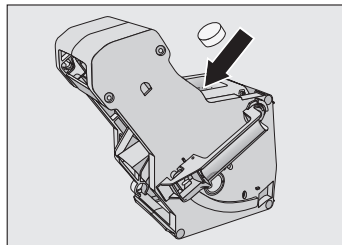

- Push the brew unit back into the coffee machine.
- Lock the brew unit. Press and hold the button under the brew unit handle and, whilst doing so, turn the handle to the right.
- Close the appliance door.
- Follow the further instructions given in the display.

The cleaning process is finished at the end of the rinsing process.

Descaling the appliance

Risk of damage from spilt descaling solution. Sensitive surfaces and/or natural floors can suffer damage. Wipe up any spillages of descaling agent immediately.

You need 1 descaling tablet for the descaling process. The process takes approx. 12 minutes.

The Descale the appliance message appears in the display.

- Touch OK.

The maintenance programme will then start.

- Follow the instructions in the display.

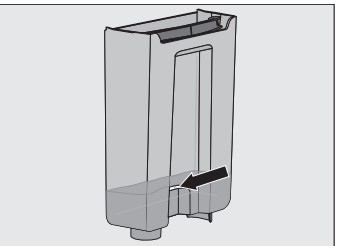

- Fill the water container to the descaling symbol ☹ with lukewarm water.
- Place 1 descaling tablet in the water.
- Push the water container back into the machine.
- Follow the further instructions given in the display.
- When Rinse the water container and fill with fresh water to the descaling symbol ☹ appears in the display:
- Remove the water container and rinse it thoroughly with clean water. Fill the water container to the descaling symbol ☹ with fresh tap water.

The descaling process is complete at the end of the rinsing process.

Tips for use

Drink parameters

You can set the quantity of coffee, the brewing temperature and pre-brewing for each drink individually.

- Select Process from the drinks menu using the > arrow sensor.
- Touch Change drink and select a drink.

- Touch Drink parameters.

- Select Quantity of coffee, Brew temperature or Pre-brewing.
- Select the setting you want and touch OK.

- Touch OK again to save your changed settings.

Portion size

You can adjust the portion size for all coffee drinks, hot water, all types of tea and drinks with milk.

- Place the cup you want under the central spout or hot water spout.
- Select Process using the > arrow sensor.

- Touch Change drink and select a drink.

- Touch Portion size.

The drink will be made and Save will appear in the display as soon as the minimum dispensing amount is reached.

- When the cup is filled to the level you want, touch Save.

If you want to change the portion size for coffee drinks made with milk or hot water, the ingredients which make up the drink will be saved one after the other while the drink is being made.

Profiles

You can set up profiles and individual drinks to cater for different tastes and preferences.

Creating a profile

- Select Profiles followed by Create profile.

- Enter the name you want (max. 8 characters) and then touch Save.

Editing a profile

When you have created at least one profile you can choose from the following options under Process:

- Change name
- Delete profile
- Change profile

Creating and editing drinks in a profile

- Touch Create drink and select a drink.

- Change the portion size or drink parameters.

- Enter a name for the new drink (maximum 8 characters) and touch Save.

When you have created at least one drink you can choose from the following options under Process drink:

- Change drink (portion size, drink parameters and name)
- Delete drink

Expert mode

In Expert mode you can change the **quantity of coffee** and the **portion size** while the drink is being made. To do this Expert mode must be switched on (Settings ► | Expert mode).

The parameters can only be changed when the respective ingredient is being processed while the drink is being made.

The setting will **not** be saved and will only apply for the current drink.

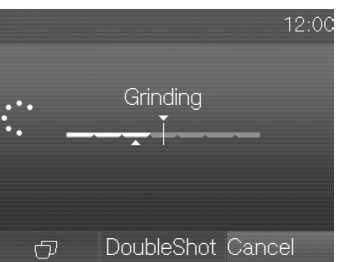

- Touch the bar and adjust the indicator (small triangle) as required.

Settings

Changing settings

- Touch the ↵ control.
- Select Settings ►.
- Select the menu option you want and change the setting as required.

- Touch OK to save the setting.

**Tip:** touching ↵ takes you back to the previous menu level.

| Menu option      | Available settings                                                                                                                         | Comments                                                                                                                                                                                                                                                                          |
|------------------|--------------------------------------------------------------------------------------------------------------------------------------------|-----------------------------------------------------------------------------------------------------------------------------------------------------------------------------------------------------------------------------------------------------------------------------------|
| Language         | German, English, other languages                                                                                                           | If you select the wrong language by mistake, you can easily find the Language option by following the flag symbol ►.                                                                                                                                                              |
| Time             | Display (On / Off / Night dimming)<br>Clock format (12 h / 24 h)                                                                           | Your choice of display will affect the energy consumption of your coffee machine.                                                                                                                                                                                                 |
| Date             |                                                                                                                                            |                                                                                                                                                                                                                                                                                   |
| Timer            | Timer 1 (Switch on at, Switch off at, Switch off after)<br>Timer 2 (Switch on at, Switch off at)<br>TeaTimer (On / Off)<br>Descaling timer | For Switch on at and Switch off at the timer must be activated and at least one day of the week must be allocated.                                                                                                                                                                |
| Expert mode      | On / Off                                                                                                                                   |                                                                                                                                                                                                                                                                                   |
| Eco mode         | On / Off                                                                                                                                   |                                                                                                                                                                                                                                                                                   |
| Lighting         | Brightness (appliance switched on or switched off)<br>Switch off after                                                                     |                                                                                                                                                                                                                                                                                   |
| Info             |                                                                                                                                            |                                                                                                                                                                                                                                                                                   |
| System lock      | On / Off                                                                                                                                   | When the system lock is activated, the Switch on at option for the timer cannot be selected.                                                                                                                                                                                      |
| Water hardness   | Soft, medium, hard, very hard                                                                                                              |                                                                                                                                                                                                                                                                                   |
| Brightness       |                                                                                                                                            |                                                                                                                                                                                                                                                                                   |
| Volume           | Buzzers<br>Keypad tones                                                                                                                    |                                                                                                                                                                                                                                                                                   |
| Cup heater       | On / Off                                                                                                                                   |                                                                                                                                                                                                                                                                                   |
| Spout adjustment | On / Off                                                                                                                                   | The height of the central spout cannot be adjusted manually.                                                                                                                                                                                                                      |
| Miele@home       | Setup                                                                                                                                      | Further functions are available if the coffee machine is connected to a WiFi network, and is signed into the Miele@mobile app (see operating instructions).                                                                                                                       |
| Service          | Evaporate<br><br>Demo mode                                                                                                                 | The Evaporate function removes water from the system and should be used if the coffee machine is not going to be used for a long period of time or has to be moved. Demo mode is intended for use in showrooms or at exhibitions. Do not activate this function for domestic use. |
| Factory defaults | Appliance settings<br>Network configuration                                                                                                | Language, Time, Date, Number of drinks and Profiles cannot be reset.                                                                                                                                                                                                              |

Miele

Quick Start Guide  
Coffee machine



These short instructions are not a substitute for the operating instructions supplied with the machine. It is essential to familiarise yourself with the coffee machine before using it for the first time. Please read the operating instructions carefully and pay particular attention to the safety notes and warnings.



Operation

Touch display

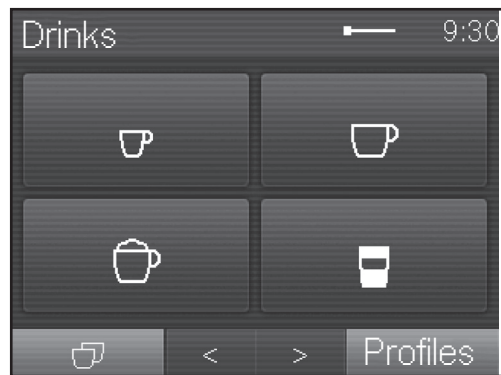

|                                     |                                                                                                                                                                                                                                  |
|-------------------------------------|----------------------------------------------------------------------------------------------------------------------------------------------------------------------------------------------------------------------------------|
| <b>Selecting / Accessing a menu</b> | ■ Touch the field you want with your finger.                                                                                                                                                                                     |
| <b>Scrolling</b>                    | ■ Touch the < or > arrows with your finger to scroll to the left or to the right.                                                                                                                                                |
| <b>Exiting a menu level</b>         | ■ Touch the ↵ control.<br>Entries made before this which have not been confirmed with OK will not be saved.                                                                                                                      |
| <b>Entering numbers</b>             | Use the numerical keypad to enter numbers.<br>■ Touch the numbers you want.<br>Once you have entered an accepted value, the OK field will light up green.<br>■ Use the ⇐ arrow to delete the last entered number.<br>■ Touch OK. |
| <b>Entering letters</b>             | Names are entered using a keyboard. It is best to select short names.<br>■ Touch the letters or characters you want.<br>■ Touch Save.                                                                                            |

Drinks overview

Coffee drinks

- **Ristretto** is a strong, concentrated espresso. It is prepared with the same amount of coffee as for an espresso but with a lot less water.
- **Espresso** is a strong aromatic coffee with a thick hazelnut brown coloured froth – known as the crema – on top.
- **Coffee** differs from espresso by the increased amount of water and the roast of the beans.
- **Long coffee** is a coffee with considerably more water.
- **Long black** is made with hot water and two shots of espresso.
- **Caffè Americano** consists of equal proportions of espresso and hot water. The espresso is made first, then the hot water is dispensed into the cup.

Coffee drinks made with milk

- **Cappuccino** consists of approx. 2/3 milk froth and 1/3 espresso.
- **Latte macchiato** consists of 1/3 each of hot milk, milk froth and espresso.
- **Caffè latte** consists of coffee and hot milk.
- **Cappuccino italiano** has the same proportions of milk froth and espresso as a cappuccino. However the espresso is added first and then the milk froth.
- **Espresso macchiato** is an espresso with a small amount of milk froth on top.
- **Flat white** is a large cappuccino: lots of espresso with plenty of milk froth.
- **Café au lait** is an espresso with some hot milk.

Tea

(hot water at the optimum temperature)

- Green tea
- Herbal tea
- Fruit tea
- Black tea

Other drinks

- Hot milk
- Milk froth
- Hot water

Coffee pot function

(3 to 8 cups can be selected)

Description

- ① On/Off button
- ② Back button
- ③ Touch display
- ④ Cup heater
- ⑤ Water container
- ⑥ Bean container
- ⑦ Park position for milk pipework
- ⑧ Grinder setting
- ⑨ Ground coffee drawer with integrated coffee scoop
- ⑩ Brew unit
- ⑪ Height-adjustable central spout with lighting and hot water spout
- ⑫ Drip tray with lid and waste container
- ⑬ Lower panel with drip tray cover

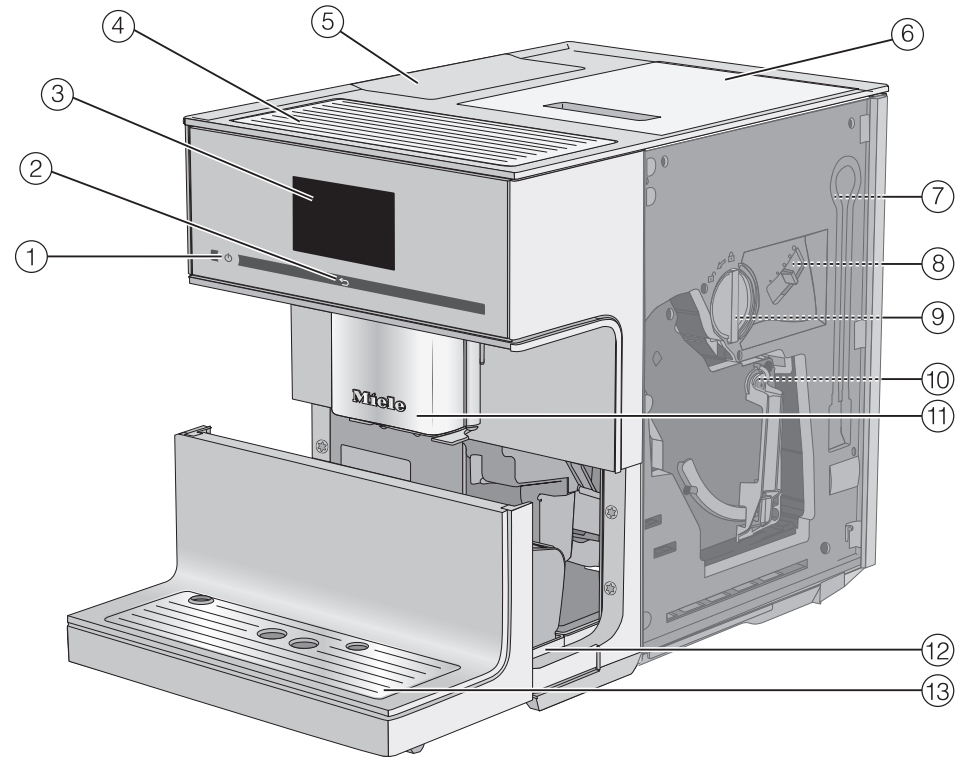

- ⑭ Cover
- ⑮ Descaling cartridge holder
- ⑯ Adapter
- ⑰ Miele descaling cartridge
- ⑱ Milk flask
- ⑲ Milk siphon
- ⑳ Milk pipework

See “Automatic descaling” in the operating instructions for information about descaling the machine.

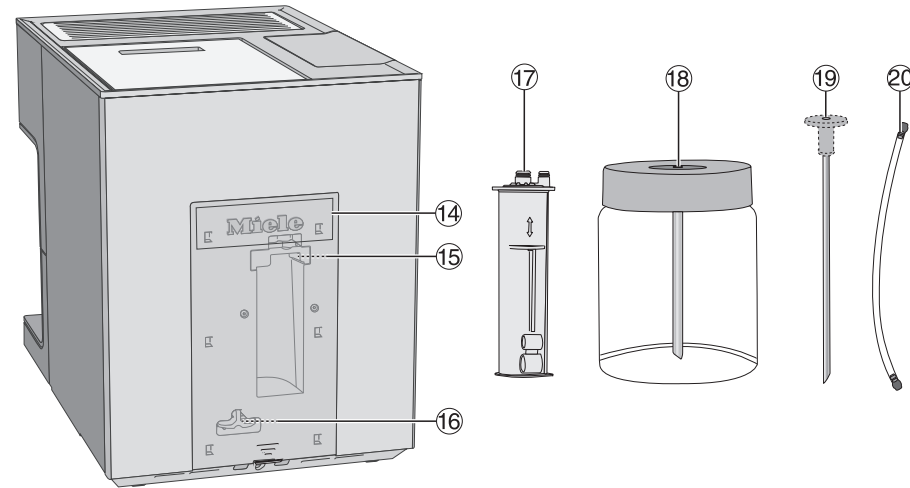

Preparing for use

Filling the water container

Change the water in the water container every day.

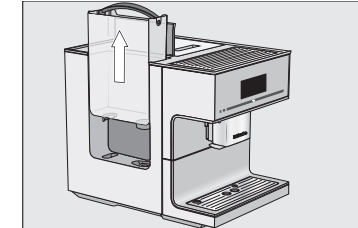

- Pour fresh, cold tap water up to the “max.” mark in the water container.

Filling the bean container

Only put roasted coffee beans in the bean container.

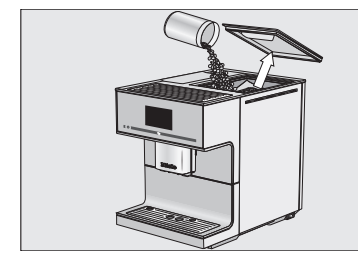

- Fill the bean container with roasted coffee beans.

GUIDE TO THE MACHINE / PREPARING FOR USE

Making drinks

Making a drink

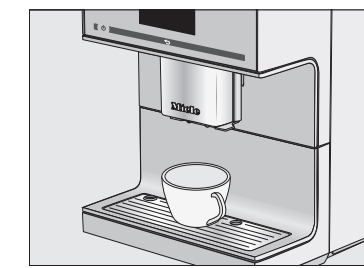

- Place a cup under the central spout.
- Select a drink.  
Drinks menu symbols:
  - ☐ Espresso
  - ☐ Coffee
  - ☐ Cappuccino
  - ☐ Latte macchiato

Cancelling a drink

- Touch Stop or Cancel.

DoubleShot

Select the DoubleShot function if you would like a particularly strong and aromatic coffee. In this case, more coffee beans will be ground and brewed halfway through the brewing process.

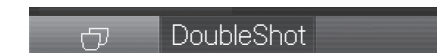

- Touch DoubleShot whilst making your coffee.

Making two portions

To fill two cups at the same time:



- Place a cup under each of the coffee dispensers in the central spout.
- Touch ☐.
- Select a drink.

Milk preparation

For high-quality milk froth, always use cold milk (< 10 °C).

There is one connecting piece included in the scope of delivery which can be inserted either into the milk siphon or into the milk flask lid.

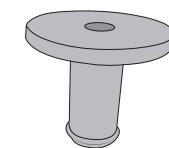

**Tip:** the milk pipework is easier to fit with the central spout in the maintenance position.

- Press the ↵ control for 3 seconds.

Preparing the milk siphon

The milk siphon enables you to prepare milk directly from milk cartons or other suitable containers.

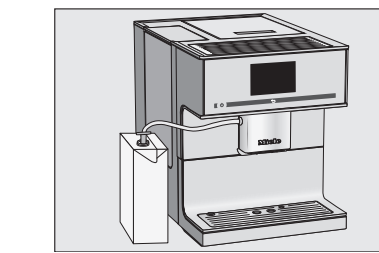

- Dip the milk siphon into the milk. Place the milk carton next to the coffee machine.
- Connect the central spout and milk siphon with the milk pipework.

Using the milk flask

- Fill the milk flask with milk up to a maximum of 2 cm below the rim.

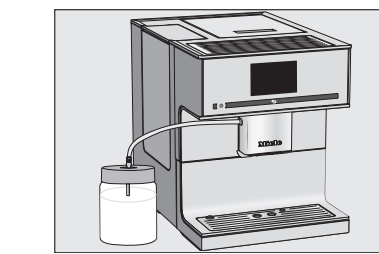

- Place the milk flask next to the coffee machine and connect the central spout and milk flask with the milk pipework.

Making tea

Hot water is heated to the optimum temperature for **green tea, herbal tea, fruit tea and black tea**.

- Place the tea filter or the tea bag in the tea cup.

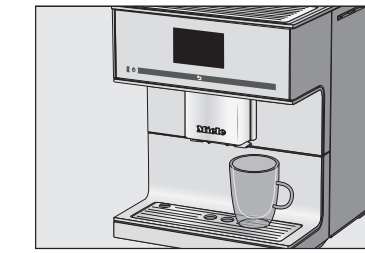

- Place the cup under the hot water spout.
- Select the type of tea from the display.  
Hot water will be dispensed into the cup.
- Remove the tea filter or tea bag when the desired brewing time has elapsed.

**Tip:** the TeaTimer is a minute minder for the brewing time.



Touch TeaTimer and select the brewing time. Confirm with OK. (The TeaTimer has to be activated under Settings | Timer | TeaTimer.)

Cleaning and care

Please observe the detailed information on cleaning and care in the operating instructions. Clean the coffee machine every day after use.

| Recommended cleaning interval                        | What do I have to clean / maintain?                                                                                                                                                             |
|------------------------------------------------------|-------------------------------------------------------------------------------------------------------------------------------------------------------------------------------------------------|
| <b>Every day</b><br>(at the end of the day)          | <ul style="list-style-type: none"><li>– Water container</li><li>– Milk flask / milk siphon</li><li>– Waste container</li><li>– Drip tray and drip tray cover</li><li>– Cup rim sensor</li></ul> |
| <b>Once a week</b><br>(more often if heavily soiled) | <ul style="list-style-type: none"><li>– Central spout</li><li>– Brew unit</li><li>– Area underneath the brew unit and the drip tray</li><li>– Casing</li></ul>                                  |
| <b>Once a month</b>                                  | <ul style="list-style-type: none"><li>– Bean container</li><li>– Ground coffee chute and ground coffee drawer</li><li>– Water container filter (or as required)</li></ul>                       |
| When prompted                                        | <ul style="list-style-type: none"><li>– Milk pipework</li><li>– Degrease the brew unit (using cleaning tablets)</li><li>– Descale the appliance (using descaling tablets)</li></ul>             |

Cleaning by hand or in the dishwasher

Clean the following by hand only:

- Stainless steel cover of the central spout
- Cup rim sensor
- Brew unit
- Bean container lid
- Lower panel

The following parts are dishwasher-safe:

- Drip tray and lid
- Drip tray cover
- Waste container
- Water container
- Central spout (without stainless steel cover)
- Ground coffee drawer
- Milk flask / milk siphon