

Cleaning and care

Cleaning the central spout

Clean the central spout stainless steel cover **by hand** only.

- Open the appliance door.

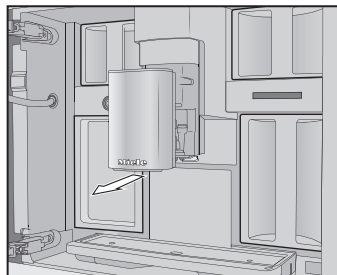

- Remove the central spout stainless steel cover and clean it.

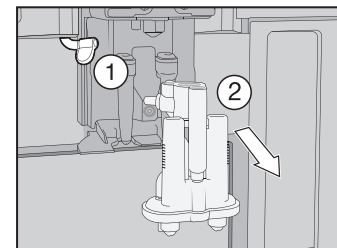

- Detach the milk pipework from the dispensing unit ①. Pull the dispensing unit down to remove it ②.

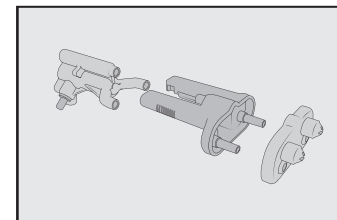

- Disassemble the dispensing unit into 3 parts.
- Clean all parts thoroughly. Clean the surfaces of the central spout with a damp cloth.
- Reassemble the dispensing unit.

- Push the dispensing unit back into the central spout and replace the stainless steel cover.
- Confirm the message with **OK**.

Removing the brew unit and cleaning by hand

Clean the brew unit **by hand** only under warm running water. **Do not use washing-up liquid or any other cleaning agent.**

- Open the appliance door and remove the water container.

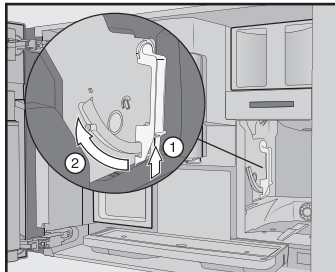

- Press the button under the handle of the brew unit ① and, whilst doing so, turn the handle forwards ②.

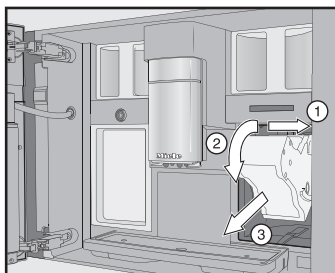

- Pull the brew unit sideways ① and tilt it forwards ②. Pull the brew unit forwards to remove it ③.

When you have removed the brew unit, do not change the position of the handle on the brew unit.

- Clean the brew unit **by hand** under warm running water.

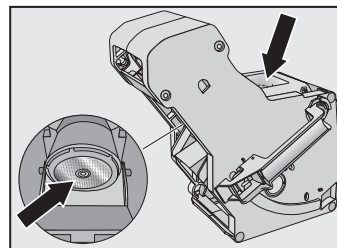

- Wipe any remaining coffee off the filters (see arrows).
- Dry the funnel in the brew unit.
- Carefully clean the inside of the coffee machine.
- Push the brew unit back into the coffee machine.
- Lock the brew unit. Press and hold the button under the brew unit handle and, whilst doing so, turn the handle to the right.
- Close the appliance door.
- Follow the further instructions given in the display.

The process is complete when rinsing has finished.

Descaling the appliance

You will need **2** descaling tablets for the descaling programme.

The message **Descal** the appliance appears in the display.

- Touch **OK**.
- Follow the instructions in the display.

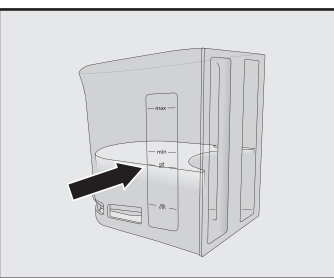

- Fill the water container to the S symbol with lukewarm water.
- Drop **2** descaling tablets in the water.
- Push the water container back into the machine.
- Follow the further instructions given in the display.

When Rinse the water container and fill it to the S symbol with fresh tap water appears in the display:

- Remove the water container and rinse it thoroughly with clean water. Fill the water container to the S symbol with fresh tap water.

The descaling process is complete at the end of the rinsing process.

Coffee the way you like it

Bean system

You can change the names for the types of coffee bean and/or reallocate the types of bean under Settings ☰ | Type of beans.

If you do not allocate a type of bean, you will be asked what type of bean you want to use for the coffee as you make it.

Renaming type of beans

The three bean containers are shown in the display as follows and are pre-named.

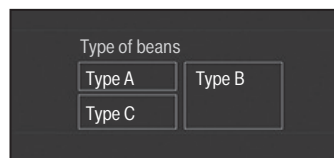

If you are using the same type of beans in two or three bean containers at the same time (for instance, because you only use one type of bean), make sure you name them in the same way exactly.

- Select **Change name**.
- Enter the name you want and then touch **Save**.

Allocating bean types

- Select **Change allocation**.

If you have set up at least one profile and at least one coffee drink, first select the profile.

- Change the allocation as required and then confirm with **OK**.

Tip: If you tap **All drinks**, you will highlight all coffee drinks and you can deselect the ones you do not want.

Drink parameters

You can set the amount of coffee, the brewing temperature and pre-brewing for each coffee drink individually.

- Touch the drink entry and keep your finger on it until the context menu opens.

- Touch **Drink parameters**.

- Select **Amount of coffee**, **Brew temperature**, **Pre-brewing** or **Type of beans**.

- Select the desired setting and touch **OK**.
- Touch **OK** again to save your changed settings.

Portion size

You can adjust the amount of water for all coffee drinks, hot and warm water and all types of tea and the amount of milk for drinks with milk.

- Place a cup or glass under the central spout.
- Touch the drink entry and keep your finger on it until the context menu opens.
- Touch **Portion size**.

The drink will be made and **Save** will appear in the display as soon as the minimum dispensing amount is reached.

- When the cup is filled up to the desired level, touch **Save**.

If you want to change the portion size for coffee drinks made with milk or hot water, the ingredients (components) which make up the drink will be saved one after the other while the drink is being made.

Performance mode

You can select the appropriate mode to suit your personal preferences under Settings ☰ | Performance mode. The energy consumption varies depending on the selected mode.

- **Eco mode:** This is an energy-saving mode.

- **Barista mode:** This mode is optimised for espresso and coffee drinks.

- **Latte mode:** In this mode, drinks with milk can be prepared significantly faster.

In addition, you can activate **Party mode** for the occasional intensive use of the coffee machine, e.g. for family get-togethers (see the operating instructions).

User profiles

In addition to the Miele drinks menu (Miele profile), you can create individual profiles to cater for different tastes and preferences.

Creating a profile

- Select **Profiles** followed by **Create profile**. The editor will open in the display.

- Enter the name you want and then touch **Save**.

The profile is created. You can now prepare drinks.

Editing a profile

When you have created at least one profile, you can rename, delete or move profiles via the context menu.

Setting change of profile

You can select from the following options:

- **Manual:** The selected profile remains active until you select another profile.

- **After each use:** The Miele profile is displayed after every drink.

Creating and processing drinks in a profile

You can create new drinks based on existing drinks. A maximum of 9 drinks can be saved under one profile.

- Start by opening the required profile: touch **Profiles** and select the profile.

- Touch **Create drink** and select a drink.

- Change the portion size or drink parameters.

Drink preparation will begin and you can save the portions of each component as desired.

- Enter a name for the new drink and touch **Save**.

If you have already created drinks, you can edit these entries in the context menu.

Settings

You can personalise your coffee machine by adapting the factory default settings to your requirements.

Factory default settings are marked in *italics*.

Language ☑

- German | ... other languages
- Country

Time of day

- Display: On | Off | Night dimming
- Clock display: Analogue | Digital
- Clock format: 24 h | 12 h (am/pm)
- Set

Tip: If you touch the time of day on the top right of the display, you can set the time directly.

Date

The date appears if the Time | Clock type | Digital setting is selected.

Start screen

- Main menu | *Drinks* | Profiles | MyMiele

You can select the menu that is displayed when the coffee machine is switched on.

Timer

- Appliance timer: Switch on at | Switch off at | *Switch off after (0:20)*
- TeaTimer: Automatic | *Manual*
- Maintenance timer

Volume

- Signal tones
- Keypad tones

Display

- Display brightness
- Colour scheme: bright | *dark*
- QuickTouch: On | Off

Lighting

You can use the ☼ sensor control to switch the lighting on or off at any time as long as the coffee machine is switched on.

If the coffee machine is switched off, you can switch the lighting on or off at any time if you select the following settings:

- Time | Display | On or Night dimming (time of day is displayed)
- Display | QuickTouch | On

Info

- Number of drinks (Total No. of drinks | Total coffees | ...)
- No. of uses until maintenance programme: Descal the appliance | Degrease the brew unit
- Fill levels (of cartridges)

Mains water (CVA 7845)

- On | Off

Altitude

0–250 m, 251–500 m, ...

Performance mode

- *Eco mode* | Barista mode | Latte mode | Party mode

Party mode is a Performance mode for the occasional intensive use of the coffee machine (see the operating instructions).

Water hardness

Set to 21 °dH at the factory.

Automatic cleaning

- On | Off

Type of beans

- Type A, B and C: Change name | Change allocation

Proximity sensor

- Switch on the light: Appliance switched on (On | Off) | Appliance switched off (On | Off)
- Switch on the appliance: On | Off
- Acknowledge signal tones: On | Off

System lock 🔒

- On | Off

When the system lock is activated, the **Switch on at** option for the timer and the proximity sensor cannot be selected.

Miele@home

- Set up | Deactivate/Activate | Connection status | New setup
- Remote control (On | Off)
- SuperVision: SuperVision display (On | Off), display in Standby mode (On | Off), appliance list
- RemoteUpdate (On | Off)

Some menu options only appear if Miele@home has been set up and the coffee machine is connected to a Wi-Fi network.

Software version

For service technicians.

Legal information

- Open source licences

Showroom programme

- Demo mode: On | Off

Factory default settings

- Appliance settings

Language, Time, Date, Number of drinks, Miele@home settings, Profiles and the corresponding drinks cannot be reset.

The Maintenance timer is reset to 2:00 am.

- MyMiele

Quick Start Guide Coffee machine



These short instructions are **not** a substitute for the operating instructions supplied with the machine. It is essential to familiarise yourself with the coffee machine before using it for the first time. Please read the operating instruction manual carefully and pay particular attention to the Warning and Safety instructions.

Operation

Touch display

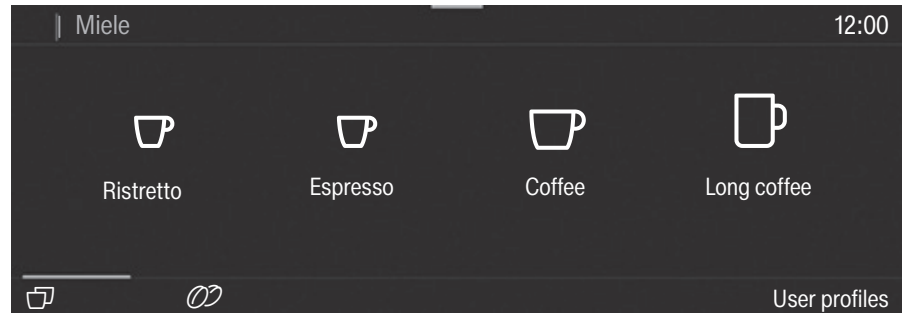

Selecting / Calling up a menu	■ Touch the desired entry or value in the display.
Scrolling	■ Swipe across the screen. To do this, place your finger on the touch display and swipe it in the direction you want.
Exiting a menu level	■ Touch \leftarrow . Alternatively, you can touch the upper level menu name in the menu path. Entries made before this which have not been confirmed with OK will not be saved.
Entering numbers	<p>You can enter numbers using the number roller or the numerical keypad.</p> <p>Number roller:</p> <ul style="list-style-type: none">■ Swipe the roller up or down until the number you want is located in the centre and coloured orange. Confirm with OK. <p>Numerical keypad:</p> <ul style="list-style-type: none">■ Touch the orange coloured value in the centre and keep your finger on it until the numerical keypad appears.■ Select the desired value: as soon as a valid value has been entered, OK is highlighted green. Use the \leftarrow arrow to delete the last entered number.■ Confirm with OK.
Entering letters	<p>Names are entered using a keyboard. It is best to select short, concise names.</p> <ul style="list-style-type: none">■ Touch the required letters or characters.■ Touch Save.
Displaying the context menu	<p>In some menus you can display a context menu, e.g. to configure drinks.</p> <ul style="list-style-type: none">■ Touch and keep your finger on a drink name, for example, until the context menu opens.■ To close the context menu, touch an area of the display located outside of the menu window.
Help display	<ul style="list-style-type: none">■ Context-sensitive help is available for certain functions. The display shows Help.■ Touch Help to display information in text and pictures.

Drinks overview

Coffee drinks

- **Ristretto** is a strong, concentrated espresso. It is prepared with the same amount of coffee as for an espresso but with a lot less water.
- **Espresso** is a strong aromatic coffee with a thick hazelnut brown coloured froth - known as the crema - on top.
- **Coffee** differs from espresso by the increased amount of water and the roast of the beans.
- **Long coffee** is a coffee with considerably more water.
- **Long black** is made with hot water and two shots of espresso.
- **Caffè Americano** consists of equal proportions of espresso and hot water. The espresso is made first, then the hot water is dispensed.

Coffee drinks made with milk

- **Cappuccino** consists of approx. 2/3 milk froth and 1/3 espresso.
- **Latte macchiato** consists of 1/3 each of hot milk, milk froth and espresso.
- **Caffè latte** consists of hot milk and espresso.
- **Cappuccino Italiano** has the same proportions of milk froth and espresso as a cappuccino. The difference is that the espresso is added first and then the milk froth.
- **Espresso macchiato** is an espresso with a small amount of milk froth on top.

- **Flat white** is a special variation of the cappuccino: a much greater amount of espresso compared to milk froth creates an intensive coffee aroma.
- **Café au lait** is a French coffee speciality made from coffee and milk froth. Café au lait is normally served in a bowl.

Tea drinks

- (hot water at the optimum temperature)
- White tea
 - Japanese tea
 - Green tea
 - Herbal tea
 - Fruit tea
 - Black tea
 - **Chai Latte** is a tea speciality with milk.

Other drinks

- Hot milk
- Milk froth
- Hot water
- Warm water

Pot function

- Coffee pot (3 to 8 cups can be selected)
- Teapot for all types of tea

Description

Exterior view

- ① On/Off ① sensor
- ② Optical interface (for Miele service technicians only)
- ③ MobileStart ③ sensor control
- ④ Proximity sensor
- ⑤ "Back" \leftarrow sensor
- ⑥ Touch display
- ⑦ \odot Sensor
- ⑧ Door handle
- ⑨ Automatic height-adjustable central spout with lighting
- ⑩ Drip tray cover
- ⑪ Milk flask

Interior view

- ① Bean container (type A and type C)
- ② Milk valve
- ③ Automatic height-adjustable central spout with lighting
- ④ Grinder setting
- ⑤ Bean container (type B)
- ⑥ Fan outlet
- ⑦ Water container
- ⑧ Drip tray with lid
- ⑨ Brew unit
- ⑩ Waste container
- ⑪ Maintenance container
- ⑫ Holders for cleaning and descaling cartridges (including plug)
- ⑬ Drip catcher

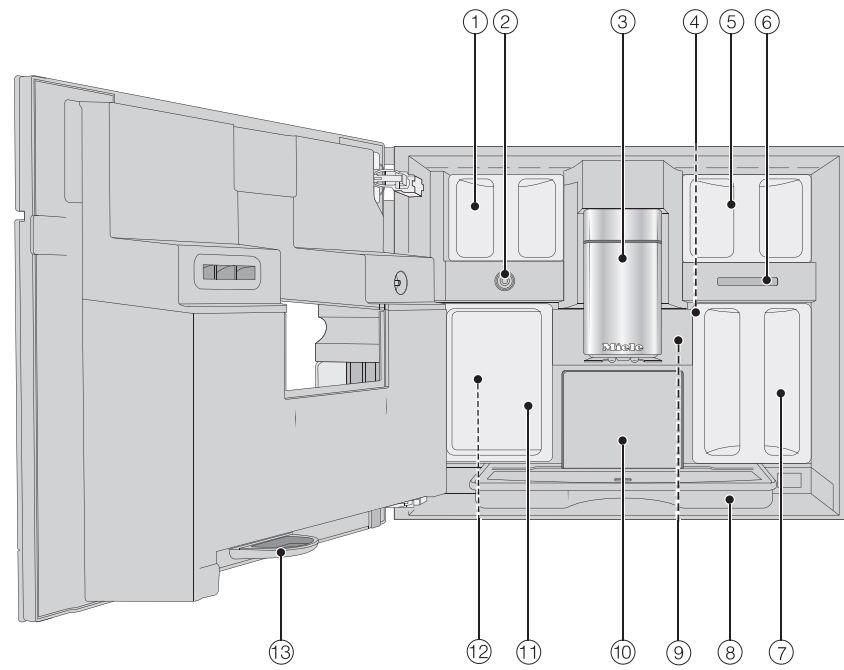
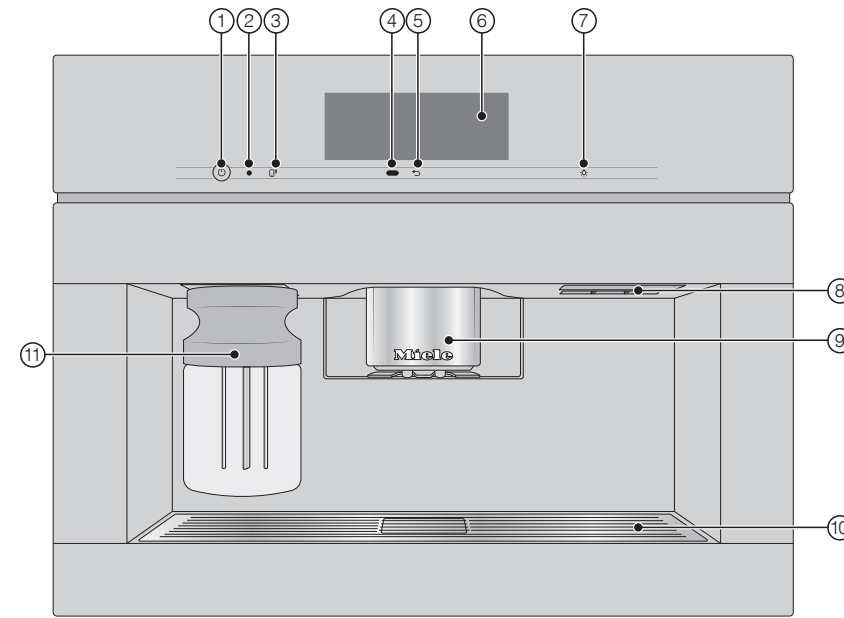

Preparing for use

Filling the water container

- Open the appliance door.

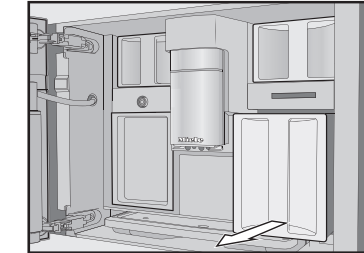

- Pull the water container out to remove it.
- Fill the water container with cold, fresh tap water up to the "max." mark.
- Push the water container back into the coffee machine and close the appliance door.

Filling the bean containers

Only put roasted coffee beans in the bean containers.

- Open the appliance door.

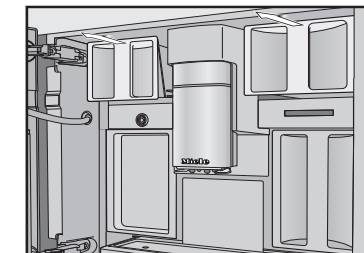

- Pull out the coffee bean containers and remove their lids.
- Fill the bean containers with coffee beans and put the lids back on the bean containers to seal them.
- Push the coffee bean containers back into the coffee machine.
- Close the appliance door.

Making drinks

Making a drink

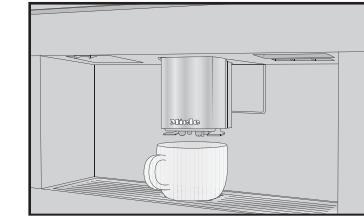

- Place a cup or glass under the central spout.
- Select a drink.

Cancelling preparation

- Touch **Stop** or **Cancel**.

DoubleShot

Select the DoubleShot \odot function if you would like a particularly strong and aromatic coffee. In this case, more coffee beans will be ground and brewed halfway through brewing.

- Touch \odot whilst making your coffee.

Making two portions

To fill two cups at the same time:

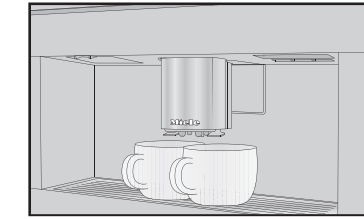

- Place one cup under each of the coffee spouts.
- Touch \odot .
- Select a drink.

Using the milk flask

Milk is not cooled in the milk flask. Therefore, place the milk flask in the refrigerator if you are not going to use milk for a while. Good milk froth can only be made with cold milk (< 10 °C).

- Fill the milk flask with milk up to a maximum of 2 cm below the rim.

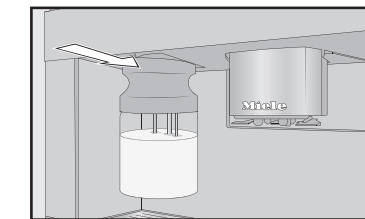

- Push the milk flask into the coffee machine until it clicks into place.
- You can now make drinks with milk.

Making tea

Hot water is heated to the optimum temperature for different types of tea.

- Place the tea filter or the tea bag in the tea cup.
- Place the tea cup under the central spout.
- Select the type of tea you want from the display.

Hot water will be dispensed into the cup.

- Remove the tea filter or tea bag when the desired brewing time has elapsed.

Tip: You can use the **TeaTimer** function to start a minute minder when making tea (see the operating instructions).

Pot function

You can make several cups of coffee or tea one after the other automatically with the Pot function (maximum of 1 litre). Up to 8 cups can be made in this way.

Preparing the pot

The drinks menu is displayed.

- Place a sufficiently large container under the central spout.
- Select the required pot function.
- Select the number of portions you want to dispense (3 to 8).
- Follow the instructions in the display.

Expert mode

In Expert mode you can allocate a type of bean for one time and change the portion size while the drink is being made. Expert mode must be activated for this (in the pull-down menu: the word **Expert mode** is highlighted in orange).

The setting will **not** be saved and will only apply for the current drink.

Allocating bean containers temporarily

- Touch the top edge of the screen and open the pull-down menu.
- Now select the bean container whose beans are to be used for the current drink.
- Slide the menu window back up to close it.
- Now start making the drink.

Changing the portion size

The portion size can only be changed when the respective ingredient is being processed while the drink is being made.

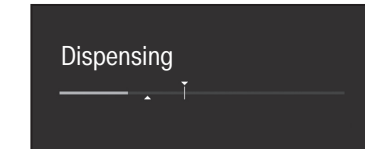

- Touch the segment bar and adjust the indicator (small triangle) as you wish.

Cleaning and care

Please observe the detailed information on cleaning and care in the operating instructions. Carefully clean the coffee machine regularly.

Recommended cleaning interval	What do I have to clean / maintain?
Every day (at the end of the day)	<ul style="list-style-type: none">– Milk flask and lid– Milk valve– Water container– Drip tray cover– Drip tray and waste container
Once a week (more often if heavily soiled)	<ul style="list-style-type: none">– Central spout– Cup rim sensor– Interior– Brew unit– Drip catcher– Appliance front
Once a month	<ul style="list-style-type: none">– Bean containers
As required / When prompted by display	<ul style="list-style-type: none">– Milk pipework– Degrease the brew unit– Descale the appliance

Clean by hand or in the dishwasher

Clean the following by hand only:

- Central spout stainless steel cover
- Brew unit
- Coffee bean containers and lids

The following parts are dishwasher safe:

- Drip tray with lid and waste container
- Drip tray cover
- Central spout (without stainless steel cover)
- Milk flask and lid
- Cup rim sensor
- Drip catcher
- Maintenance container
- Water container